



US Army Corps
of Engineers
Alaska District

Public Notice of Application for Permit

ANCHORAGE
Regulatory Division (1145)
CEPOA-RD
Post Office Box 6898
JBER, Alaska 99506-0898

PUBLIC NOTICE DATE:	Mar 28, 2024
EXPIRATION DATE:	Apr 27, 2024
REFERENCE NUMBER:	POA-2020-00063
WATERWAY:	Klawock Inlet

Interested parties are hereby notified that a Department of the Army permit application has been received for work in waters of the United States as described below and shown on the enclosed project drawings.

All comments regarding this public notice should be sent to the address noted above. If you desire to submit your comments by email, you should send it to the project manager's email as listed below or to regpagemaster@usace.army.mil. All comments should include the public notice reference number listed above.

All comments should reach this office no later than the expiration date of this public notice to become part of the record and be considered in the decision. Please contact Olivia Ortiz at (907) 753-2586, toll free from within Alaska at (800) 478-2712, or by email at Olivia.K.Ortiz@usace.army.mil if further information is desired concerning this public notice.

APPLICANT: Edward Douville
Shaan-Seet Inc
501 Main Street
Craig, AK 99921
eddouville@shaanseet.com
Business: (907) 826-3251

AGENT: Trevor Sande; Ian Owens
R&M Engineering- Ketchikan, Inc
7180 Revilla Road, Suite 300
Ketchikan, AK 99901
trevorsande@rmketchikan.com; ian@rmketchikan.com

Business: (907) 225-7917

LOCATION: The project site is located within Section 5, T. 74 S., R. 81 E., Copper River Meridian; Latitude 55.4782° N., Longitude 133.1481° W.; in Craig, Alaska.

PURPOSE: The applicant's stated purpose is to replace the existing pier and floats that have exceeded their useful lives. The new project would have a ramp that is wide enough for vehicles to drive down to the new float, allowing for better commercial access for large operations, charter boats, fish processing, and other water dependent marine uses.

PROPOSED WORK: The project would consist of removing 168 linear feet of wood pier, 800 square feet of wood float, and removing 33 existing creosote pilings. The new project would include the placement of 6,949.4 cubic yards of rock fill into 17,900 square feet below the high tide line, placement of six (6) new 18-inch diameter galvanized steel pilings, and placement of 2,400 square feet of wooden float. The project would include a 12-foot by 100-foot concrete breakwater held in place by three (3) 18-inch diameter galvanized steel pilings. A crane and spud barge measuring 140 feet by 40 feet would be used to hold an ICE 216B vibratory hammer, which has a maximum vibrations per minute (VPM) of 1750 and 50 tons of driving force. If the vibratory hammer cannot achieve embedment, an ICEI-19 impact hammer with 200 tons of driving force would be used. A boom boat or a mini tug and a work skiff would be transported on the crane and spud barge. A material barge transporting from Ketchikan to Craig may also be utilized.

The facility is designed to host the local charter fishing fleet, which has vessels ranging from 28 feet to 36 feet. There are a few slips that have been designed for the smaller skiffs owned by the local residents of Craig. In total, the agent anticipates ten (10) vessels ranging in size from 26 feet to 40 feet and eight (8) vessels ranging from 16 feet to 24 feet.

All work would be performed in accordance with the enclosed plan (sheets 1-6), dated February 28, 2024.

ADDITIONAL INFORMATION: The agent has contacted the City of Craig and the Alaska Department of Fish and Game to inquire about other potential permit requirements.

APPLICANT PROPOSED MITIGATION: The applicant proposes the following mitigation measures to avoid, minimize, and compensate for impacts to waters of the United States from activities involving discharges of dredged or fill material.

a. Avoidance: The project includes the removal and replacement of an existing marine facility, so avoidance is not practicable.

b. Minimization: The applicant states a minimum amount of fill would be used to limit the impact of construction on affected waters.

c. Compensatory Mitigation: The applicant states that no compensatory mitigation is proposed for this project.

WATER QUALITY CERTIFICATION: A permit for the described work will not be issued until a certification or waiver of certification, as required under Section 401 of the Clean Water Act (Public Law 95-217), has been received from the Alaska Department of Environmental Conservation. A pre-filing meeting request was submitted with the Alaska Department of Environmental Conservation on December 9, 2023. A CWA 401 certification request was submitted with ADEC on March 20, 2024.

CULTURAL RESOURCES: The latest published version of the Alaska Heritage Resources Survey (AHRS) has been consulted for the presence or absence of historic properties, including those listed in or eligible for inclusion in the National Register of Historic Places. There are no cultural resources in the permit area or within the vicinity of the permit area. The permit area has been determined to be the boundary around the existing float, ramp, and pier, and the boundary around the proposed fill. Consultation of the AHRS constitutes the extent of cultural resource investigations by the U.S. Army Corps of Engineers (Corps) at this time, and we are otherwise unaware of the presence of such resources. The Corps has made a No Historic Properties Affected (No Effect) determination for the proposed project. This application is being coordinated with the State Historic Preservation Office (SHPO), Federally recognized Tribes, and other consulting parties. Any comments SHPO, Federally recognized Tribes, and other consulting parties may have concerning presently unknown archeological or historic data that may be lost or destroyed by work under the requested permit will be considered in our final assessment of the described work. The Corps is requesting the SHPO's concurrence with this determination.

ENDANGERED SPECIES: The project area is within the known or historic range of the Mexico Distinct Population Segment (DPS) humpback whale (*Megaptera novaeangliae*), and the proposed sunflower sea star (*Pycnopodia helianthoides*).

We have determined the described activity may affect the Mexico DPS humpback whale (*Megaptera novaeangliae*) and the proposed sunflower sea star (*Pycnopodia helianthoides*). We will initiate the appropriate consultation procedures under section 7 of the Endangered Species Act with the U.S. Fish and Wildlife Service or the National Marine Fisheries Service (NMFS). Any comments they may have concerning endangered or threatened wildlife or plants or their critical habitat will be considered in our final assessment of the described work.

ESSENTIAL FISH HABITAT: The Magnuson-Stevens Fishery Conservation and Management Act (Magnuson-Stevens Act), as amended by the Sustainable Fisheries Act of 1996, requires all Federal agencies to consult with the NMFS on all actions, or proposed actions, permitted, funded, or undertaken by the agency, that may adversely affect Essential Fish Habitat (EFH).

The project area is within mapped EFH for pink salmon (*Oncorhynchus gorbuscha*), Chinook salmon (*Oncorhynchus tshawytscha*), sockeye salmon (*Oncorhynchus nerka*), chum salmon (*Oncorhynchus keta*), and coho salmon (*Oncorhynchus kisutch*).

We have determined the described activity may adversely affect EFH in the project area for the species listed above.

Pile driving may affect prey species by generating intense underwater sound pressure waves. The sound waves impact bottom-living fish and invertebrates, as well as fish with swim bladders more than those in the water column and without gas-filled cavities. Pile driving noise can disrupt fish schooling behavior and their ability to coordinate movements with each other (Limpinsel et al. 2023).

Pile removal may affect EFH with the following impacts: sediment suspension, possible pollutant reintegration into the water column, underwater sound, and continual benefits. Since the pilings to be removed are old creosote pilings, the removal of these pilings may provide long term benefits to EFH since chemicals from the piles can leach out and introduce toxins into the water column if the pilings continue to exist (Limpinsel et al. 2023).

The placement of fill has the following impacts: reduces the production of detritus, an important food source for aquatic invertebrate (e.g., shredders); alters the uptake and release of nutrients to and from adjacent aquatic and terrestrial systems; reduces wetland vegetation, an important source of food for fish and invertebrates; hinders physiological processes in aquatic organisms (e.g., photosynthesis, respiration) because of degraded water quality and increased turbidity and sedimentation; alters hydrological dynamics, including flood control and groundwater recharge; reduces filtration and absorption of pollutants from uplands; and alters nitrogen and oxygen cycles (Limpinsel et al. 2023).

This public notice initiates EFH consultation with the NMFS. Any comments or recommendations they may have concerning EFH will be considered in our final assessment of the described work.

TRIBAL CONSULTATION: The Corps fully supports tribal self-governance and government-to-government relations between Federally recognized Tribes and the Federal government. Tribes with protected rights or resources that could be significantly affected by a proposed Federal action (e.g., a permit decision) have the right to consult with the Corps, Alaska District, on a government-to-government basis. Views of each Tribe regarding protected rights and resources will be accorded due consideration in this process. This public notice serves as notification to the Tribes within the area potentially affected by the proposed work and invites their participation in the Federal decision-making process regarding the protected Tribal rights or resources. Consultation may be initiated by the affected Tribe upon written request to the District Commander. This application is being coordinated with federally recognized tribes and other consulting parties. Any comments federal recognized tribes and other consulting parties may have concerning presently unknown archeological or historic data that may be lost or destroyed by the work under the requested permit will be considered in the Corps final assessment of the described work.

PUBLIC HEARING: Any person may request, in writing, within the comment period specified in this notice, that a public hearing be held to consider this application. Requests for public hearings shall state, with particularity, reasons for holding a public hearing.

EVALUATION: The decision whether to issue a permit will be based on an evaluation of the probable impacts, including cumulative impacts of the proposed activity and its intended use on the public interest. Evaluation of the probable impacts, which the proposed activity may have on the public interest, requires a careful weighing of all the factors that become relevant in each particular case. The benefits, which reasonably may be expected to accrue from the proposal, must be balanced against its reasonably foreseeable detriments. The outcome of the general balancing process would determine whether to authorize a proposal, and if so, the conditions under which it will be allowed to occur. The decision should reflect the national concern for both protection and utilization of important resources. All factors, which may be relevant to the proposal, must be considered including the cumulative effects thereof. Among those are conservation, economics, aesthetics, general environmental concerns, wetlands, cultural values, fish and wildlife values, flood hazards, floodplain values, land use, navigation, shore erosion and accretion, recreation, water supply and conservation, water quality, energy needs, safety, food and fiber production, mineral needs, considerations of property ownership, and, in general, the needs and welfare of the people. For activities involving 404 discharges, a permit will be denied if the discharge that would be authorized by such permit would not comply with the Environmental Protection Agency's 404(b)(1) guidelines. Subject to the preceding sentence and any other applicable guidelines or criteria (see Sections 320.2 and 320.3), a permit will be granted unless the District Commander determines that it would be contrary to the public interest.

The Corps is soliciting comments from the public; Federal, State, and local agencies and officials; Indian Tribes; and other interested parties in order to consider and evaluate the impacts of this proposed activity. Any comments received will be considered by the Corps to determine whether to issue, modify, condition or deny a permit for this proposal. To make this decision, comments are used to assess impacts on endangered species, historic properties, water quality, general environmental effects, and the other public interest factors listed above. Comments are used in the preparation of an Environmental Assessment and/or an Environmental Impact Statement pursuant to the National Environmental Policy Act. Comments are also used to determine the need for a public hearing and to determine the overall public interest of the proposed activity.

AUTHORITY: This permit will be issued or denied under the following authorities:

(X) Perform work in or affecting navigable waters of the United States – Section 10 Rivers and Harbors Act 1899 (33 U.S.C. 403).

(X) Discharge dredged or fill material into waters of the United States – Section 404 Clean

Water Act (33 U.S.C. 1344). Therefore, our public interest review will consider the guidelines set forth under Section 404(b) of the Clean Water Act (40 CFR 230).

Project drawings are enclosed with this public notice.

District Commander
U.S. Army, Corps

Enclosures

EXISTING STEEL PILING TO REMAIN (8 TOTAL)



VICINITY
LOCATION

SHEET INDEX	
C1	TITLE & LOCATION MAP
C2	VICINITY MAP
C3	PROPOSED NEW FLOAT & PILING
C4	PROFILE VIEW OF PROPOSED FLOAT

MEAN HIGH WATER ELEV. 9.2 FEET
HIGH TIDE LINE ELEV. 12.8 FEET

Shaan Seet Corporation Dock Repairs	
EXISTING CONDITIONS SCALE: AS NOTED	
APPLICANT: SHAAN SEET INC. 501 MAIN STREET CRAIG, AK 99921	AGENT: R&M ENGINEERING-KETCHIKAN 7180 REVILLA ROAD ROAD KETCHIKAN, AK 99901
DATE: SHEET:	CRAIG, AK WATER BODY: KLAWOCK INLET

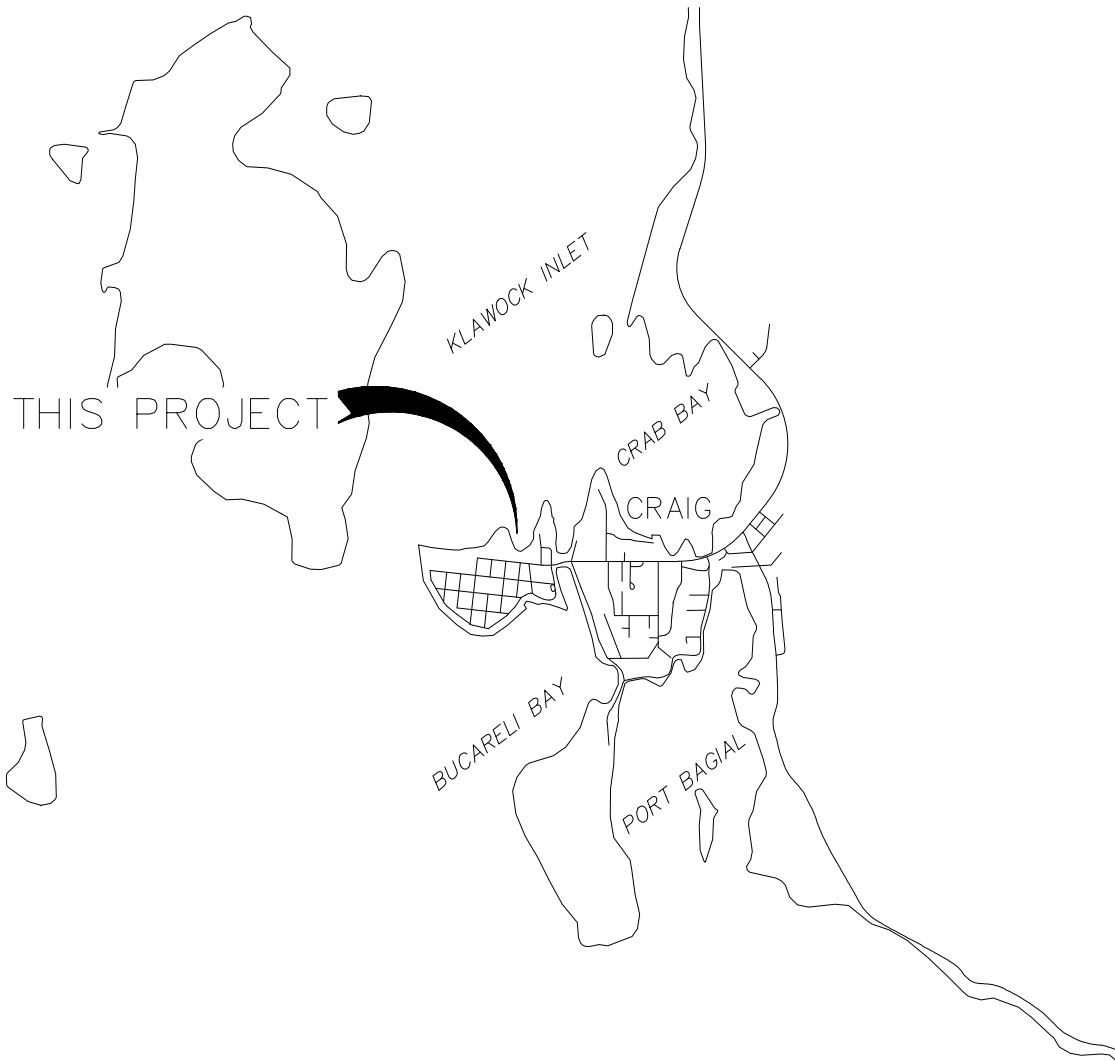

Shaan Seet Corporation Dock Repairs VICINITY MAP SCALE: AS NOTED	
APPLICANT: SHAAN SEET INC. 501 MAIN STREET CRAIG, AK 99921	AGENT: R&M ENGINEERING-KETCHIKAN 7180 REVILLA ROAD ROAD KETCHIKAN, AK 99901
DATE: SHEET: 2 OF 6	CRAIG, AK WATER BODY: KLAWOCK INLET

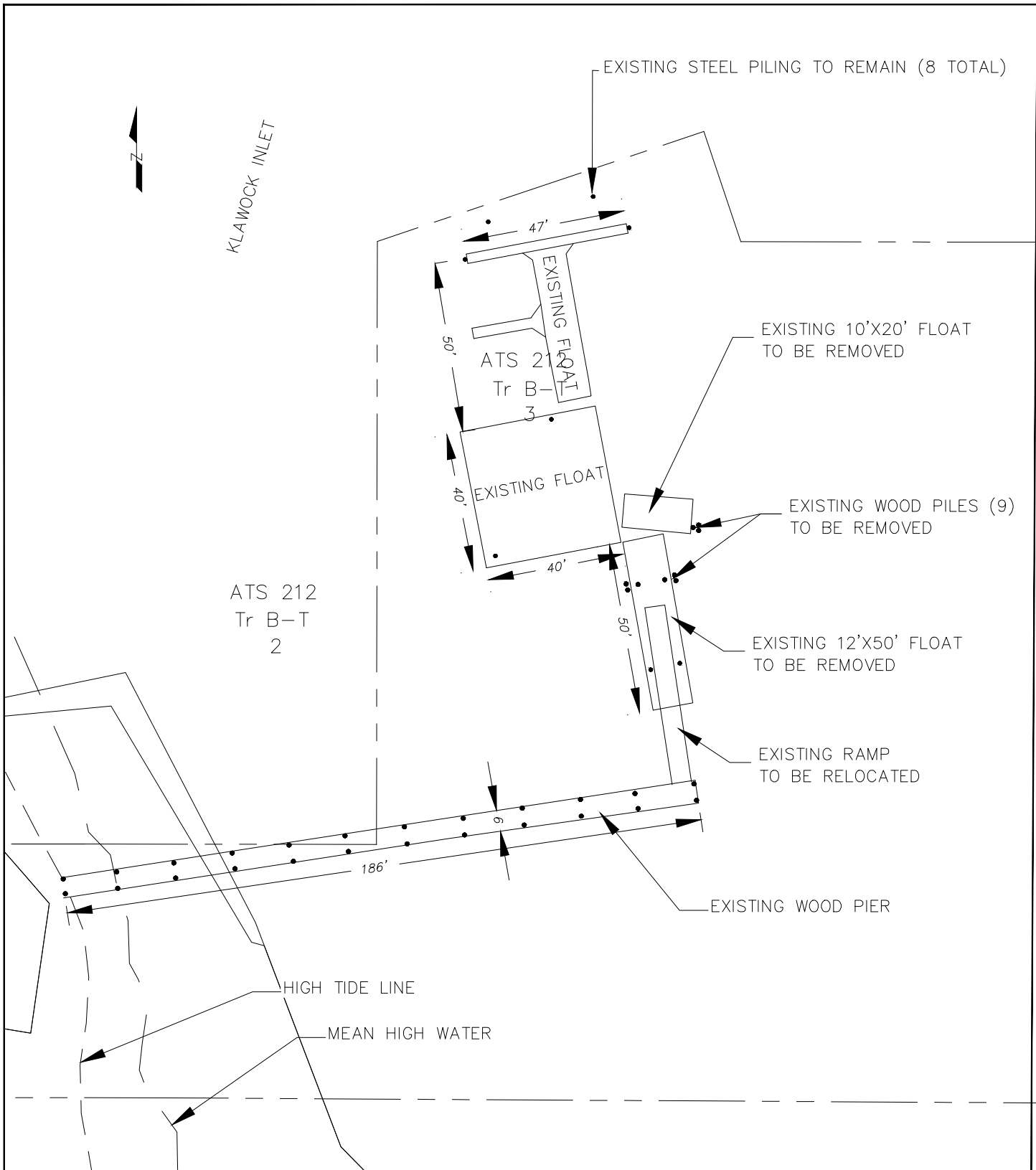

ATS 212
Tr B-T
2

EXISTING STEEL PILING TO REMAIN (8 TOTAL)

EXISTING 10'X20' FLOAT
TO BE REMOVED

EXISTING WOOD PILES (9)
TO BE REMOVED

EXISTING 12'X50' FLOAT
TO BE REMOVED

EXISTING RAMP
TO BE RELOCATED

EXISTING WOOD PIER

HIGH TIDE LINE

MEAN HIGH WATER



MEAN HIGH WATER ELEV. 9.2 FEET
HIGH TIDE LINE ELEV. 12.8 FEET

Shaan Seet Corporation Dock Repairs

EXISTING CONDITIONS
SCALE: AS NOTED

APPLICANT:
SHAAN SEET INC.
501 MAIN STREET
CRAIG, AK 99921

AGENT:
R&M ENGINEERING-KETCHIKAN
7180 REVILLA ROAD ROAD
KETCHIKAN, AK 99901

DATE:
SHEET: 3 OF 6

CRAIG, AK
WATER BODY: Klawock Inlet

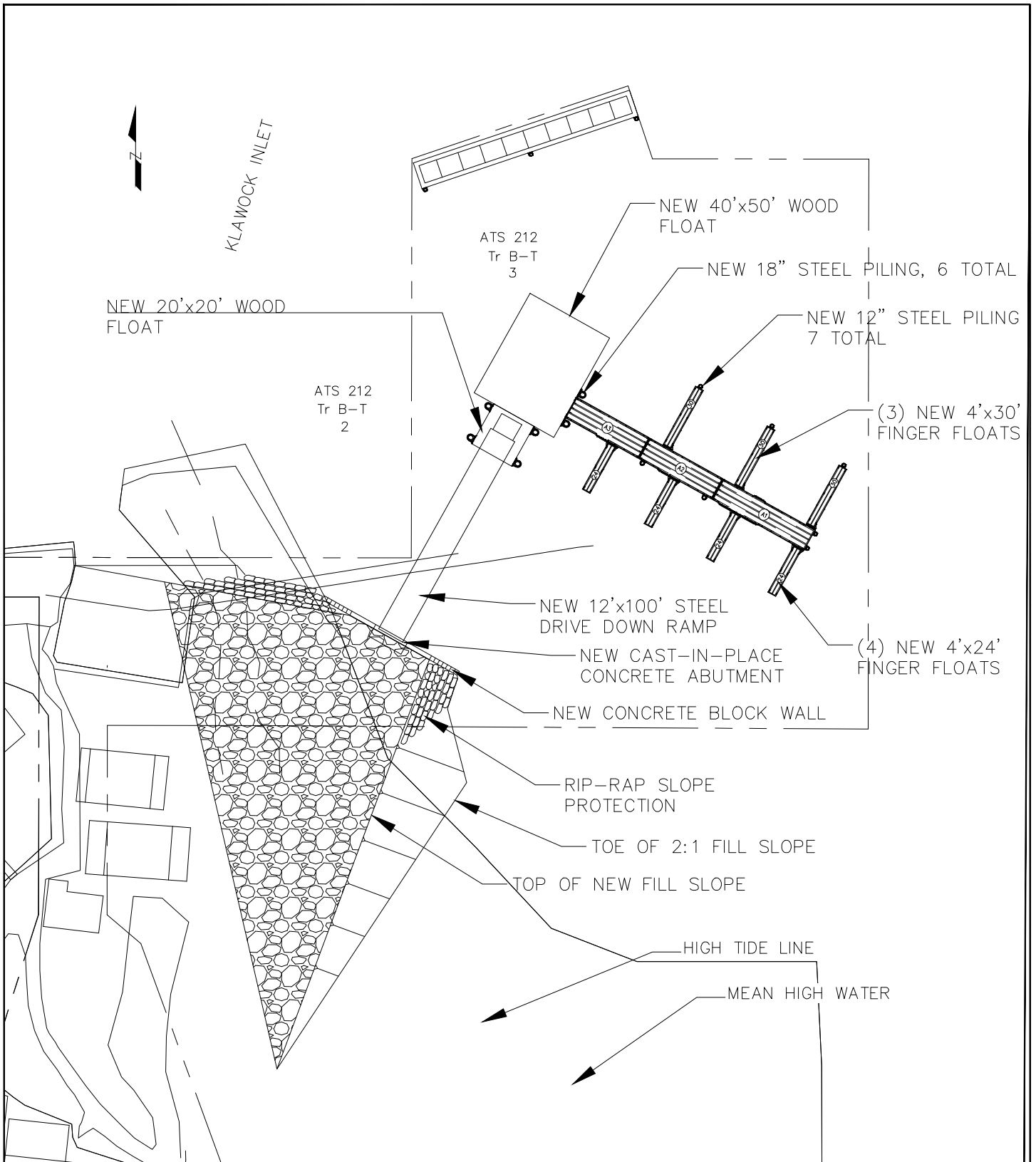

MEAN HIGH WATER ELEV. 9.2 FEET
 HIGH TIDE LINE ELEV. 12.8 FEET

Shaan Seet Corporation Dock Repairs

PROPOSED NEW FLOAT
 SCALE: AS NOTED

APPLICANT:
 SHAAN SEET INC.
 501 MAIN STREET
 CRAIG, AK 99921

AGENT:
 R&M ENGINEERING-KETCHIKAN
 7180 REVILLA ROAD ROAD
 KETCHIKAN, AK 99901

DATE:
 SHEET: 4 OF 6

CRAIG, AK
 WATER BODY: KLAWOCK INLET

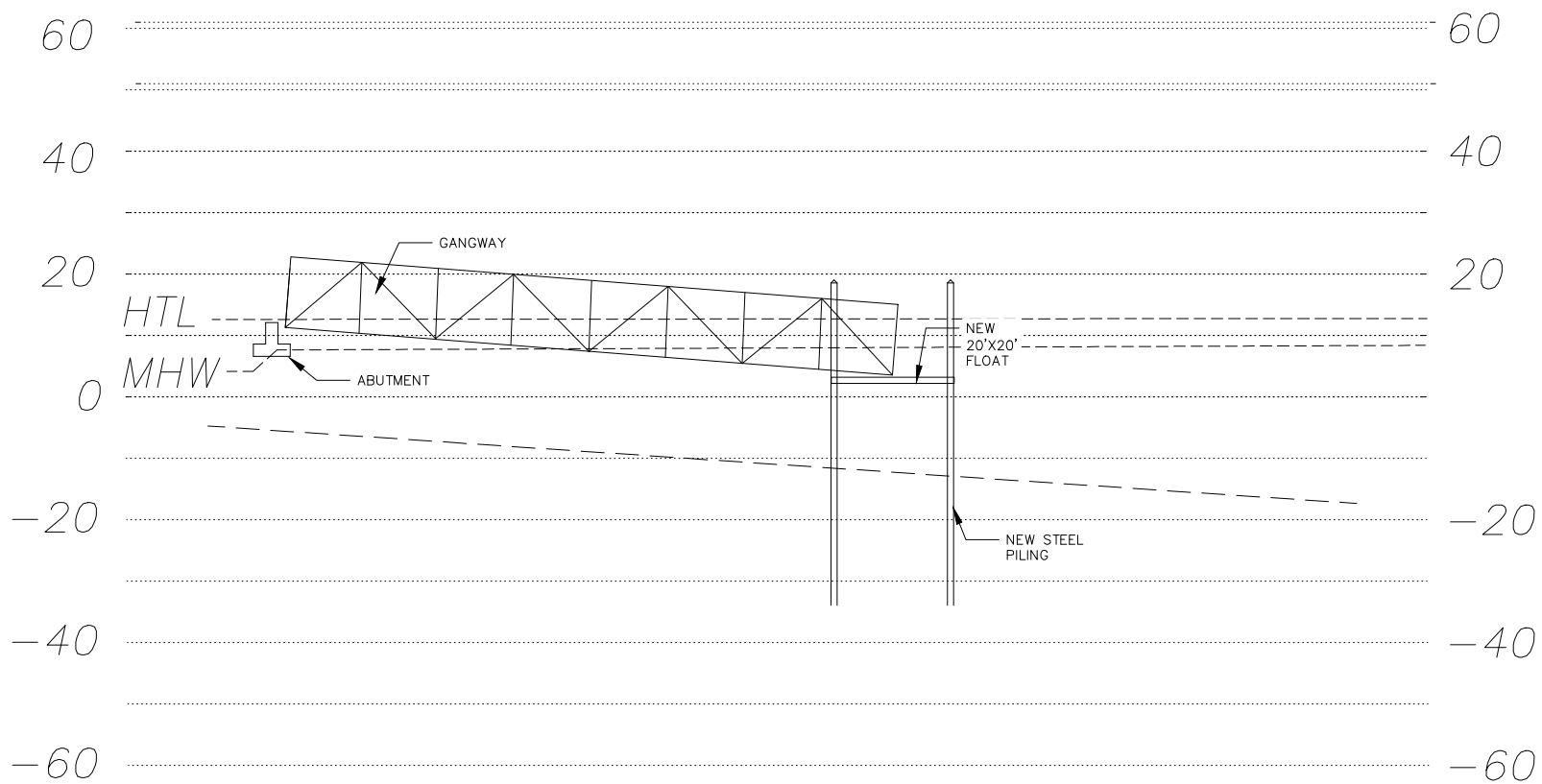

SECTION A - A
TYPICAL PIER - RAMP - FLOAT SECTION

Shaan Seet Corporation Dock Repairs	
PIER-RAMP-FLOAT SECTION	
SCALE: AS NOTED	
APPLICANT: SHAAN SEET INC. 501 MAIN STREET CRAIG, AK 99921	AGENT: R&M ENGINEERING-KETCHIKAN 7180 REVILLA ROAD ROAD KETCHIKAN, AK 99901
DATE: SHEET: 5 OF 6	CRAIG, AK WATER BODY: KLAWOCK INLET

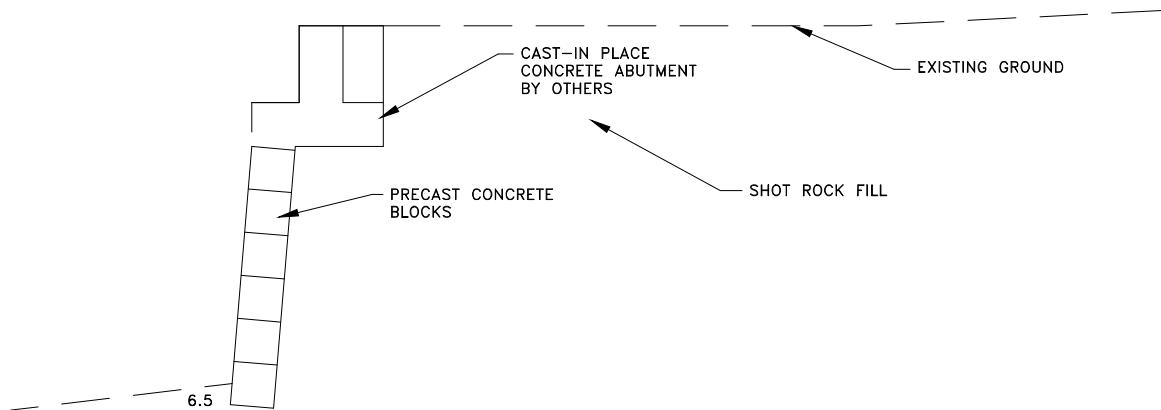
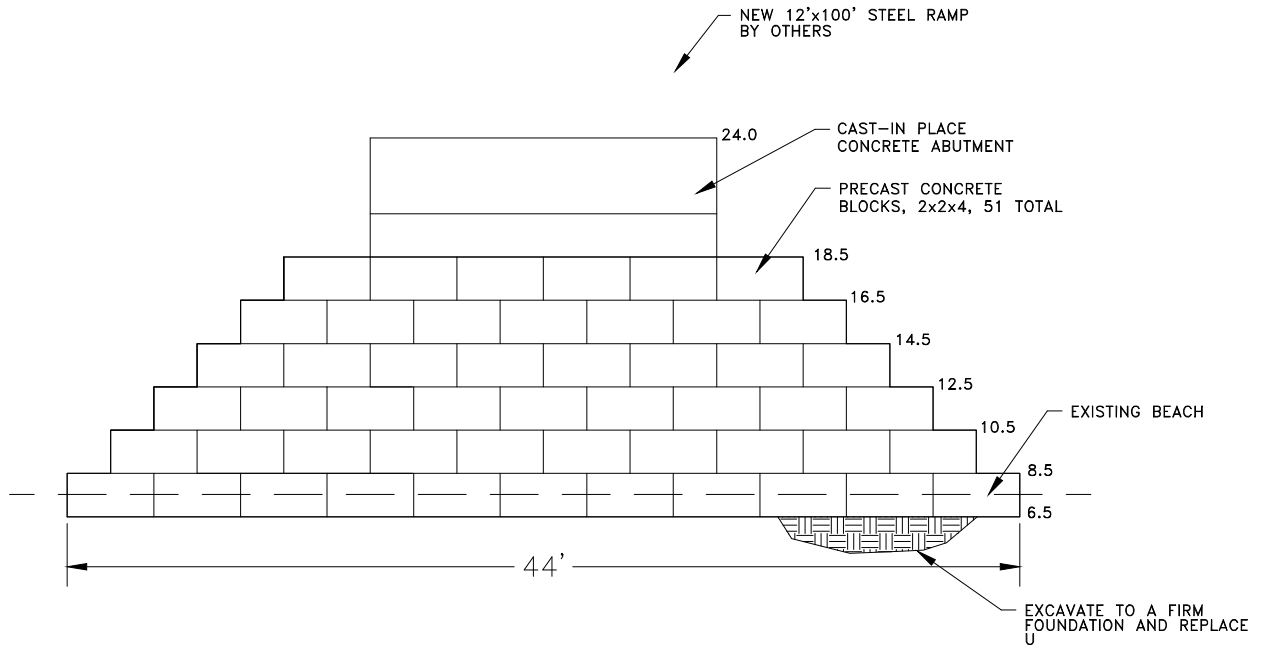

Shaan Seet Corporation Dock Repairs

PIER AND FLOAT CROSS SECTION VIEWS
SCALE: AS NOTED

APPLICANT:
SHAAN SEET INC.
501 MAIN STREET
CRAIG, AK 99921

AGENT:
R&M ENGINEERING-KETCHIKAN
7180 REVILLA ROAD ROAD
KETCHIKAN, AK 99901

DATE:
SHEET: 6 OF 6

CRAIG, AK
WATER BODY: KLAWOCK INLET