



Public Notice

**U.S. Army Corps
of Engineers**
Pittsburgh District

In Reply Refer to
Notice No. below

US Army Corps of Engineers, Pittsburgh District
1000 Liberty Avenue
Pittsburgh, PA 15222-4186

Application No. 2017-265

Date: March 8, 2017

Notice No. 17-13

Closing Date: March 28, 2017

1. **TO ALL WHOM IT MAY CONCERN:** The following application has been submitted for a Department of the Army Permit under the provisions of Section 404 of the Clean Water Act.
2. **APPLICANT:** Pennsylvania Department of Transportation, District 12-0
825 North Gallatin Avenue
Uniontown, PA 15401
3. **LOCATION:** The project is located in South Huntingdon Township, Westmoreland County, Pennsylvania. Decimal Degrees: 40.186149 N, -79.706685 W
4. **PURPOSE AND DESCRIPTION OF WORK:** The applicant proposes to place fill material into waters of the United States for the purpose of improving approximately 2.8 miles of State Route 0070 and the interchange at State Route 0031 in South Huntingdon Township. The proposed work involves the replacement of the SR 0070 Bridge over SR 0031, improve the acceleration and deceleration ramps of the SR 0070 and SR 0031 Interchange, widen the SR 0070 roadway template and curve flattening in order to meet current PennDOT design criteria.

To accommodate the proposed improvements, the T-318 (Smithton Pike) will be realigned and the Smithton Pike Bridge over 0070 will be replaced and realigned to improve roadway geometrics and sight distance. Additionally, T-402 (Davis Road) is situated adjacent to SR 0070 and intersects Smithton Pike at this location. T-402 will be relocated to accommodate the cut slope, curve flattening and widening roadway template for SR 0070.

The proposed project will impact approximately 7,407 linear feet (LF) of wetted channel, of which 1,063 LF would be a loss and mitigated for on-site adjacent to SR 0070. Temporal impacts to wetted channels total 6,568 LF and will be restored upon completion of the proposed work. Approximately 0.60 acres of permanent wetland impacts and 0.17 acres of temporary impacts are anticipated as a result of the proposed project. Compensatory mitigation consist of relocating approximately 5,010 LF of channel along the project corridor along with 1,150 LF of stream enhancements and the creation of a 0.85 acre wetland at the stream and wetland mitigation site. Drawings of the proposed project are attached. Additional details and/or drawings of the proposed project and mitigation area are available upon request.

5. ENCROACHMENT PERMIT: The applicant must obtain a Water Obstruction and Encroachment Permit which includes 401 Water Quality Certification from the:

*Pennsylvania Department of Environmental Protection
Southwest Regional Office
Waterways and Wetlands Section
400 Waterfront Drive
Pittsburgh, PA 15222-4745*

Telephone: 412-442-4000

6. IMPACT ON NATURAL RESOURCES: The District Engineer has consulted the most recently available information and has determined that the proposed project may affect, but is not likely to adversely affect endangered species or threatened species, or result in destruction or adverse modification of habitat of such species which has been determined to be critical. This Public Notice serves as a request to the U.S. Fish and Wildlife Service for any additional information they may have on whether any listed or proposed to be listed endangered or threatened species may be present in the area which would be affected by the activity, pursuant to Section 7(c) of the Endangered Species Act of 1972 (as amended). If the U.S. Fish and Wildlife Service concurs with the may affect, not likely to adversely affect determination please respond with written concurrence.

7. IMPACT ON CULTURAL RESOURCES: The National Register of Historic Places has been consulted, and it has been determined that there are no properties currently listed on the register which would be directly affected by the proposed work. If we are made aware, as a result of comments received in response to this notice, or by other means, of specific archeological, scientific, prehistorical, or historical sites or structures which might be affected by the proposed work, the District Engineer will immediately take the appropriate action necessary pursuant to the National Historic Preservation Act of 1966 - Public Law 89-665 as amended (including Public Law 96-515).

8. PUBLIC INVOLVEMENT: Any person may request, in writing, within the comment period specified in the paragraph below entitled "RESPONSES," that a public hearing be held to consider this application. The requests for public hearing shall state, with particularity, the reasons for holding a public hearing.

9. EVALUATION: Interested parties are invited to state any objections they may have to the proposed work. The decision whether to issue a permit will be based on an evaluation of the probable impact including cumulative impacts of the proposed activity on the public interest. That decision will reflect the national concern for both protection and utilization of important resources. The benefit which reasonably may be expected to accrue from the proposals must be balanced against its reasonably foreseeable detriments. All factors which may be relevant to the proposal will be considered including the cumulative effects thereof; among those are conservation, economics, aesthetics, general environmental concerns, wetlands, historic

properties, fish and wildlife values, flood hazards, flood plain values, land use, navigation, shoreline erosion and accretion, recreation, water supply and conservation, water quality, energy needs, safety, food and fiber production, mineral needs, considerations of property ownership and, in general, the needs and welfare of the people. The Corps of Engineers is soliciting comments from the public; Federal, state, and local agencies and officials; Indian Tribes; and other interested parties in order to consider and evaluate the impacts of this proposed activity. Any comments received will be considered by the Corps of Engineers to determine whether to issue, modify, condition or deny a permit for this proposal. To make this decision, comments are used to assess impacts on endangered species, historic properties, water quality, general environmental effects, and the other public interest factors listed above. Comments are used in the preparation of an Environmental Assessment and/or an Environmental Impact Statement pursuant to the National Environmental Policy Act. Comments are also used to determine the overall public interest of the proposed activity. The evaluation of the impact of the activity on the public interest will include application of the guidelines promulgated by the Administrator, Environmental Protection Agency, under the authority of Section 404(b) of the Clean Water Act (40 CFR Part 230).

10. **RESPONSES:** A permit will be granted unless its issuance is found to be contrary to the public interest. Written statements concerning the proposed activity should be received in this office on or before the closing date of this Public Notice in order to become a part of the record and to be considered in the final determination. Any objections which are received during this period may be forwarded to the applicant for possible resolution before the determination is made whether to issue or deny the requested DA Permit. All responses to this notice should be directed to the Regulatory Branch, attn Allen R. Edris at the above address, by telephoning (412) 395-7158, or by e-mail at allen.r.edris@usace.army.mil. Please refer to CELRP-OP-F 2017-265 in all responses.

FOR THE DISTRICT ENGINEER:

~SIGNED~

Jon T. Coleman
Chief, Southern Section
Regulatory Branch

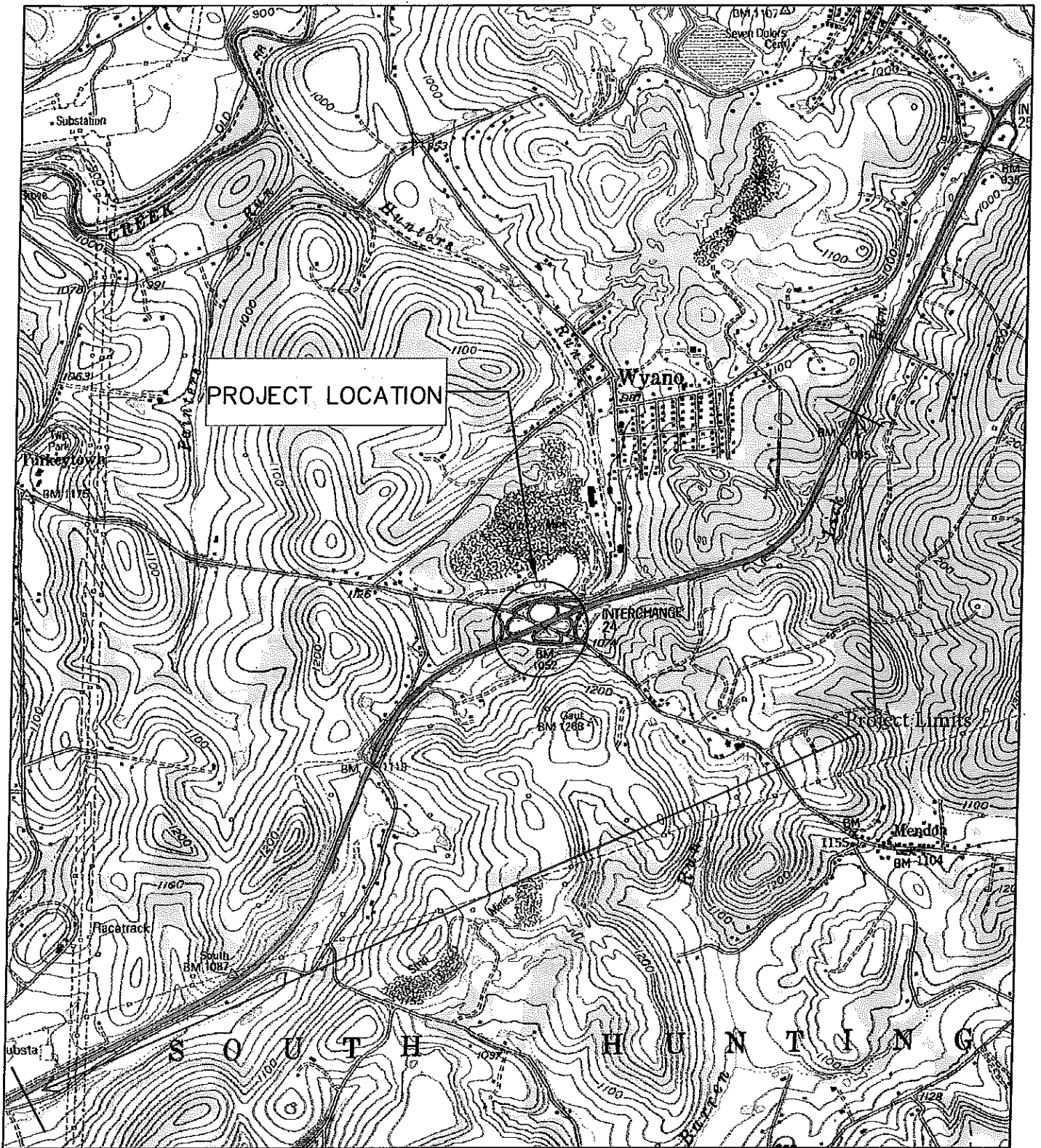

LOCATION MAP

Scale: 1" = 2000 Feet

Route: S.R. 0070 SEC K10

Municipality: SOUTH HUNTINGTON TOWNSHIP

County: WESTMORELAND

State: PA

○ PROJECT LOCATION

USGS QUAD: SMITHTON

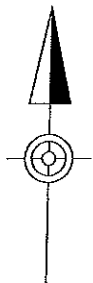

SHEET INDEX BLOCK	
DESCRIPTION	SHEET
TITLE SHEET	1
INDEX MAPS	2 TO 7
IMPACT PLAN SHEETS	8 TO 17

IMPACT PLAN (JANUARY, 2017)

PENNSYLVANIA

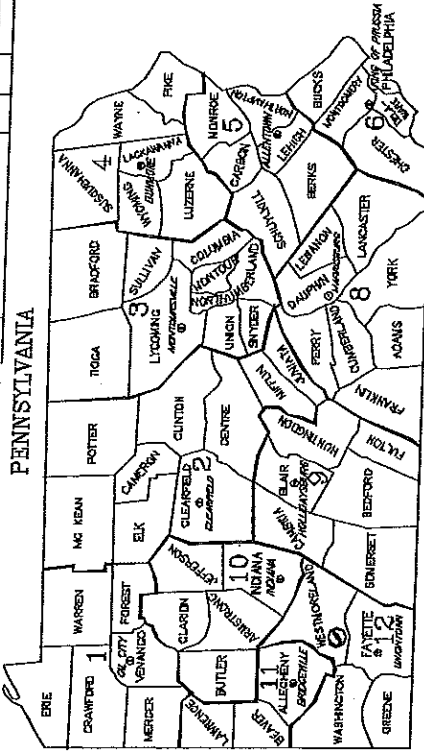

12 DISTRICT
 ⑨ DISTRICT OFFICE
 ⑩ PROJECT LOCATION

LEGEND
 ○ PLAN SHEET
 — SHEET BREAK

INDEX MAP
 0 100 200
 SCALE IN FEET

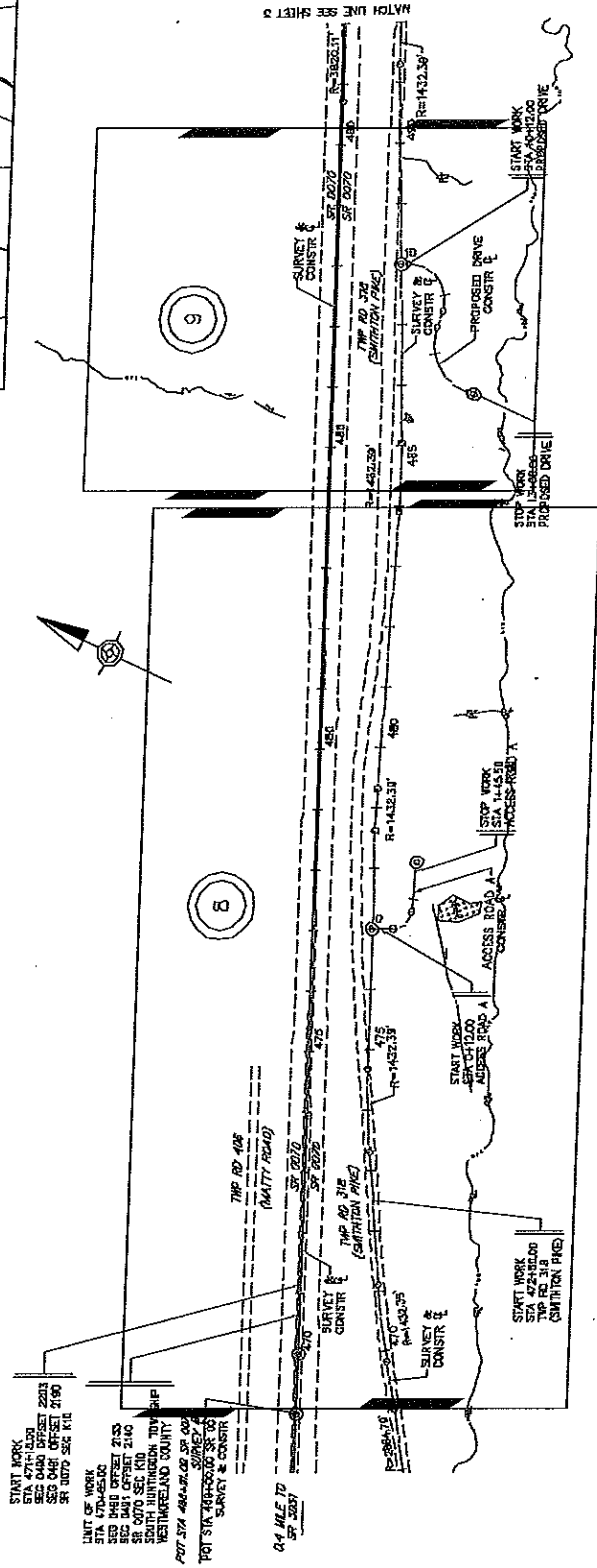

PROJECT	WESTWELAND	DATE	NOV 17 2017
CLIENT	WESTWELAND	PROJECT	GOVTS
LOCATION	30111	SCALE	AS SHOWN
DATE		BY	
APPROVED		DATE	

IMPACT PLAN
(JANUARY, 2017)

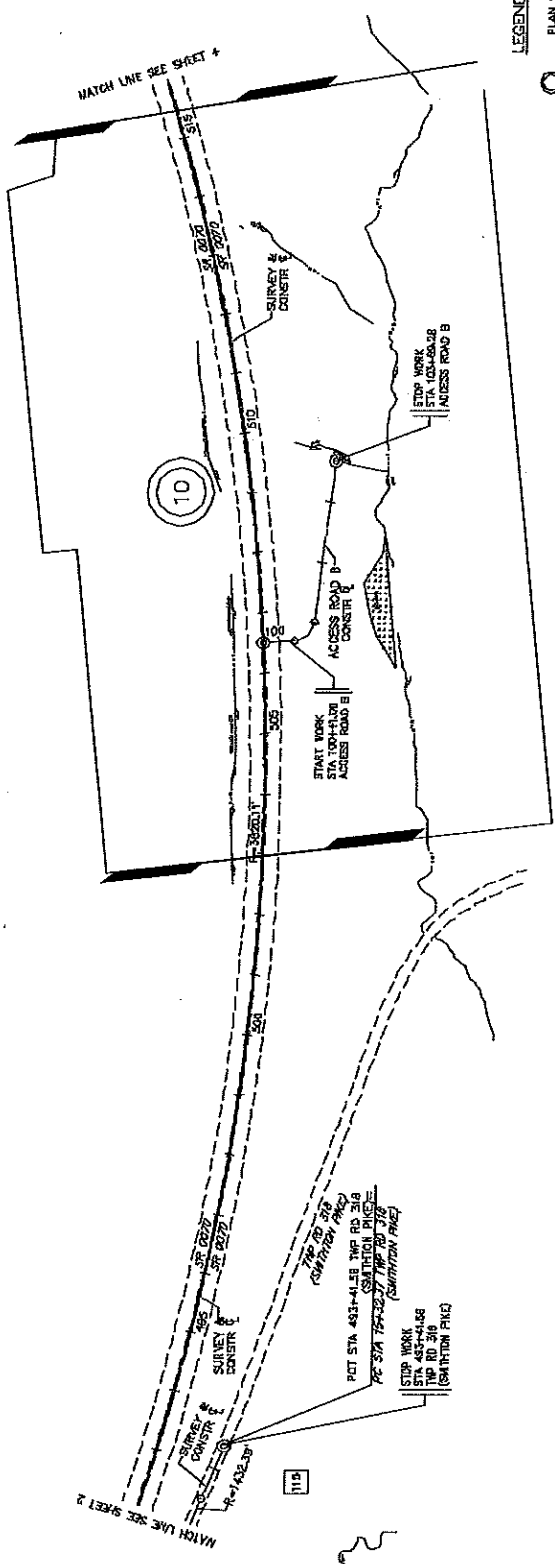
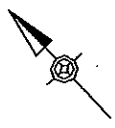

LEGEND
 PLAN SHEET
 SHEET BREAK

INDEX MAP

 SCALE IN FEET



PROJECT	12-0	CITY	WESTMORELAND	SECTION	KIG	SHEET	3 OF 17
TITLE	SOUTH LUTHERBURGH TOWNSHIP						
DATE		BY		DATE		BY	
APPROVED							

IMPACT PLAN
(JANUARY, 2017)

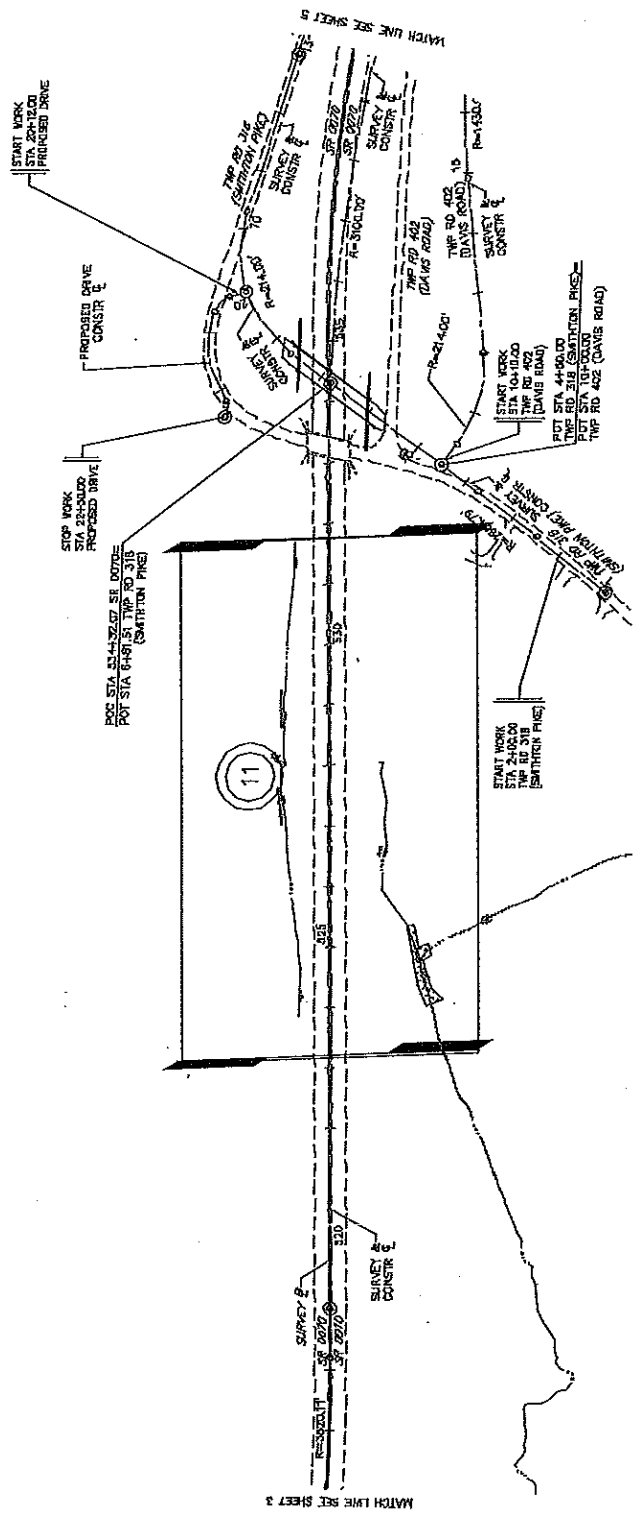

LEGEND

○ PLAN SHEET

— SHEET BREAK

INDEX MAP

0 100 200

SCALE IN FEET



IMPACT PLAN
(JANUARY, 2017)

PROJECT NO.	12-4	DATE	WESTMORELAND	SECTION	4 OF 17
TOWNSHIP	SOUTH HUNTINGTON	DATE	WESTMORELAND	SECTION	4 OF 17
BY		DATE		BY	
APPROVED BY		DATE		BY	

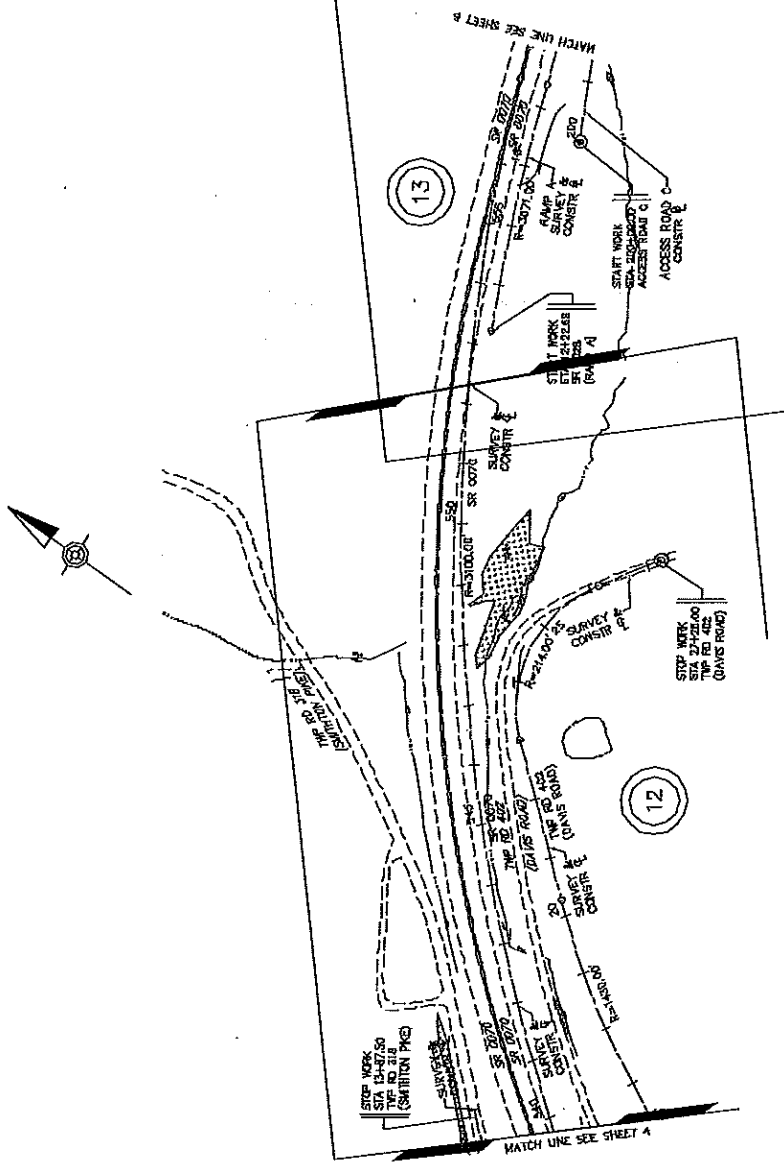

LEGEND
 ○ PLAN SHEET
 — SHEET BREAK

INDEX MAP
 0 100 200
 SCALE IN FEET



IMPACT PLAN
(JANUARY, 2017)

PROJECT NO.	12-0	DATE	0075	SHEET	6 OF 17
CITY	WESTMORLAND	TOWNSHIP	SOUTH PARTINGTON	RCG	
DATE		BY		APPROVED	
BY		DATE			

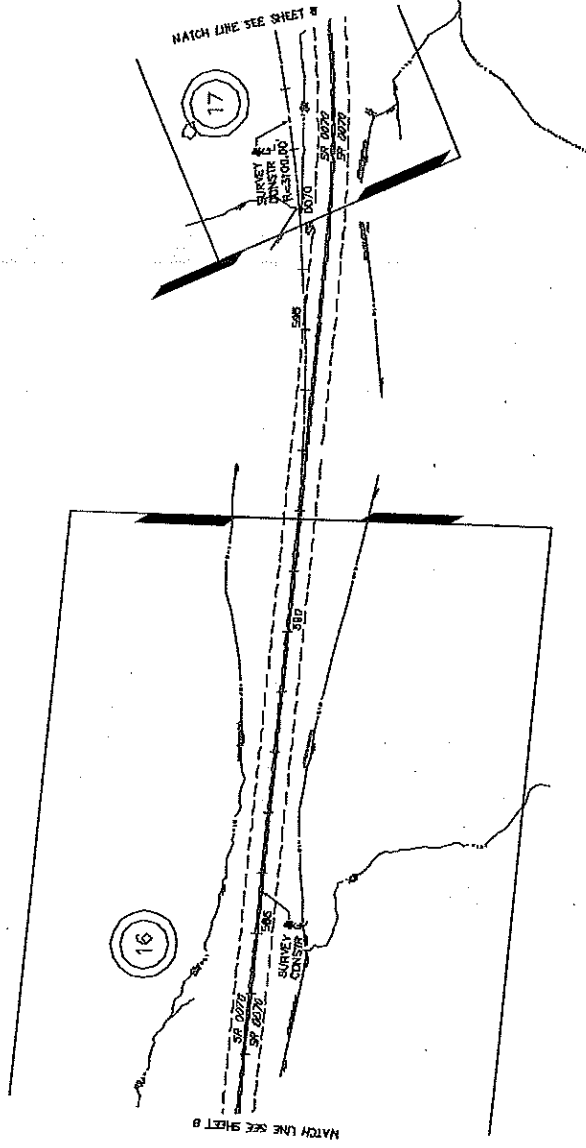

LEGEND

- PLAN SHEET
- SHEET BREAK

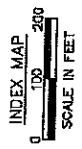

ESTIMATE	COUNTY	TOWNSHIP	RANGE	SECTION	SHEET
12-0	WESTMORELAND	SOUTH HUNTINGTON	8070	R10	8 OF 17
PROJECT	SOUTH HUNTINGTON TOWNSHIP				
OWNER	INDIVIDUAL				
DATE	BY				

IMPACT PLAN
(JANUARY, 2017)

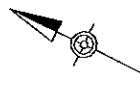

IMPACT SUMMARY TABLE

NO.	RESOURCE IMPACTED	IMPACT TYPE	LATITUDE/LONGITUDE	PERMANENT IMPACT LENGTH	PERMANENT IMPACT AREA	TEMPORARY IMPACT LENGTH	TEMPORARY IMPACT AREA
1	ST-12	MITIGATION SITE/NEW OUTFALL	40°10'17.68" N / 79°43'24.24" W	1150 LF	6,500 SF	1250 LF	5,000
2	ST-24	NEW OUTFALLS/ VARIOUS SIZES	40°10'21.18" N / 79°43'14.75" W	23 LF	25 SF	130 LF	1,300 SF
3	ST-24S	PERMANENT IMPACTS	40°10'18.00" N / 79°43'23.00" W	80 LF	80 SF	---	---
4	W-30B	WETLAND IMPACT W-30B	40°10'17.28" N / 79°43'20.95" W	---	2,170 SF	---	---

LEGEND

- FILL
- CUT
- 100 YEAR PROPOSED BACKWATER
- 100 YEAR EXISTING BACKWATER
- FILL IN FLOODPLAIN
- PERMANENT WETLAND IMPACT
- TEMPORARY WETLAND IMPACT
- RELOCATED CHANNEL

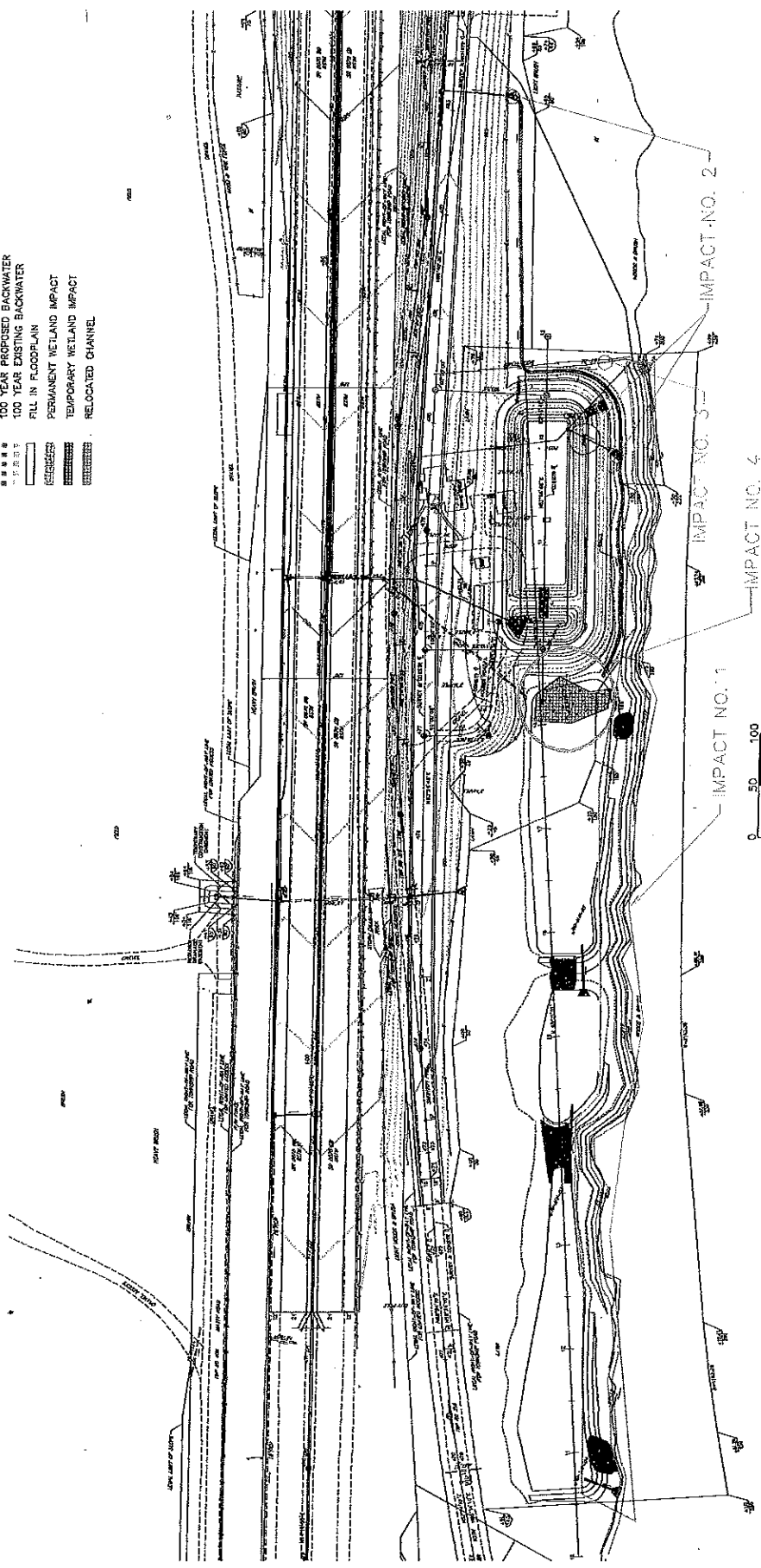

CONTRACT	COUNTY	TOWNSHIP	SHEET
12-0	WESTMORELAND	KID	9 OF 17
PROJECT	SECTION		
	SOUTH HUNTINGDON TOWNSHIP		
	RECORDS		

IMPACT PLAN
(JANUARY, 2016)



IMPACT SUMMARY TABLE

NO.	RESOURCE IMPACTED	IMPACT TYPE	LATITUDE/LONGITUDE	PERMANENT IMPACT LENGTH	PERMANENT IMPACT AREA	TEMPORARY IMPACT LENGTH	TEMPORARY IMPACT AREA
5	ST-22	FILL IN R/O CANAL AND IMPACTS	40°10' 23.67" N / 79°43' 13.24" W	323 LF	2,410 SF	433 LF	4,580 SF
6	ST-22	STREAM	40°10' 23.15" N / 79°43' 12.18" W	4 LF	15 SF	30 LF	418 SF
7	ST-12	ST-12 TEMPORARY IMPACTS	40°10' 23.67" N / 79°43' 11.92" W	34 LF	340 SF	85 LF	120 SF
8	ST-21	NEW OUTFALL	40°10' 23.95" N / 79°43' 7.86" W	60 LF	240 SF		
9	ST-21	STREAM	40°10' 24.00" N / 79°43' 7.52" W				

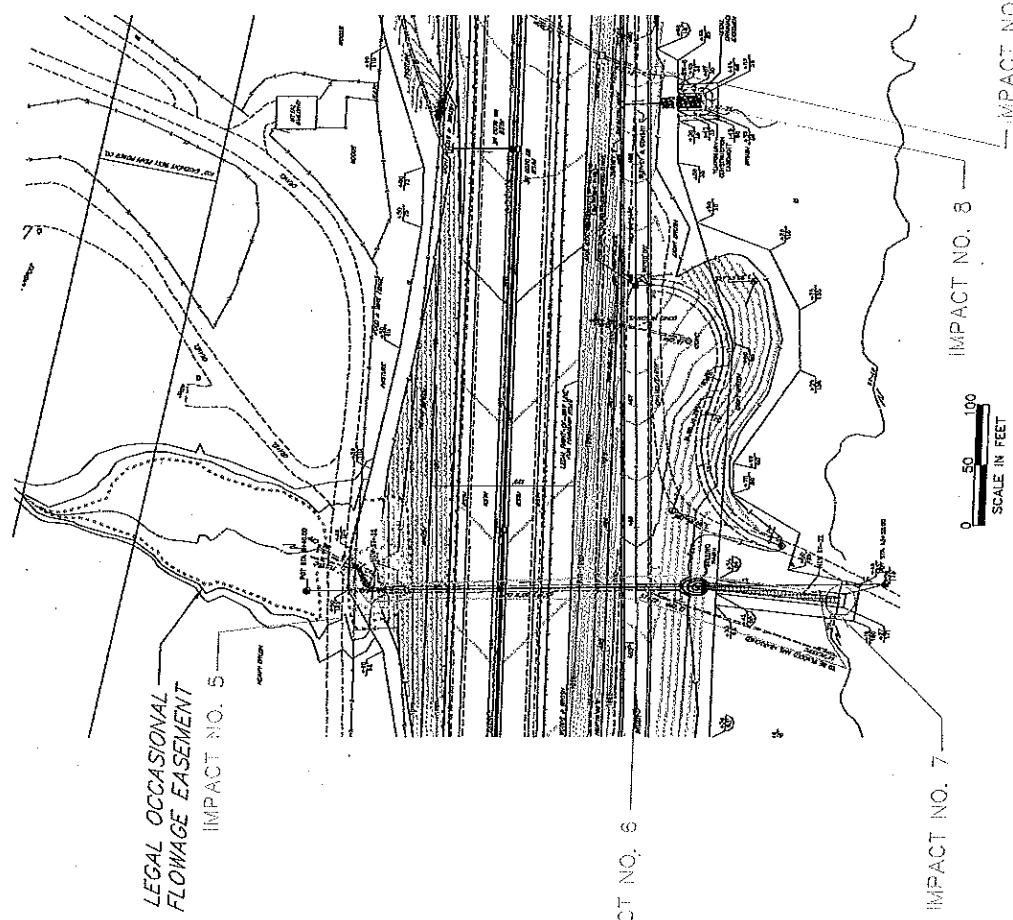

- LEGEND**
- FILL
 - CUT
 - 100 YEAR PROPOSED BACKWATER
 - 100 YEAR EXISTING BACKWATER
 - FILL IN FLOODPLAIN
 - PERMANENT WETLAND IMPACT
 - TEMPORARY WETLAND IMPACT
 - RELOCATED CHANNEL



IMPACT NO. 9

IMPACT NO. 7

IMPACT NO. 6

LEGAL OCCASIONAL
FLOWAGE EASEMENT

IMPACT NO. 5

PROJECT	CLIENT	DATE	SCALE	SHEET
12-0	WESTMORELAND COUNTY	03/20	1" = 40'	10 OF 17
PROJECT	LOCATION	DATE	SCALE	SHEET
12-0	SOUTH HUNTINGDON TOWNSHIP	03/20	1" = 40'	10 OF 17

IMPACT PLAN
(JANUARY, 2017)

IMPACT SUMMARY TABLE

NO.	RESOURCE IMPACTED	IMPACT TYPE	LATITUDE/LONGITUDE	PERMANENT IMPACT LENGTH	PERMANENT IMPACT AREA	TEMPORARY IMPACT LENGTH	TEMPORARY IMPACT AREA	TEMPORARY IMPACT AREA
10	ST-12	NEW OUTFALL	40°10'37.39"N / 78°42'45.17"W	2 LF	8 SF	40 LF	120 SF	120 SF
11	ST-19	NEW OUTFALL	40°10'40.28"N / 78°42'45.66"W	1 LF	26 SF	180 LF	540 SF	540 SF
12	ST-20	STREAM ST-20 IMPACTS	40°10'37.39"N / 78°42'45.12"W	155 LF	508 SF	1,027 SF	1,865 SF	1,865 SF
13	WL-10	WETLAND IMPACTS WL-10	40°10'34.71"N / 78°42'48.15"W	---	---	---	---	---
14	WL-09	WETLAND IMPACTS WL-09	40°10'36.5"N / 78°42'47.37"W	---	284 SF	---	---	---

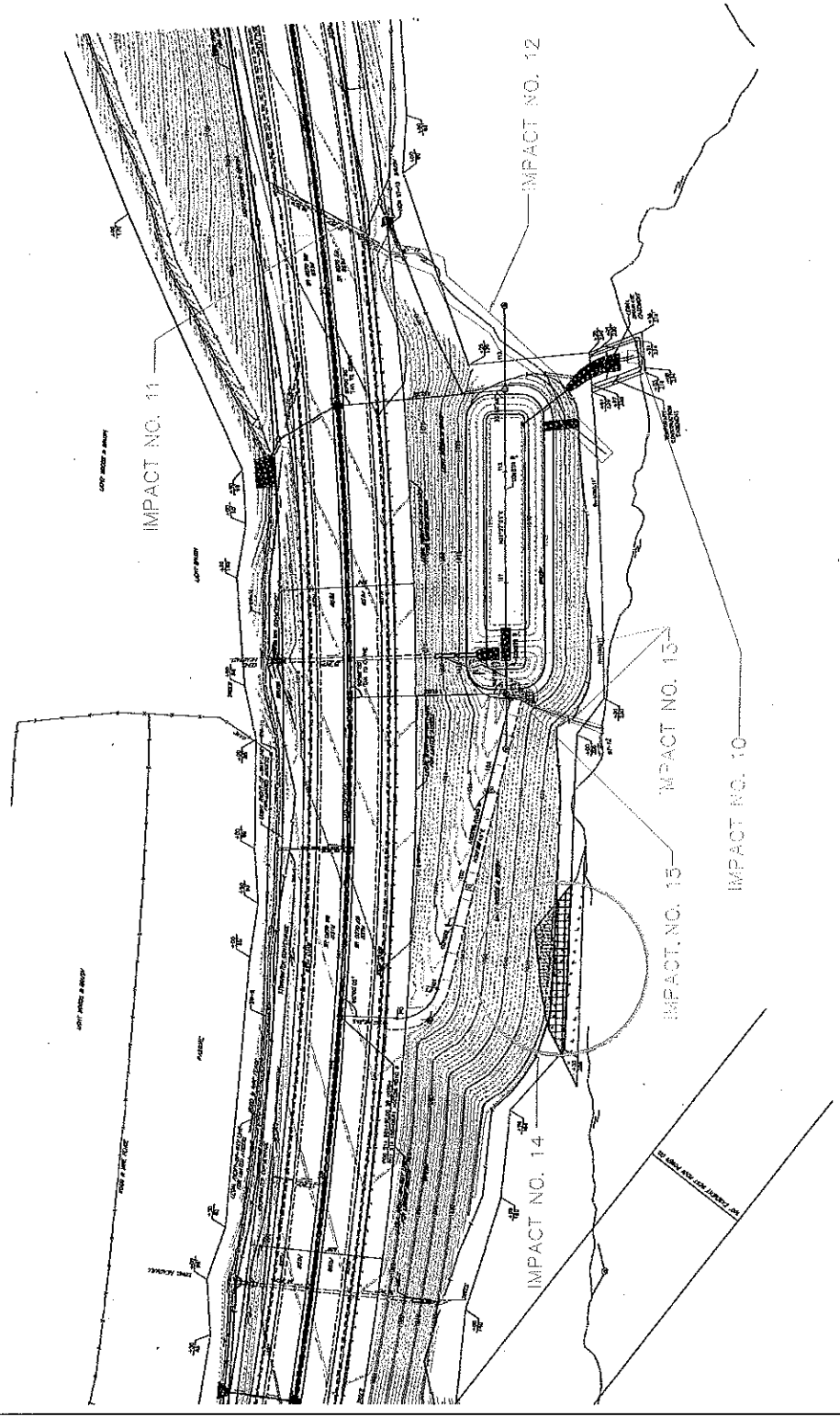

DISTRICT	COUNTY	TOWNSHIP	SECTION	SHEET
12-C	WESTMORELAND	0070	K10	12 OF 17
PROJECT NUMBER	SOUTH HASTINGSBORO TOWNSHIP			
DATE	JANUARY, 2017			

IMPACT PLAN
(JANUARY, 2017)

IMPACT SUMMARY TABLE

NO.	RESOURCE IMPACTED	IMPACT TYPE	LATITUDE/LONGITUDE	PERMANENT IMPACT LENGTH	PERMANENT IMPACT AREA	TEMPORARY IMPACT LENGTH	TEMPORARY IMPACT AREA
17	ST-09	INTERMITTENT ST-09 IMPACTS	401111.20 N / 7942 28.55 W	380 LF	3,480 SF	570 LF	4,000 SF
18	ST-11	PERMANENT IMPACTS	401111.20 N / 7942 28.55 W	30 LF	60 SF	-	-
19	ST-10	PERMANENT IMPACTS	4011 8.99 N / 7942 23.53 W	108 LF	900 SF	-	-
20	WL-03	WETLAND IMPACTS WL-03/DULV EXT	401110.34 N / 7942 23.64 W	-	8,700 SF	-	3,652 SF

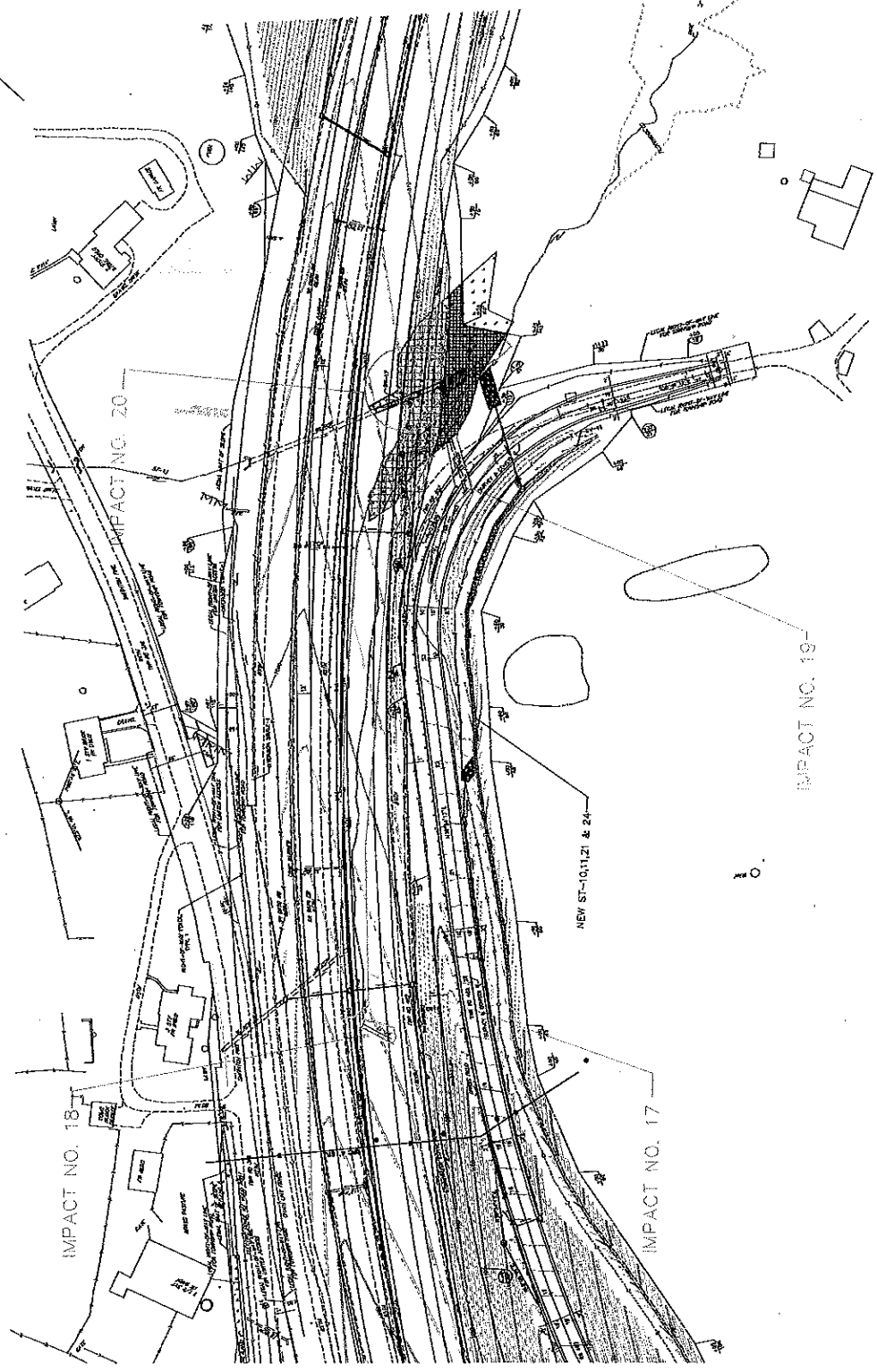

LEGEND

- FILL
- - - CUT
- 100 YEAR PROPOSED BACKWATER
- 100 YEAR EXISTING BACKWATER
- FILL IN FLOODPLAIN
- PERMANENT WETLAND IMPACT
- TEMPORARY WETLAND IMPACT
- RELOCATED CHANNEL

IMPACT SUMMARY TABLE

NO.	RESOURCE IMPACTED	IMPACT TYPE	LATITUDE/LONGITUDE	PERMANENT IMPACT LENGTH	PERMANENT IMPACT AREA	TEMPORARY IMPACT LENGTH	TEMPORARY IMPACT AREA
21	ST-09	ST-09 INT. IMPACT CONT.	40°11'15.89" N / 79°42'10.14" W	800 LF	4,860 SF	850 LF	5,100 SF
22	ST-09	NEW OUTFALL	40°11'14.53" N / 79°42'13.61" W	4 LF	20 SF	20 SF	100 SF
23	ST-09	FILL IN FLOODWAY AND IMPACTS	40°11'15.99" N / 79°42'9.25" W	105 LF	6,970 SF	105 LF	6,970 SF
24	ST-15	ST-15 PERMANENT IMPACTS	40°11'15.78" N / 79°42'14.24" W	105 LF	6,100 SF	105 LF	6,100 SF
25	ST-14	ST-14 PERMANENT IMPACTS	40°11'17.00" N / 79°42'12.45" W	408 LF	616 SF	408 LF	616 SF

DISTRICT	COUNTY	TOWNSHIP	SECTION	DATE	SHEET
12-0	WESTMORELAND	SOUTH HUNTINGTON TOWNSHIP	4070	13 OF 17	
PROJECT NUMBER	IMPACT PLAN (JANUARY, 2017)				

**IMPACT PLAN
(JANUARY, 2017)**

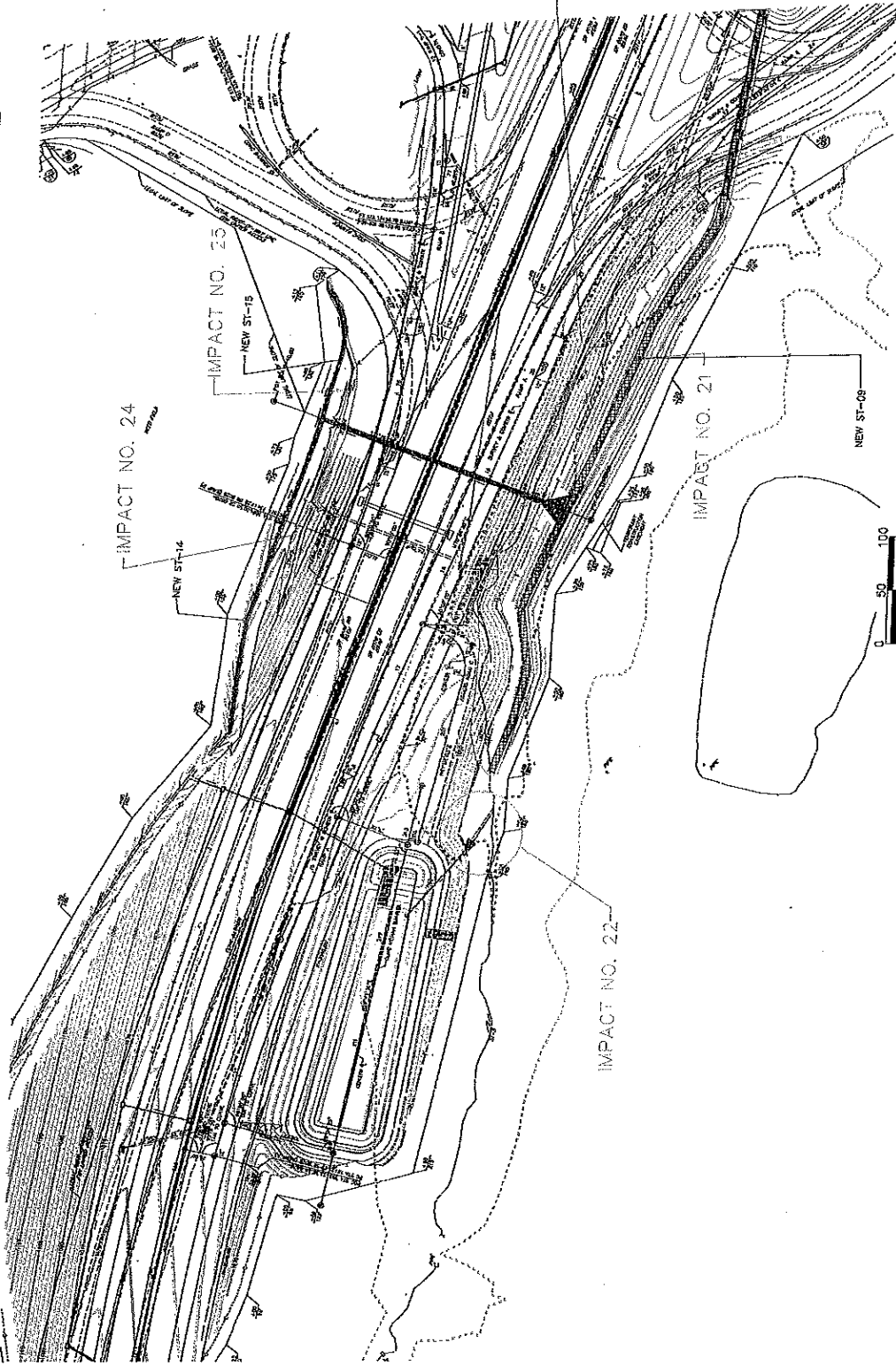
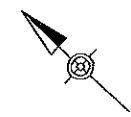

IMPACT NO. 23

IMPACT NO. 22

IMPACT NO. 24

IMPACT NO. 25

NEW ST-14

NEW ST-15

NEW ST-09

RELOCATED CHANNEL

SCALE IN FEET
0 50 100

- LEGEND**
- FILL
 - - - CUT
 - 100 YEAR PROPOSED BACKWATER
 - 100 YEAR EXISTING BACKWATER
 - FILL IN FLOODPLAIN
 - PERMANENT WETLAND IMPACT
 - TEMPORARY WETLAND IMPACT
 - RELOCATED CHANNEL

PROJECT NO.	12-0	COUNTY	WESTMORELAND	TOWNSHIP	SOOTH HURTINGTON	SECTION	K10	SHEET	14 OF 17
TOWN	SOOTH	ROADS	ROADS	DATE					

IMPACT PLAN
(JANUARY, 2017)



LEGEND

- FILL
- CUT
- 100 YEAR PROPOSED BACKWATER
- 100 YEAR EXISTING BACKWATER
- FILL IN FLOODPLAIN
- PERMANENT WETLAND IMPACT
- TEMPORARY WETLAND IMPACT
- RELOCATED CHANNEL

IMPACT SUMMARY TABLE

NO.	RESOURCE IMPACTED	IMPACT TYPE	LATITUDE/LONGITUDE	PERMANENT IMPACT LENGTH	PERMANENT IMPACT AREA	TEMPORARY IMPACT LENGTH	TEMPORARY IMPACT AREA
23	ST-09	ST-09 INT. IMPACTS CONT.	401115.84°N / 794210.14°W	800 LF	8,000 SF	850 LF	5,100 SF
24	ST-09	FILL IN FLOODWAY AND IMPACTS	401115.85°N / 794210.25°W	800 LF	8,000 SF	850 LF	5,100 SF
25	ST-09	ST-09 PERENNIAL PERM. IMPACTS	401117.65°N / 794213.79°W	944 LF	9,440 SF	1,044 LF	10,440 SF
27	ST-09	NEW OUTFALL VARIOUS SIZES	401118.80°N / 794212.12°W	25 LF	250 SF	25 LF	250 SF
28	WETLAND	WETLAND IMPACTS WL-07	401118.92°N / 794180.00°W	25 LF	250 SF	25 LF	250 SF

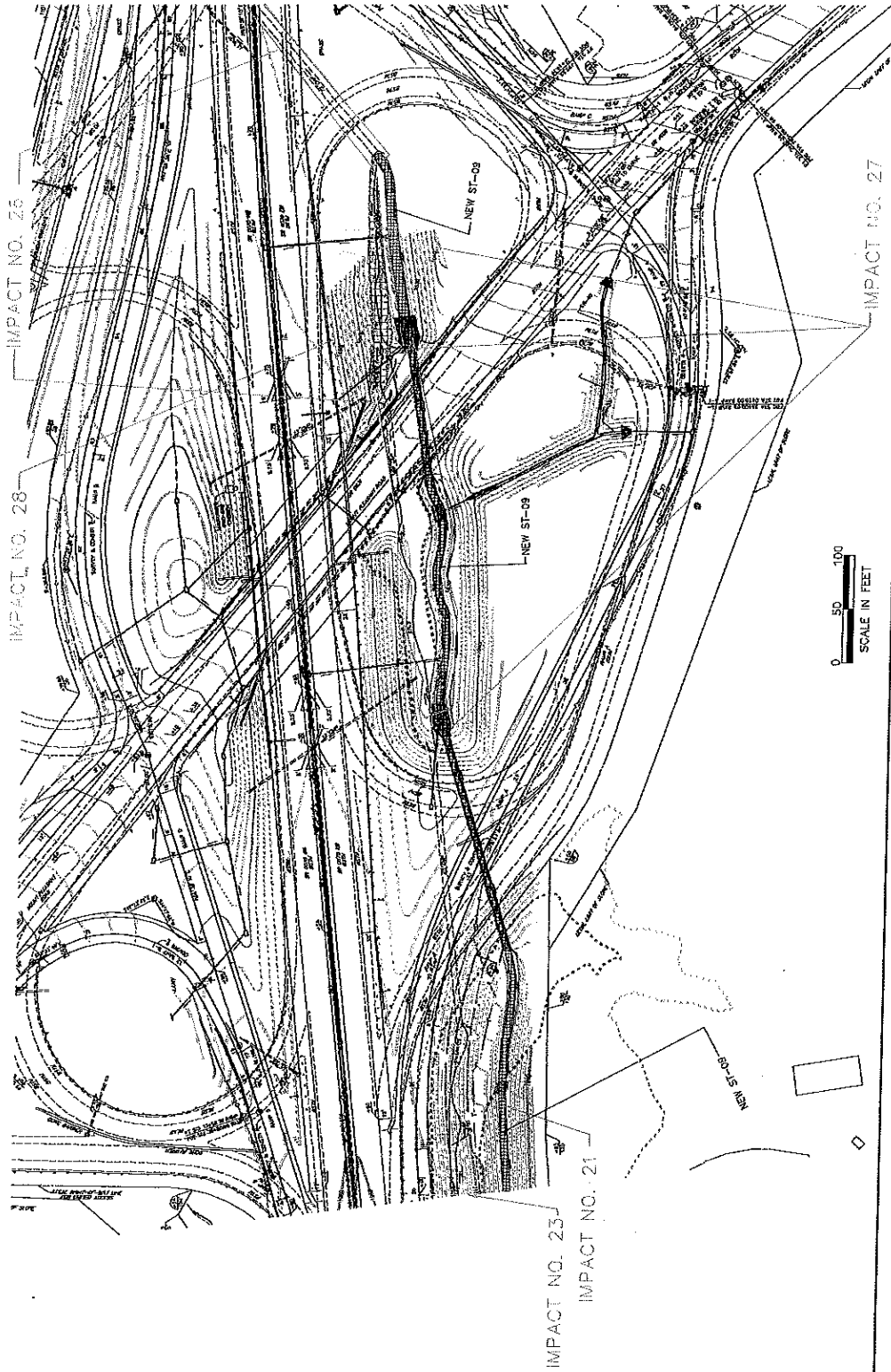

SHEET NUMBER	COUNTY	TOWNSHIP	SECTION
12-0	WESTMORELAND	0270	15 OF 17
SOUTH HANTINGTON TOWNSHIP			
DATE			
BY			

IMPACT PLAN
(JANUARY, 2017)



IMPACT SUMMARY TABLE

NO.	RESOURCE IMPACTED	IMPACT TYPE	LAST DATE/CONSIDER	PERMANENT IMPACT LENGTH	PERMANENT IMPACT AREA	TEMPORARY IMPACT LENGTH	TEMPORARY IMPACT AREA
28	ST-05	PERMANENT	4011 17 05 N / 7342 3 79 W	844 LF	5,682 SF	1,044 LF	6,284 SF
29	WL-02	WETLAND	4011 20 05 N / 7341 55 87 W	40 LF	5,000 SF	50 LF	2,500 SF
30	ST-09	NEW OUTFALL	4011 21 03 N / 7341 56 05 W	-	800 SF	-	2,500 SF
31	WL-05	WETLAND	4011 22 41 N / 7341 53 37 W	-	7,720 SF	-	470 SF

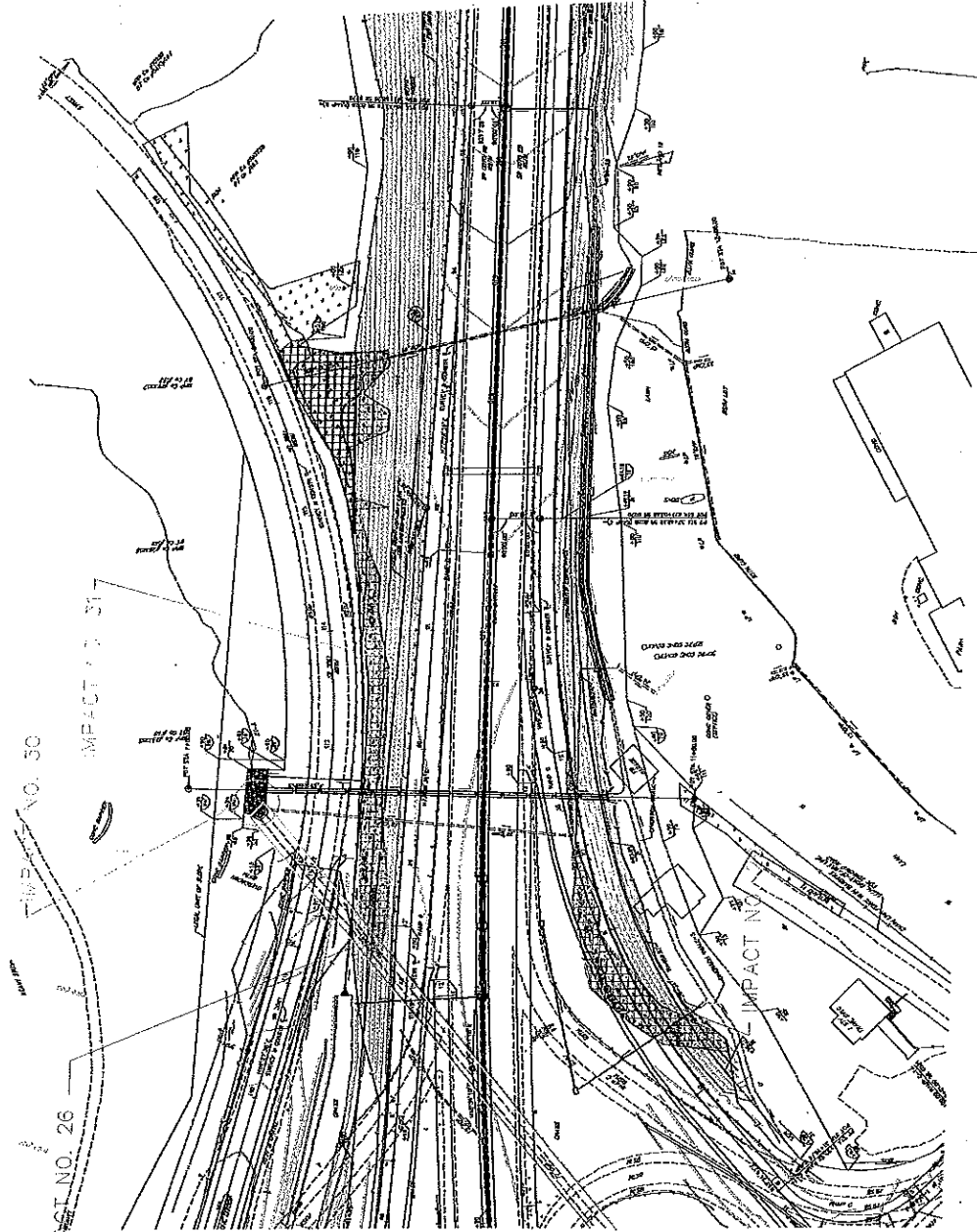

LEGEND

- F- FILL
- C- CUT
- 100 YEAR PROPOSED BACKWATER
- 100 YEAR EXISTING BACKWATER
- FILL IN FLOODPLAIN
- PERMANENT WETLAND IMPACT
- TEMPORARY WETLAND IMPACT
- RELOCATED CHANNEL

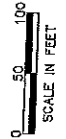

PROJECT NO.	12-01	CITY	WESTMORELAND	ROUTE	607D	SHEET	16 OF 17
TOWNSHIP	SOUTH	COUNTY	SOUTH HUNTINGTON	SECTION	TOWNSHIP		

IMPACT PLAN
(JANUARY, 2017)



IMPACT SUMMARY TABLE

NO.	RESOURCE IMPACTED	IMPACT TYPE	LATITUDE/LONGITUDE	PERMANENT IMPACT LENGTH	PERMANENT IMPACT AREA	TEMPORARY IMPACT LENGTH	TEMPORARY IMPACT AREA
32	ST-08	STREAM ST-08 IMPACTS	40°11'23.55" N / 79°41'41.31" W	244 LF	300 SF	334 LF	1,002 SF
33	ST-18	STREAM ST-18 IMPACTS	40°11'24.62" N / 79°41'44.48" W	122 LF	244 SF	147 LF	441 SF
34	NEW OUTFALL	NEW OUTFALL	40°11'25.85" N / 79°41'38.64" W	3 LF	2 SF	2 SF	2 SF
35	NEW OUTFALL	NEW OUTFALL	40°11'24.50" N / 79°41'38.13" W	2 LF	14 SF	2 SF	14 SF

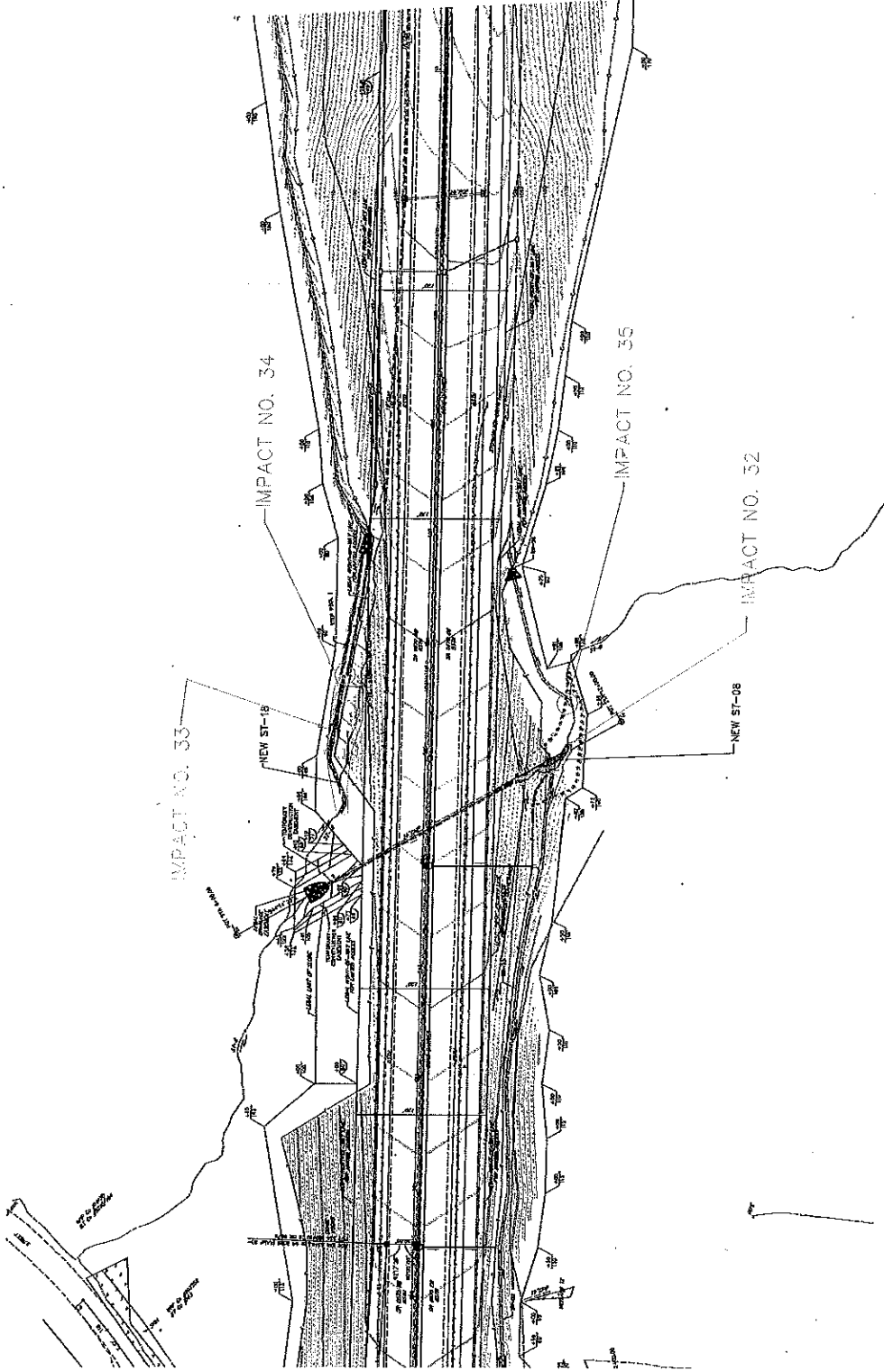

- LEGEND**
- F — FILL
 - - C - - CUT
 - ▨ 100 YEAR PROPOSED BACKWATER
 - ▨ 100 YEAR EXISTING BACKWATER
 - ▨ FILL IN FLOODPLAIN
 - ▨ PERMANENT WETLAND IMPACT
 - ▨ TEMPORARY WETLAND IMPACT
 - ▨ RELOCATED CHANNEL

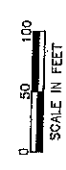

PROJECT	COUNTY	TOWNSHIP	SECTION
12-0	WESTASSELAND	0070	17 OF 17
SUBJECT	SOUTH HASTINGS TOWNSHIP		
DATE	2017		

IMPACT PLAN
(JANUARY, 2017)

IMPACT SUMMARY TABLE

NO.	RESOURCE IMPACTED	IMPACT TYPE	EASTING	NORTHING	PERMANENT IMPACT LENGTH	PERMANENT IMPACT AREA	TEMPORARY IMPACT LENGTH	TEMPORARY IMPACT AREA
36	ST-05	STREAK LOSS	4671.24	7429.5	300 LF	800 SF	310 LF	930 SF
37	ST-06	NEW OUTFALL	4671.24	7429.5	30 LF	80 SF	---	---
38	ST-18	PERMANENT IMPACTS	4671.36	7841.13	125 LF	125 SF	---	---
39	ST-04	FILL IN FLOODWAY AND IMPACTS	4671.37	7841.13	5 LF	13,288 SF	---	---
40	ST-04	NEW OUTFALL	4671.37	7841.13	70 LF	20 SF	---	---
41	ST-17	PERMANENT IMPACTS	4671.38	7841.13	70 LF	350 SF	---	---
42	ST-04	STREAK LOSS	4671.38	7841.13	70 LF	1,000 SF	---	---
43	ST-05	PERMANENT IMPACTS	4671.42	7841.13	7 LF	445 LF	---	---
44	ST-01	NEW OUTFALL	4671.42	7841.13	83 LF	45 SF	---	---
45	W-14	WETLAND IMPACTS W-14	4671.36	7841.12	405 LF	810 SF	---	---
46	ST-03	PERMANENT IMPACTS	4671.36	7841.12	---	---	---	---
47	W-13	WETLAND IMPACTS W-13	4671.36	7841.12	---	---	---	1157 SF

