

Notes:
 1. Background is 2019 Marshall County, WV aerial image.
 2. Potentially Jurisdictional Waters were delineated by AllStar Ecology LLC on June 28, 2018, January and September of 2019 and March 19, May 20, May 26, May 29, and June 16 of 2020.
 3. According to FEMA Firm Map 54051C0200E and 54051C0175E with an effective date of September 25, 2009 no portion of the site is located within a flood hazard area.

S16 (Laurel Run) (Albright Facility)
 107 LF of temporary impact
 39.828226°, -80.632499°

ASE_Stream 01 (Breckenridge Pad)
 67 LF of temporary impact
 39.829260°, -80.628026°

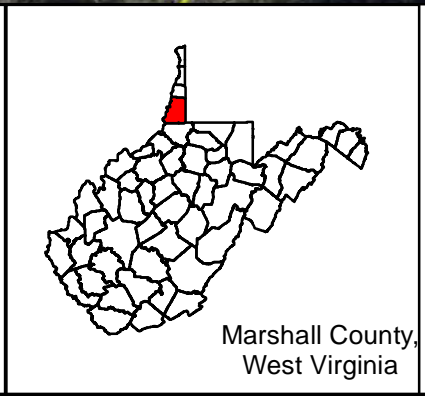
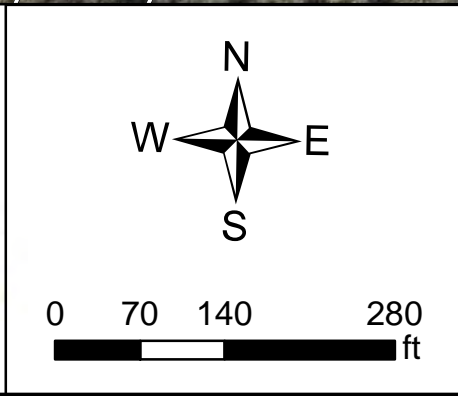

AOI	EPHEMERAL	DATA POINT (DP)	FLOW DIRECTION
LOD	INTERMITTENT	CATTLE TROUGH	FEATURE CONTINUES
PEM	PERENNIAL	SEEP	
PSS	EXISTING CULVERT	WATER WELL	
TEMPORARY IMPACT			

XcL Midstream Operating, LLC

Attachment B
 Impact Map
 Tollway Pipeline Phase II Option 2

Date: 06/18/2020 Sheet 1