



**U.S. Army Corps  
of Engineers**  
Pittsburgh District

# Public Notice

In Reply Refer to  
Notice No. below

US Army Corps of Engineers, Pittsburgh District  
1000 Liberty Avenue  
Pittsburgh, PA 15222-4186

Date: June 28, 2018

Notice No. CELRP-RG-18-LOP1

Expiration Date: June 28, 2023

## **LETTER OF PERMISSION FOR CONSTRUCTION OF RECREATIONAL BOAT DOCKS WITHIN THE COMMONWEALTH OF PENNSYLVANIA**

1. **TO ALL WHOM IT MAY CONCERN:** In accordance with Title 33 CFR 325.2 (e) (1)(i) the Corps of Engineers, Pittsburgh, is issuing this Public Notice for the construction and maintenance of recreational boat docks in navigable waters, within the Pittsburgh District portion of the Commonwealth of Pennsylvania. Structures authorized under this Letter of Permission are limited to those used by individual landowners or their assignees for non-commercial purposes.
2. The Letter of Permission provided for in this Public Notice may be revoked at any time after its effective date if it is determined that the cumulative effects of the activities authorized thereby will have a significant adverse environmental impact or that any such activity is otherwise not in the public interest.
3. The boat docks covered by this Letter of Permission must comply with the Special Conditions set forth in Appendix A.
4. For use of this Letter of Permission on Lake Erie, the applicant must obtain a Coastal Zone Consistency determination. This may be done on an individual basis for the specific project; however, it is recommended that this be accomplished by registering a Pennsylvania Department of Environmental Protection General Permit No. 2 with the County Conservation District.
5. The provisions of this Letter of Permission would not apply to:
  - a. Historic, cultural or archeological sites as identified in the latest published version of the National Register of Historic Places.
  - b. Sites included in the latest published version of the National Registry of Natural Landmarks.
  - c. Sites within the National Wild and Scenic Rivers Corridor unless the United States Forest Service has approved the dock and a Pennsylvania Department of Environmental Protection General Permit No. 2 has been recorded with the appropriate County Conservation District or Pennsylvania Department of Environmental Protection Regional Office.

CELRP-RG  
Public Notice No. 18-LOP1

- d. Wetland sites.
- e. Sites that may be identified by the District Engineer as being environmentally sensitive.

6. Nothing in this Letter of Permission would eliminate the necessity for the owner(s) to obtain any required State or local permits.

7. The owner(s) must furnish to the District Engineer prior to commencement of construction, a letter describing the proposed activity so that the number and locations of the structures may be properly inventoried and the cumulative effect of the same may, from time to time, be assessed. The submittal must include the following information:

- a. Name, address, and phone number of owner(s).
- b. Location of the proposed work to include name of waterway and mile number, State, county, and nearest city or town.
- c. Names and addresses of adjoining upstream and downstream property owners.
- d. The intended use of the structure (i.e. private individual or private group).
- e. Dates when work is expected to begin and end.
- f. A vicinity map of the project location with latitude and longitude shown. The project location may be shown on a copy of the appropriate page of River Navigation Charts published by the U. S. Army Corps of Engineers, Pittsburgh District, or an applicable segment of U.S.G.S. topographic map, county or other commercially available map. (See Appendix A.)
- g. A plan and profile view drawing. The sketched plan view drawing should show the dimensions of the work, the structure referenced to a readily identifiable, fixed object on shore, the normal pool shoreline and the direction of the water's flow at the work site. The profile view drawing should show the work in relation to normal pool elevation and show types of dock materials being used. (See Appendix A.)

8. Upon receipt of the owner(s) notification, the District Engineer, U.S. Army Engineer District, Pittsburgh, will consult the latest published version of the National Register of Historic Places for the presence or absence of registered properties or properties listed in the latest

published version of the Register as being eligible for inclusion therein. If presently unknown archeological, scientific, prehistorical or historical data is discovered during the prosecution of the work, further work shall cease and the owner(s) shall inform the District Engineer of such discovery.

9. This Letter of Permission, unless specifically modified, suspended, or revoked, will be in effect for a period of five years from the date of issuance and may be considered for revalidation at that time.
10. The conditions and requirements of this Letter of Permission are attached to this Public Notice.
11. Comments may be submitted or further information may be obtained at the following location:

U. S. ARMY CORPS OF ENGINEERS  
PITTSBURGH DISTRICT  
REGULATORY DIVISION  
WILLIAM S. MOORHEAD FEDERAL BUILDING 22<sup>nd</sup> Floor  
1000 LIBERTY AVENUE  
PITTSBURGH, PENNSYLVANIA 15222-4186  
PHONE: 412-395-7155

BY AUTHORITY OF THE SECRETARY OF THE ARMY:

*/signed/*

Scott A. Hans  
Chief, Regulatory Division

Enclosure  
Appendix A

**DEPARTMENT OF THE ARMY  
LETTER OF PERMISSION AUTHORIZING RECREATIONAL BOAT DOCKS**

**APPENDIX A  
SPECIAL CONDITIONS**

- a. The dock owner's name and the Corps of Engineers Permit Number must be permanently displayed on each dock section.
- b. Authorized work will consist of the placement of floating, cantilever or pile supplied noncommercial, recreational docks. These structures will be constructed of wood and/or metal and will be secured by anchors, cables, piles, posts, spuds, or any combination thereof which will ensure the structure's ability to withstand the effects of wind, flowing water, and wave action.
- c. Wood materials used in the construction will be treated to retard rotting and decomposition prior to being placed in or over the waterway.
- d. Flotation devices, if used, will be of Styrofoam, plastic, fiberglass, or metal and will be securely fastened to the structure to prevent separation from the dock.
- e. Metal drums that have previously been filled with another substance will be thoroughly cleaned before use as flotation devices to preclude seepage.
- f. Floating docks shall not be anchored to trees. Shoreline cables/anchorages shall be placed so they do not accelerate erosion by unnecessarily degrading or disturbing stream banks.
- g. The dock may be straight, "T", "I.", or other functional shape (in plan) not exceeding 75 feet in total length of all segments. The dock may have a maximum width of eight feet.
- h. The river face of the dock shall not extend riverward more than 50 feet from the established normal pool elevation at the structure's location, and in no instance greater than 1/4 of the width of the waterway nor be closer than 10 feet from the adjacent property boundaries.
- i. The placement of recreational docks will not be permitted within the zone marked by the "Arrival Points" (upper and lower lock approach areas) which are located both upstream and downstream of all navigation locks between Miles 0.0 and 62.4, Allegheny River, Miles 0.0 and 90.9, Monongahela River, and Miles 0.0 and 31.9, Ohio River. Arrival points are clearly

indicated by large signs lettered "Arrival Point" along the lock side riverbank at each navigation lock and dam. No recreational dock will be permitted within the danger zone above and below the navigation dams within the aforementioned reaches of the Allegheny, Monongahela, and Ohio Rivers. These zones are marked both above and below each dam on the abutment side (opposite the lock chamber) with warning signs labeled "Danger Dam." During the summer boating season these danger zones are marked with white pillar buoys placed across the river.

j. Only one structure may be constructed on a given riparian parcel under the terms of this Letter of Permission and such structure must be for the private use of the owner(s). (Note: Applications for larger size private or all size commercial docks will be processed under standard permit procedures which require individual applications to be submitted to the District Engineer on Engineer Form 4345. The Instructions for Preparing a Department of the Army Permit Application are helpful in the completion of the application.)

k. A fuel pump, fuel storage, or other related facilities on the dock will not be authorized under this Letter of Permission.

l. Dredging will not be authorized under this Letter of Permission.

m. The placement of fill, bank protection, or other discharges into the waterway will not be permitted in connection with the activity under this Letter of Permission.

n. The permittee shall allow the District Engineer or his authorized representative(s) or designee(s) to make periodic inspections at any time determined necessary to assure that the activity authorized under this Letter of Permission is in accordance with the terms and conditions prescribed herein.

o. If, upon inspection, an activity authorized by this Letter of Permission is not being constructed or has not been constructed or is not being maintained at a particular location in accordance with these conditions or to the satisfaction of the District Engineer, the authorization of the activity at such location may be revoked and an individual application for the work at such location may be required.

p. This Letter of Permission does not convey any property rights, either in real estate or material or any exclusive privileges; and it does not authorize any injury to property or invasion of rights or any infringement of Federal, state, or local laws or regulations, nor does it obviate the requirement to obtain state or local assent required by law for the activity authorized herein.

q. This Letter of Permission does not authorize the interference with any existing or proposed Federal project and the permittee shall not be entitled to compensation for damage or injury to the structures or work authorized herein which may be caused by or result from existing

or future operations undertaken by the United States in the public interest.

r. If and when the permittee proposes to abandon or remove any facility constructed under this Letter of Permission, he must submit plans to the District Engineer for restoration of the area to a condition satisfactory to the District Engineer.

s. Violations of the terms and conditions of this Letter of Permission may result in the institution of such legal proceedings as the United States Government may consider appropriate.



US Army Corps  
of Engineers  
Pittsburgh District  
1000 Liberty Avenue  
Pittsburgh, PA 15222-4186

Adjacent Properties

Lot 1  
Charles Smith  
1234 River Road  
Curtown, PA 15320

Lot 2  
Samuel Jones  
1238 River Road  
Curtown, PA 15320

Lot 3  
Samuel Jones  
1238 River Road  
Curtown, PA 15320

Project Title

Proposed  
Curtown Dock  
Green County  
Pennsylvania

Applicant

John Doe  
1000 Second Avenue  
Curtown, PA 15320

Drawing Number

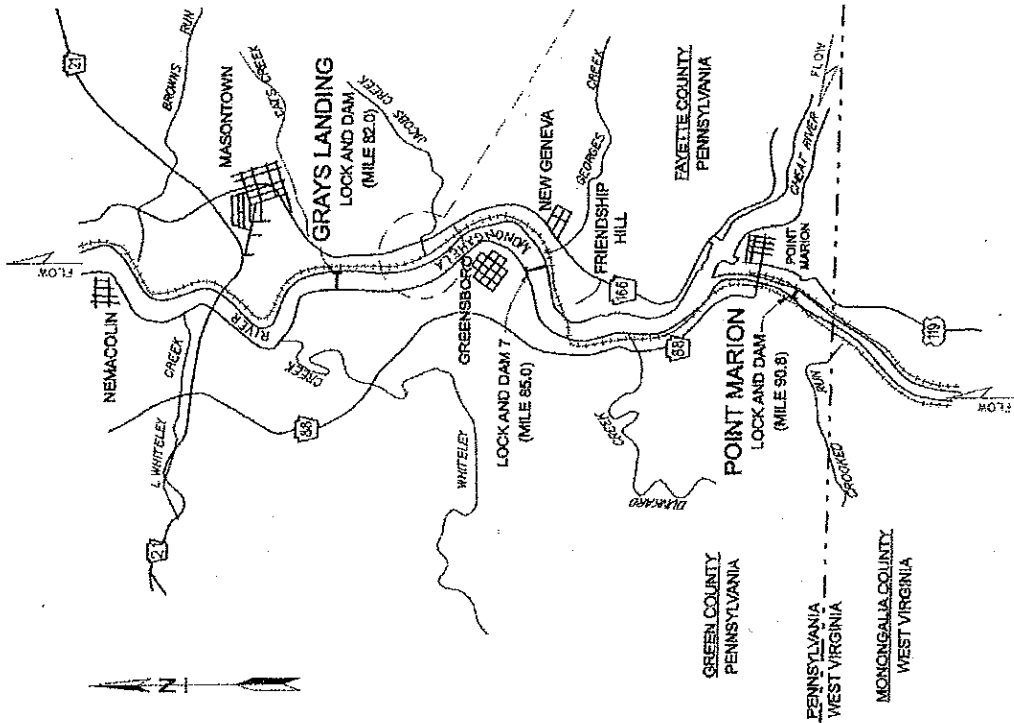
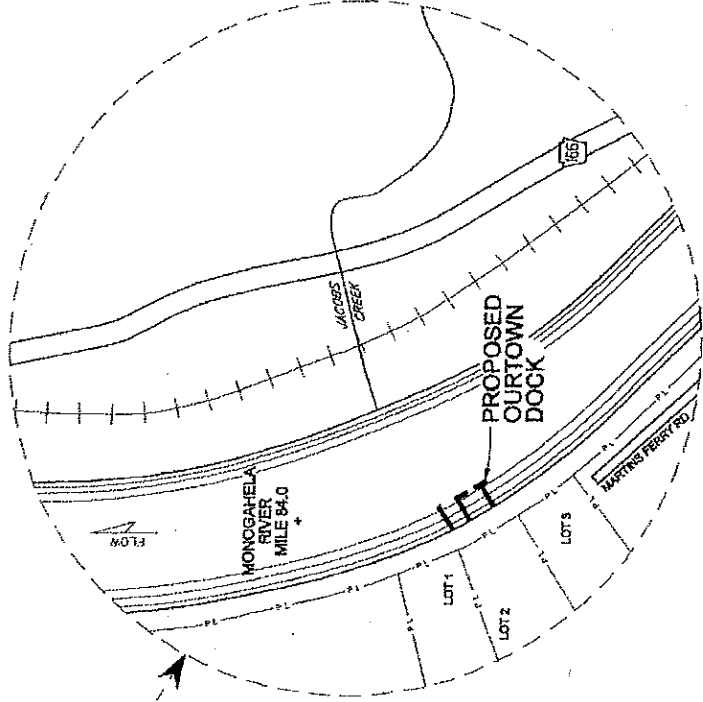
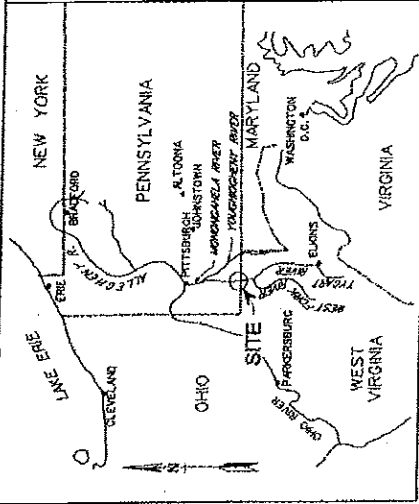



US Army Corps  
of Engineers  
Pittsburgh District  
1000 Liberty Avenue  
Pittsburgh, PA 15226-4186

Adjacent Properties

Lot 1  
Charles Smith  
1234 River Road  
OurTown, PA 15320

Lot 2  
Samuel Jones  
1236 River Road  
OurTown, PA 15320

Lot 3  
Samuel Jones  
1238 River Road  
OurTown, PA 15320

Project Title

Proposed  
OurTown Dock  
Green County  
Pennsylvania

Applicant

John Doe  
1000 Second Avenue  
OurTown, PA 15320

Drawing Number

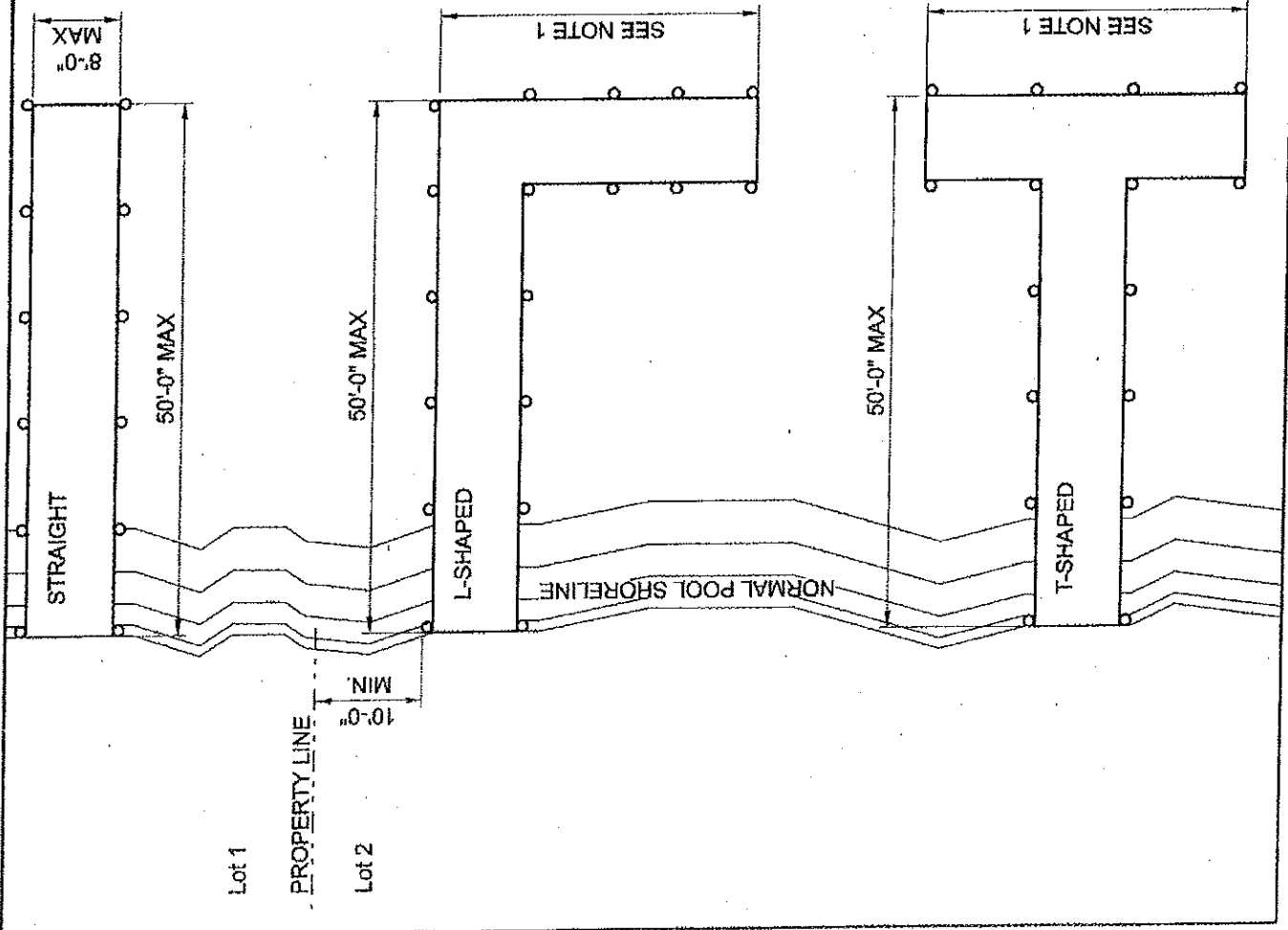

NOTE:  
1. TOTAL LENGTH OF ALL DOCK SEGMENTS NOT TO EXCEED 75 FEET.

**PLAN**  
**TYPICAL PILE DOCK CONFIGURATIONS**  
NOT TO SCALE





US Army Corps  
of Engineers  
Pittsburgh District  
1000 Liberty Avenue  
Pittsburgh, PA 15224-1188

Aligned Properties:

Lot 1  
Charles Smith  
1234 River Road  
OurTown, PA 15320

Lot 2  
Samuel Jones  
1236 River Road  
OurTown, PA 15320

Lot 3  
Samuel Jones  
1238 River Road  
OurTown, PA 15320

Project File:

Proposed  
OurTown Dock  
Green County  
Pennsylvania

Agency:

John Doe  
1000 Second Avenue  
OurTown, PA 15320

Drawing Number:

50'-0" MAX

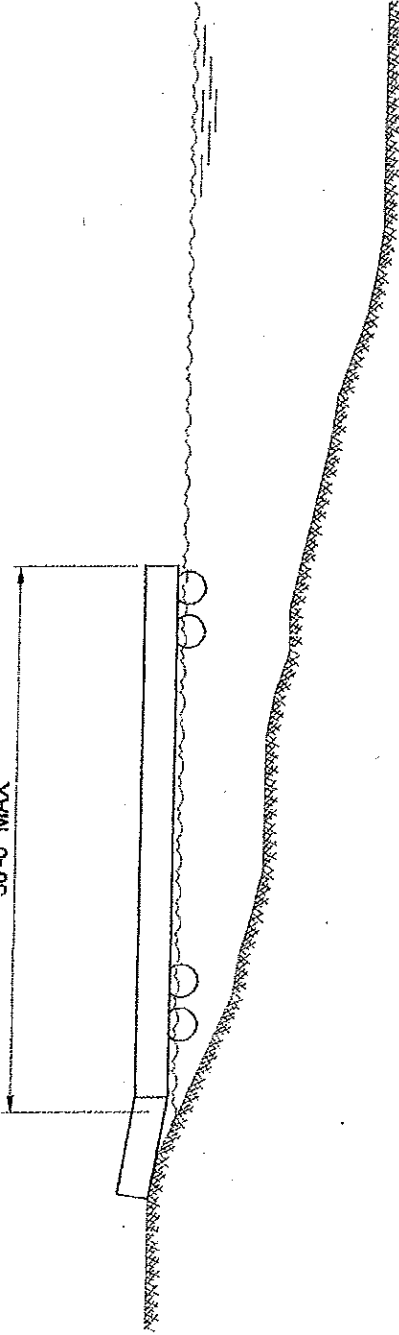

**ELEVATION**  
**TYPICAL FLOATING DOCK**  
NOT TO SCALE



US Army Corps  
of Engineers  
Pittsburgh District  
1000 Liberty Avenue  
Pittsburgh, PA 15222-4186

Adjacent Properties:

Lot 1  
Charles Smith  
1234 River Road  
OurTown, PA 15320

Lot 2  
Samuel Jones  
1236 River Road  
OurTown, PA 15320

Lot 3  
Samuel Jones  
1238 River Road  
OurTown, PA 15320

Project Title:

Proposed  
OurTown Dock  
Green County  
Pennsylvania

Project:

John Doe  
1000 Second Avenue  
OurTown, PA 15320

Sheet number:

50'-0" MAX

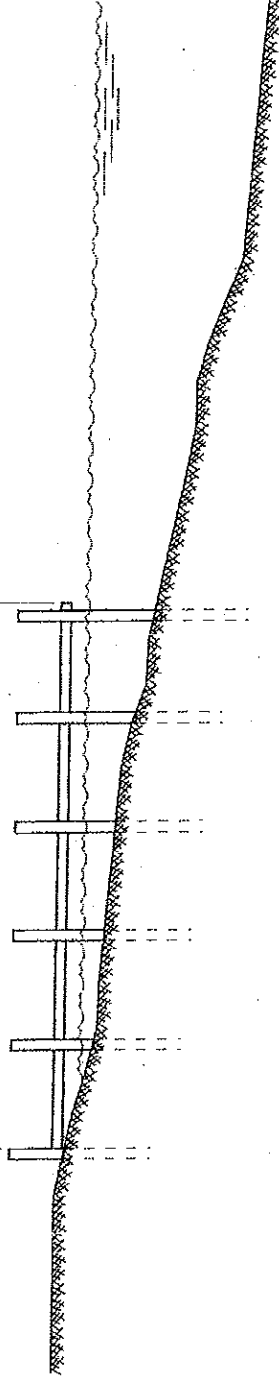

**ELEVATION**  
**TYPICAL PILE DOCK**  
NOT TO SCALE