



### LAND USE SUMMARY TABLE

LAND USE	ACRES	DENSITY (du/ac.)	DU
<b>Residential</b>			
LDR Low Density Residential	141.0	5.0	705
MDR Medium Density Residential	79.4	8.0	635
HDR High Density Residential	24.9	25.0	689
<b>sub-total</b>	<b>245.3</b>		
<b>Commercial</b>			
CC Community Commercial	36.5		
CC (CMU) Commercial Mixed Use	6.2		
<b>sub-total</b>	<b>42.7</b>		
<b>Public Quasi Public - P/QP</b>			
P/QP Elementary School	10.0		
P/QP Well Site	0.3		
P/QP Lift Station	0.8		
<b>sub-total</b>	<b>11.1</b>		
PR Park (3)	15.5		
OS Open Space	36.6		
OS Landscape Corridor/Paseo	11.3		
OS Major Roads	34.9		
<b>sub-total</b>	<b>98.3</b>		
<b>Total Project Area</b>	<b>397.4±</b>		<b>2029 du</b>

(A) Denotes Affordable Housing Site



NORTH

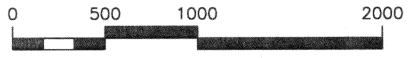
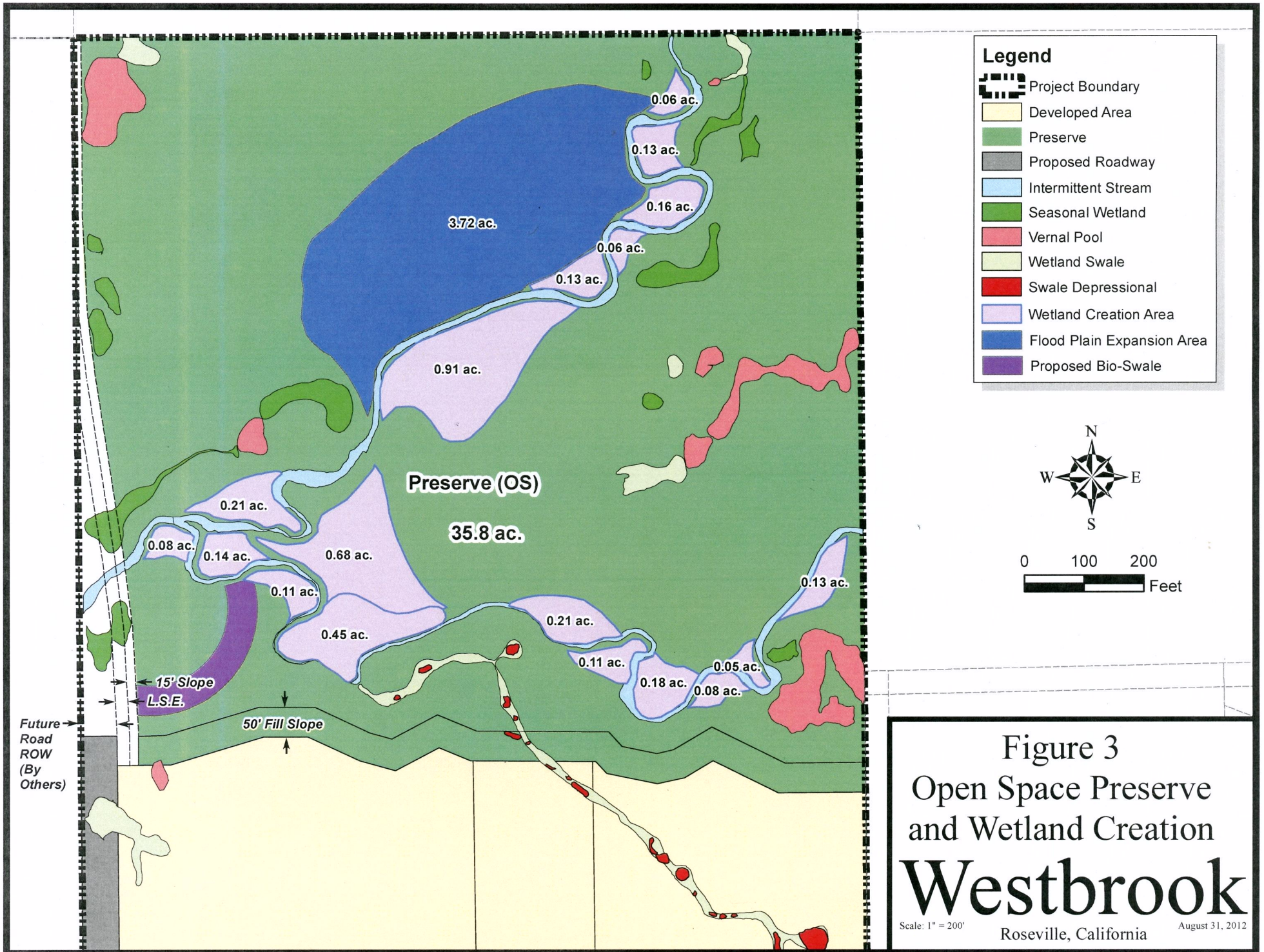

Figure 2  
Project Map

# Westbrook

Scale: 1" = 1000' Roseville, California June 20, 2012



Preserve (OS)

35.8 ac.

3.72 ac.

0.06 ac.

0.13 ac.

0.16 ac.

0.06 ac.

0.13 ac.

0.91 ac.

0.21 ac.

0.08 ac.

0.14 ac.

0.68 ac.

0.11 ac.

0.45 ac.

0.21 ac.

0.11 ac.

0.18 ac.

0.05 ac.

0.08 ac.

0.13 ac.

15' Slope

L.S.E.

50' Fill Slope

Future Road ROW (By Others)

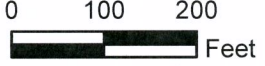

**Figure 3**  
**Open Space Preserve**  
**and Wetland Creation**  
**Westbrook**  
 Roseville, California August 31, 2012

Scale: 1" = 200'

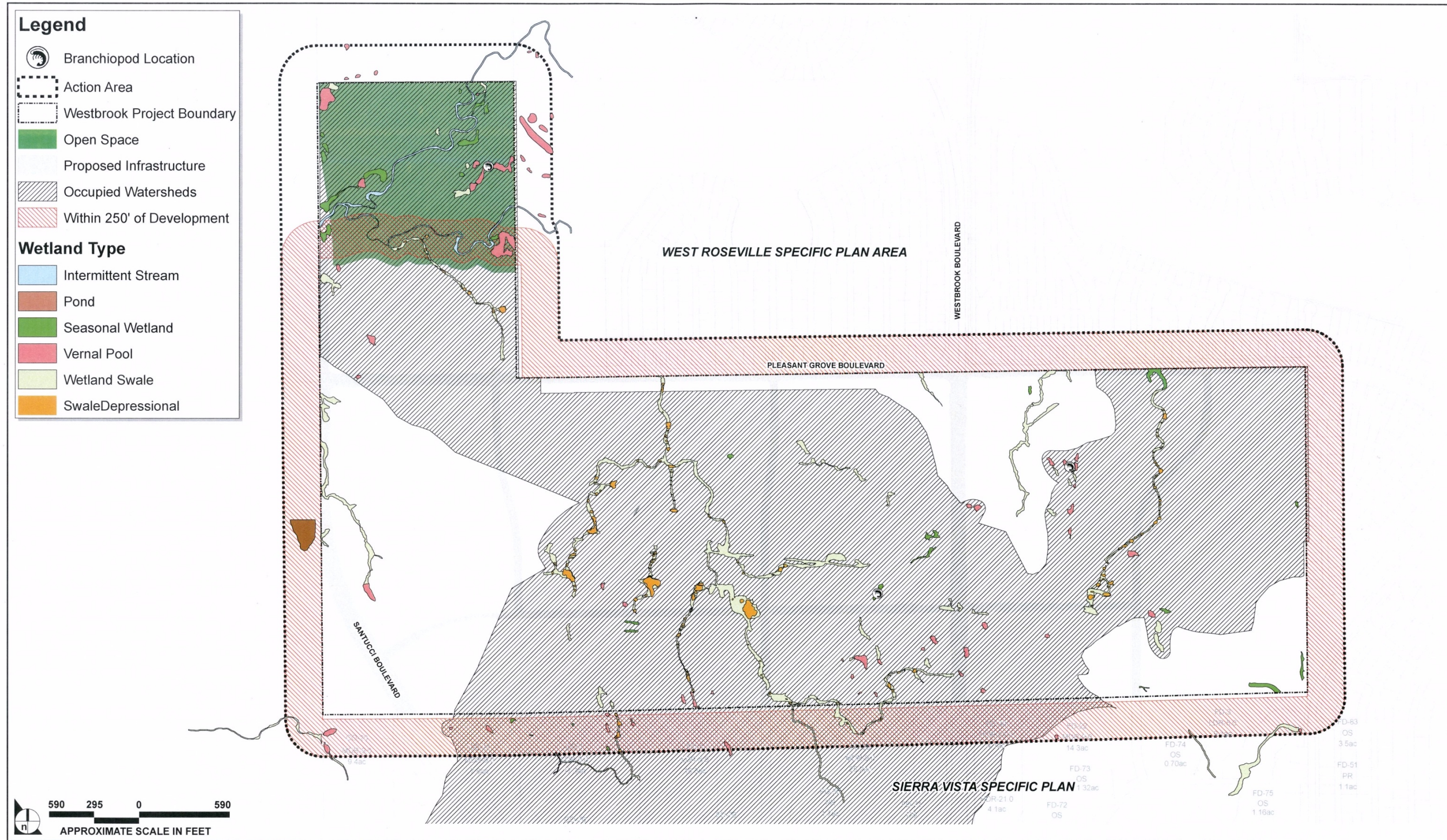

Project Site Jurisdictional Wetlands and Watersheds

Figure 4; SPK-2005-00938