

### LAND USE SUMMARY TABLE

LAND USE	ACRES	DENSITY (du/ac.)	DU
<b>Residential</b>			
LDR Low Density Residential	141.0	5.0	705
MDR Medium Density Residential	79.4	8.0	635
HDR High Density Residential	24.9	25.0	689
sub-total	245.3		
<b>Commercial</b>			
CC Community Commercial	36.5		
CC (CMU) Commercial Mixed Use	6.2		
sub-total	42.7		
<b>Public Quasi Public - P/QP</b>			
P/QP Elementary School	10.0		
P/QP Well Site	0.3		
P/QP Lift Station	0.8		
sub-total	11.1		
PR Park (3)	15.5		
OS Open Space	36.6		
OS Landscape Corridor/Paseo	11.3		
OS Major Roads	34.9		
sub-total	98.3		
<b>Total Project Area</b>	<b>397.4±</b>		<b>2029 du</b>

(A) Denotes Affordable Housing Site



NORTH



Figure 2  
Project Map

# Westbroom

Scale: 1" = 1000' Roseville, California June 20, 2012



**Legend**

- Project Boundary
- Developed Area
- Preserve
- Proposed Roadway
- Intermittent Stream
- Seasonal Wetland
- Vernal Pool
- Wetland Swale

Note: Seasonal Wetland not included in Preserved acreage. (0.1336 ac.)

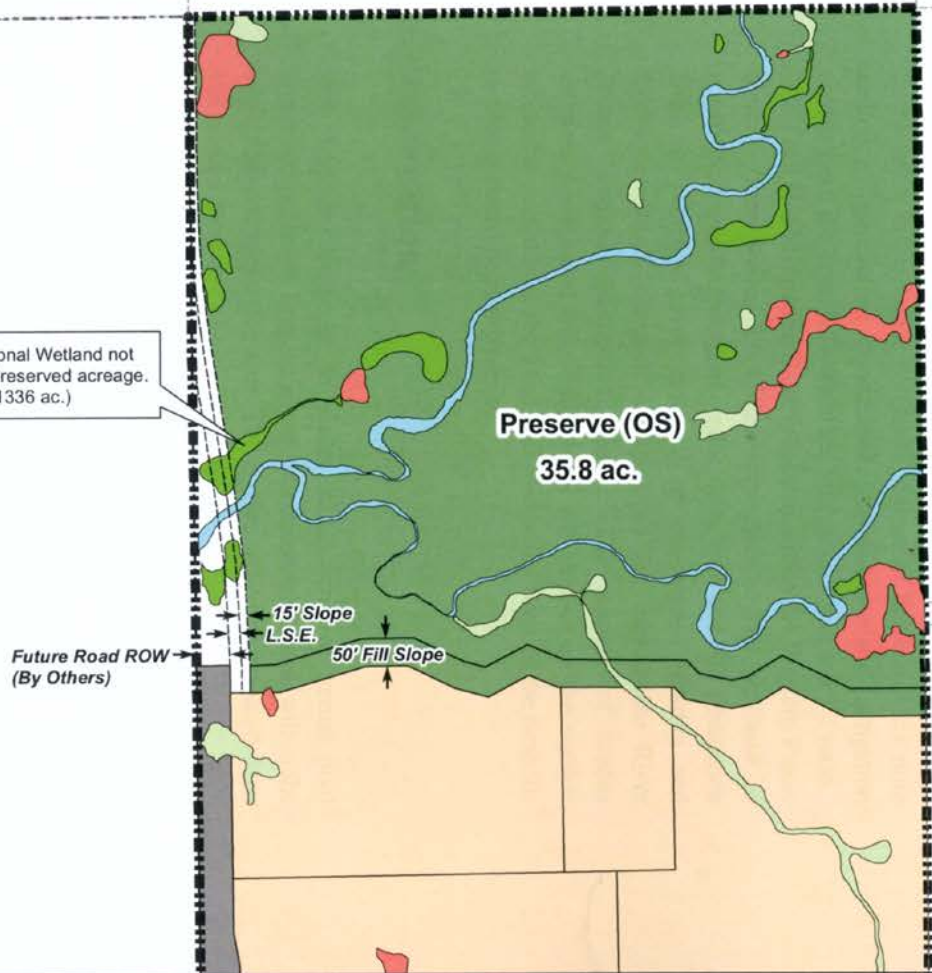

**Figure 3**

# Open Space Preserve Westbrook

Scale: 1" = 300'

September 5, 2012  
Revised: August 22, 2013

Roseville, California

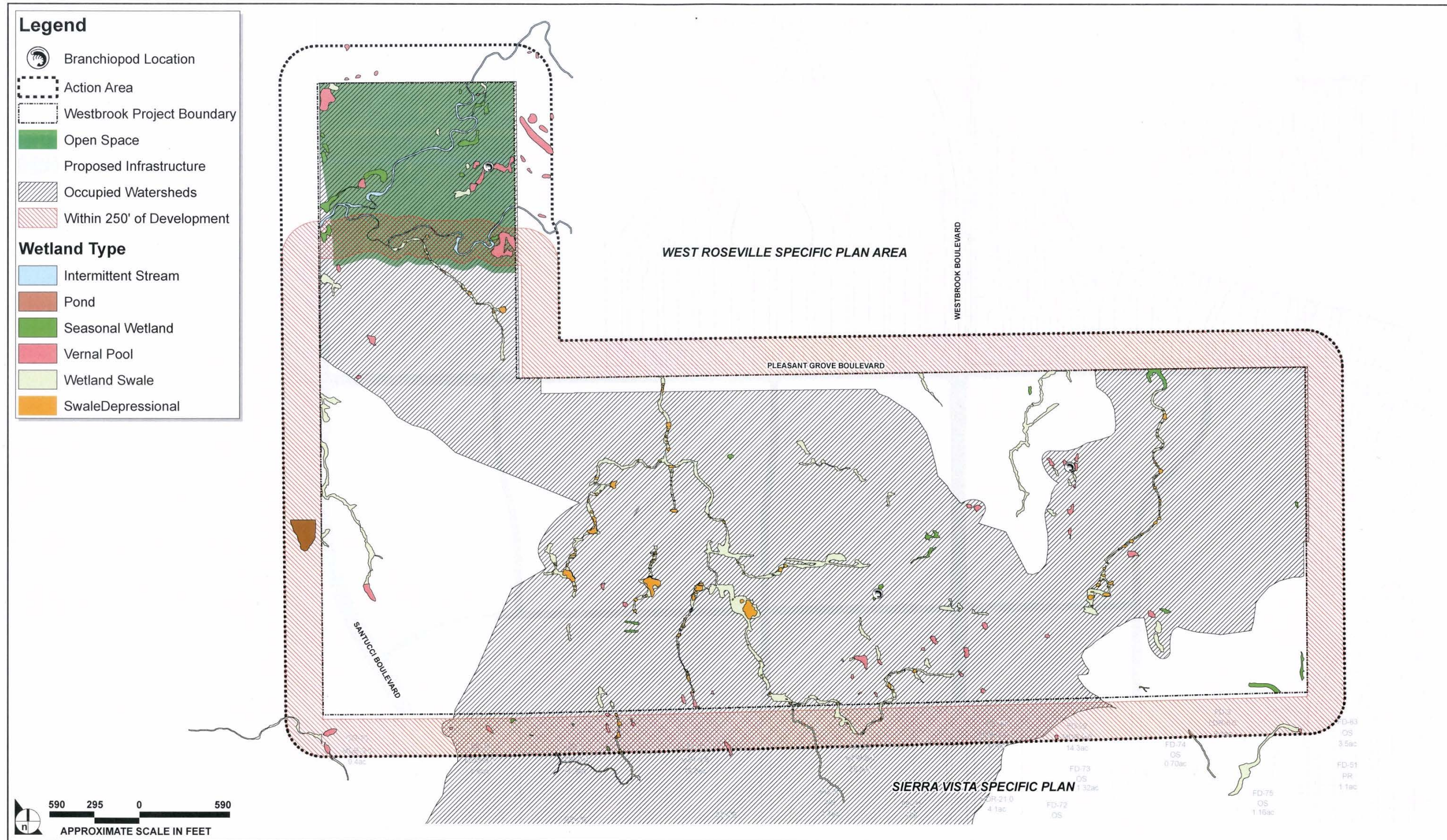

SOURCE: Gibson & Skordal LLC., September 19, 2012

Project Site Jurisdictional Wetlands and Watersheds

Figure 4; SPK-2005-00938