

# **PUBLIC NOTICE**

## **REQUEST FOR PERMISSION TO ALTER A U.S. ARMY CORPS OF ENGINEERS PROJECT UNDER SECTION 408**

**TITLE:** Bay Head Preservation Alliance – Rock Encasement of Existing Timber Groin Structures at the Atlantic Ocean located within the Manasquan Inlet to Barnegat Inlet Coastal Storm Risk Management Federal Civil Works Project.

**PUBLIC NOTICE IDENTIFICATION NUMBER:** NAP-2006-06337-95

### **PUBLIC NOTICE COMMENT PERIOD:**

Begins: **04 January 2022**

Expires: **03 February 2022**

Interested parties are hereby notified that an application has been received for a Department of the Army Section 408 permission for certain work at or near a federal project of the United States, as described below and shown on attached figures. Written comments are being solicited from anyone having an interest in the requested alteration. Comments will become part of the U.S. Army Corps of Engineers' (USACE's) administrative record and will be considered in determining whether to approve the request. Comments supporting, opposing, or identifying concerns that should be considered by the USACE in its decision process are all welcome.

This public notice is not a paid advertisement and is for public information only. Issuance of this notice does not imply USACE endorsement of the project as described.

**1. REQUESTER:** In compliance with 33 USC 408 (Section 14 of the Rivers and Harbors Act of 1899; hereinafter Section 408), the Bay Head Preservation Alliance has requested permission to encase five (5) existing timber groin structures with rock, sited within the Manasquan Inlet to Barnegat Inlet Coastal Storm Risk Management Federal Civil Works Project.

**2. LOCATION:** The proposed project is located along the Atlantic Ocean-front beach between Osborne Avenue and Chadwick Street in the Borough of Bay Head, Ocean County, New Jersey (approximate northern limit: 40.075387, Longitude: -74.040602; approximate southern limit: 40.065877, Longitude: -74.042448).

**3. LOCATION MAP(S)/DRAWING(S):** Please see attached Project Plans E-1 and E-2.

**4. REQUESTER'S PROPOSED ACTION:** Proposed encasement of five (5) existing timber groin structures on the Atlantic Ocean-front beach with rock (Groins 1, 2, 3, 5 and 6; Groin 4 is already encased in rock from a previous authorization).

The stated purpose of the project is to restore the functionality of the groin structures and to eliminate hazards associated with their ongoing deterioration. The applicant anticipates that the groin structures will intermittently be buried and exposed by the Federal Project.

**5. REGULATORY AUTHORITY:** This request will be reviewed according to the provisions of Section 14 of the Rivers and Harbors Act of 1899 (33 U.S.C. 408). A requestor has the responsibility to acquire all other permissions or authorizations required by federal, state, and local laws or regulations, including any required permits from the USACE Regulatory Program under Section 10 of the Rivers and Harbors Act of 1899 (33 USC 403), Section 404 of the Clean Water Act (33 USC Section 1344) and/or Section 103 of the Marine Protection, Research and Sanctuaries Act of 1972 (33 USC 1413). Any Section 10/404/103 permit decision associated with the proposed alteration is separate from and will not be included in the Section 408 permission decision. An approval under Section 408 does not grant any property rights or exclusive privileges nor does it authorize any injury to the property or rights of others.

**6. ENVIRONMENTAL COMPLIANCE:** A decision on a Section 408 request is a federal action, and therefore subject to the National Environmental Policy Act (NEPA) and other environmental compliance requirements. While ensuring compliance is the responsibility of USACE, the requester is providing all information that the Philadelphia District identifies as necessary to satisfy all applicable federal laws, executive orders, regulations, policies, and ordinances. Based on information provided by the applicant to date, current Corps regulations governing NEPA implementation, and/or the contents of existing NEPA documentation if available, it is likely that the proposed action will be determined to be categorically excluded from the need to prepare an Environmental Assessment (EA) or Environmental Impact Statement (EIS). This determination will be finalized following completion of agency coordination and prior to issuance of the Section 408 Permission Decision.

**7. EVALUATION:** As part of its evaluation, USACE will first make a determination that the submittal from the requestor is complete. The Philadelphia District is working closely with the requestor to ensure that all required technical plans, maps, drawings, and specifications are provided and are complete. Once the package is complete, a District-led review will be conducted to determine, in accordance with Engineering Circular (EC) 1165-2-216, whether the proposed alteration will impair the usefulness of the USACE Project or be injurious to the public interest, as follows:

- A. *Impair the Usefulness of the Project Determination.* The Philadelphia District's Section 408 review team will determine if the proposed alteration will limit the ability of the federally authorized project to function as authorized, or will compromise or change any authorized project conditions, purposes or outputs.
- B. *Injurious to the Public Interest Determination.* Proposed alterations will be reviewed to determine the probable impacts, including cumulative impacts, on the public interest. Evaluation of the probable impacts that the proposed alteration to the USACE project may have on the public interest requires a careful weighing of all those factors that are relevant in each particular case. Factors that may be relevant to the public interest depend upon the type of USACE project being altered

and may include, but are not limited to, such things as conservation, economic development, historic properties, cultural resources, environmental impacts, water supply, water quality, flood hazards, floodplains, residual risk, induced damages, navigation, shore erosion or accretion, and recreation. The decision whether to approve an alteration will be determined by the consideration of whether benefits are commensurate with risks. If the potential detriments are found to outweigh the potential benefits, then it may be determined that the proposed alteration is injurious to the public interest.

**8. SOLICITATION OF COMMENTS:** The USACE is soliciting comments from the public; federal, state, and local agencies and officials; Indian Tribes; and other interested parties in order to consider and evaluate the impacts of the proposed activity. Any comments received will be considered by USACE to determine whether to issue, modify, condition, or deny a permission for this proposal. To make this decision, comments are used to assess impacts on endangered species, historic properties, water quality, general environmental effects, and other public interest factors listed above. Comments are considered in making a final determination whether the proposed action will be categorically excluded from the need to prepare further NEPA documentation. Comments are also used to determine the need for a public hearing and to determine the overall public interest of the proposed activity.

- A. It should be noted that materials submitted as part of the Section 408 request become part of the public record and are thus available to the general public under the procedures of the Freedom of Information Act (FOIA). Individuals may submit a written request to the Philadelphia District Corps of Engineers, Office of Counsel to obtain copies of said materials under the FOIA.
- B. It is presumed that all parties viewing this notice will wish to respond to this public notice; therefore, a lack of response will be interpreted as meaning that there is no objection to the project as described.

**9. COMMENT SUBMISSION AND ADDITIONAL INFORMATION:** Written comments on the described work should reference the USACE Public Notice Identification Number found on the first page of this notice. Comments must reach this office no later than the stated expiration date of the Public Notice to become part of the record and be considered in the decision. Comments or requests for additional information should be mailed or emailed to the following address:

Email: [JuanCarlos.Corona@usace.army.mil](mailto:JuanCarlos.Corona@usace.army.mil)

Mailing Address:

U.S. Army Corps of Engineers

Philadelphia District

ATTN: Juan Carlos Corona

7<sup>th</sup> Floor

100 Penn Square East

Philadelphia, PA 19107-3390

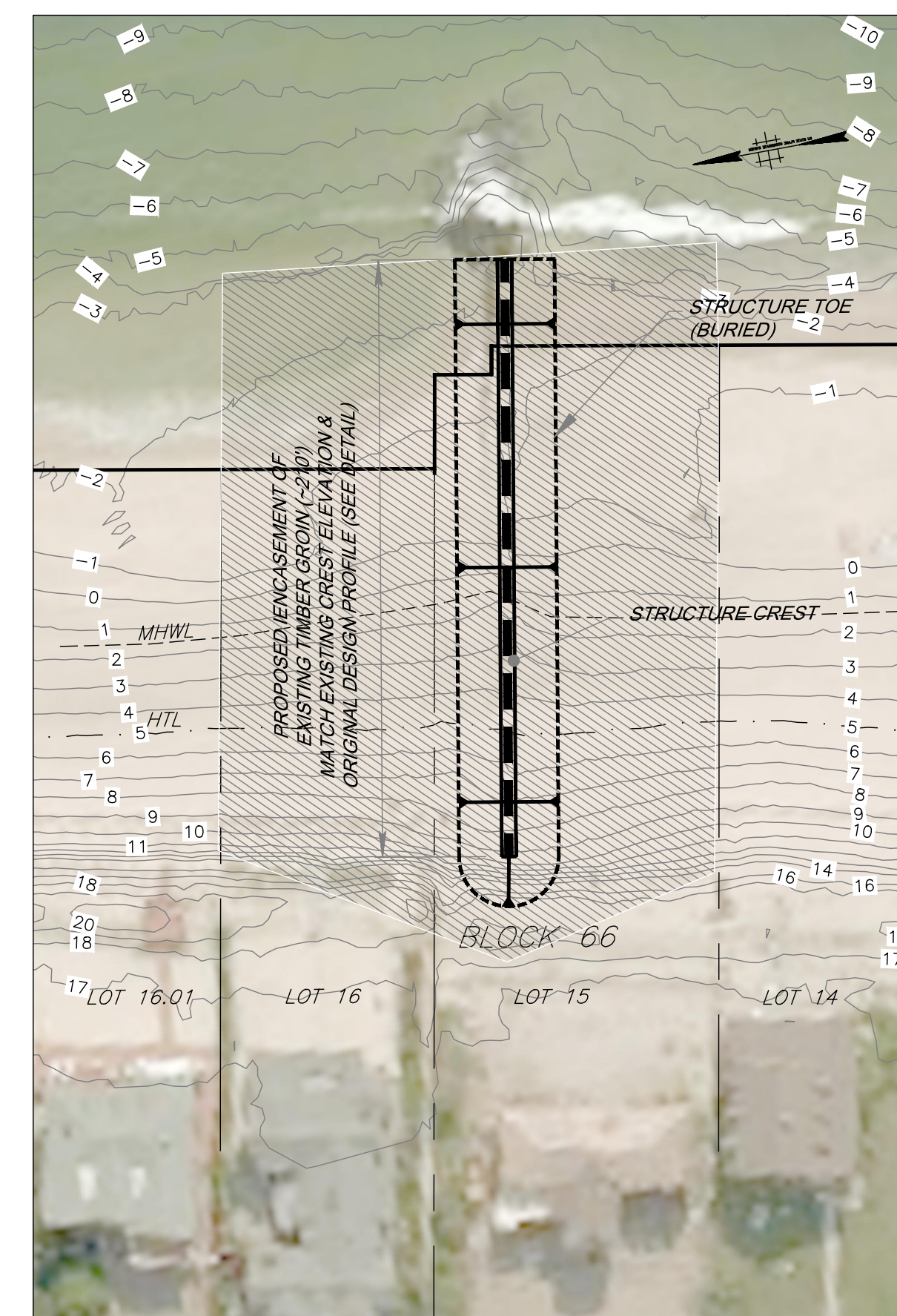
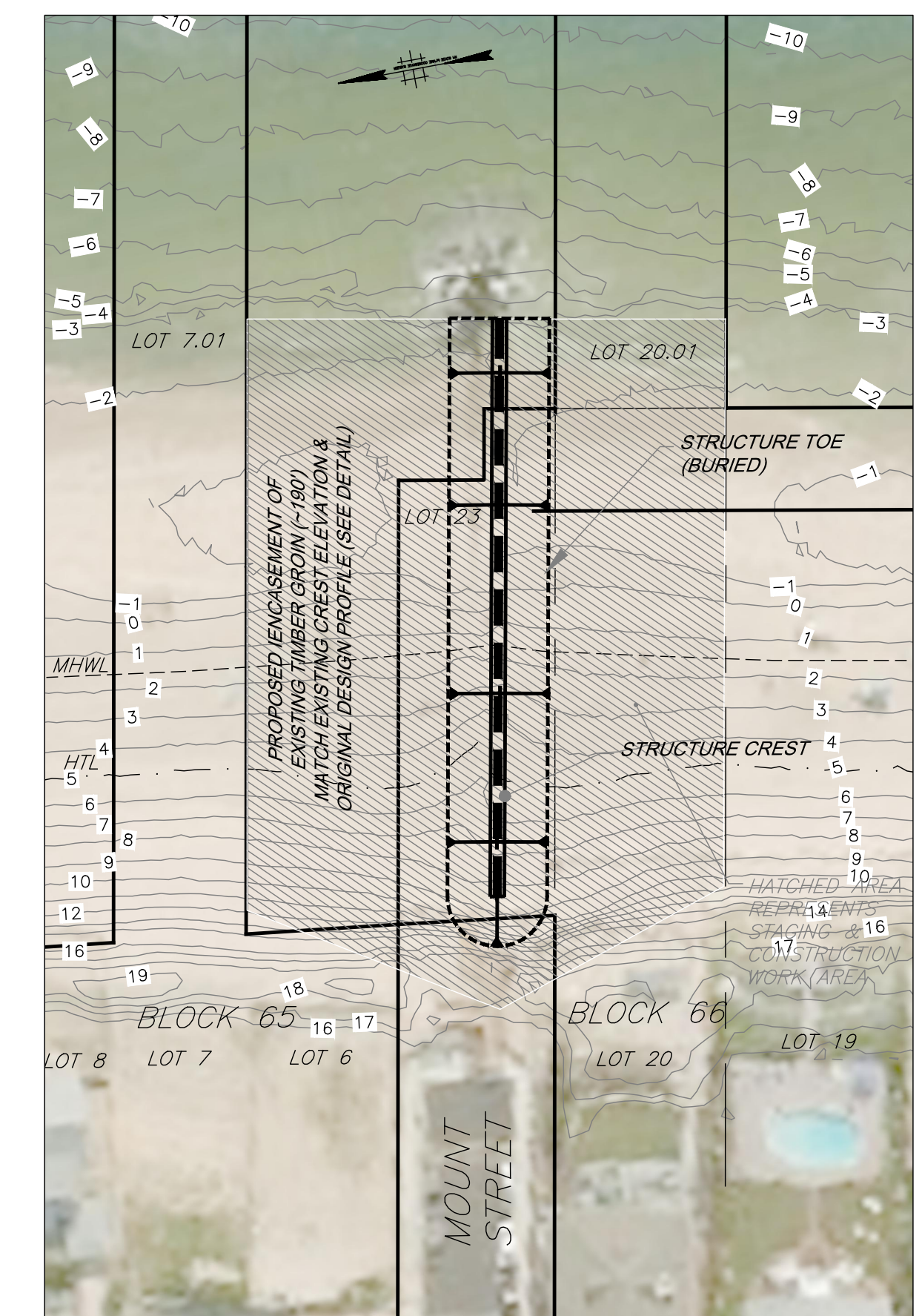
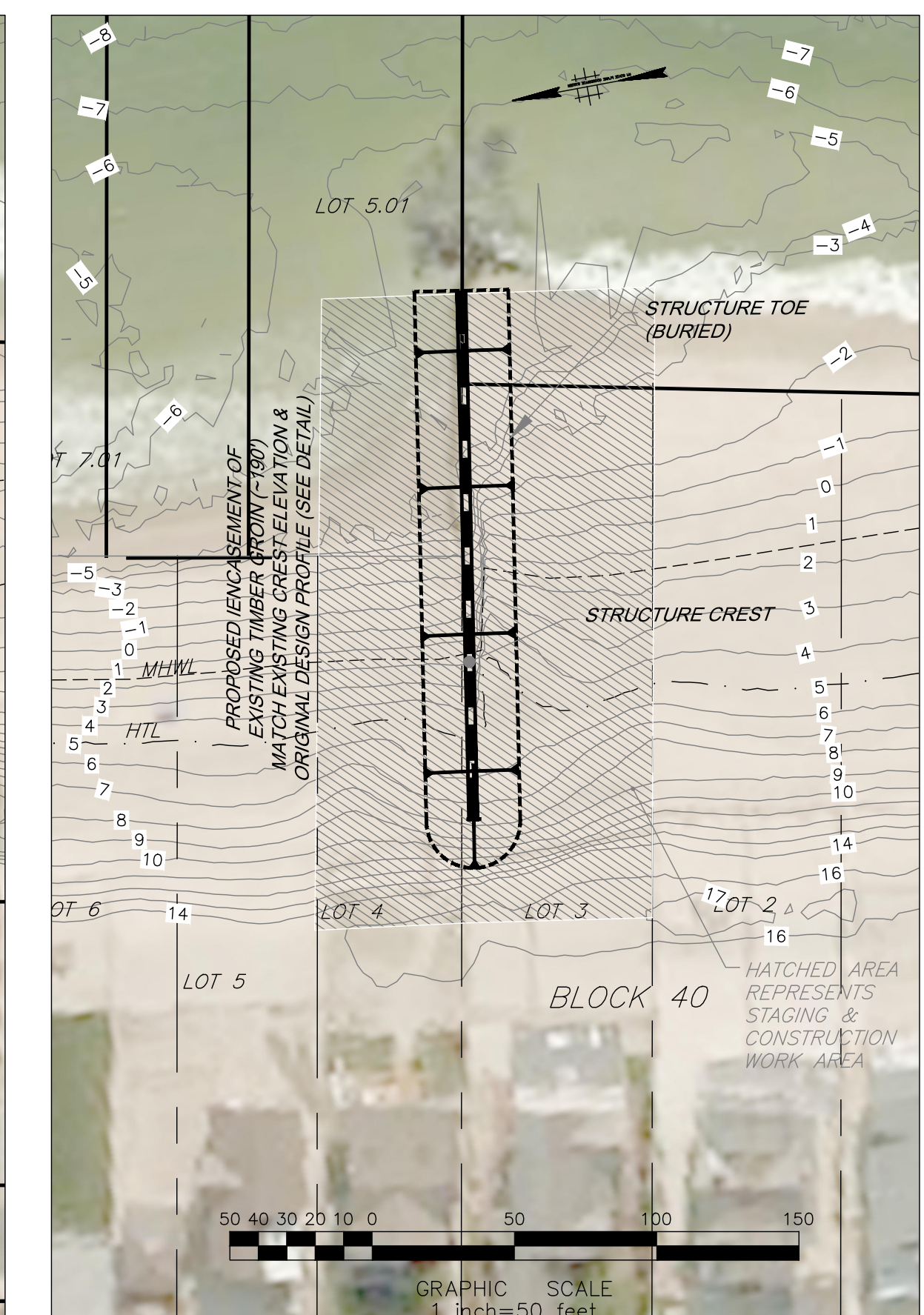
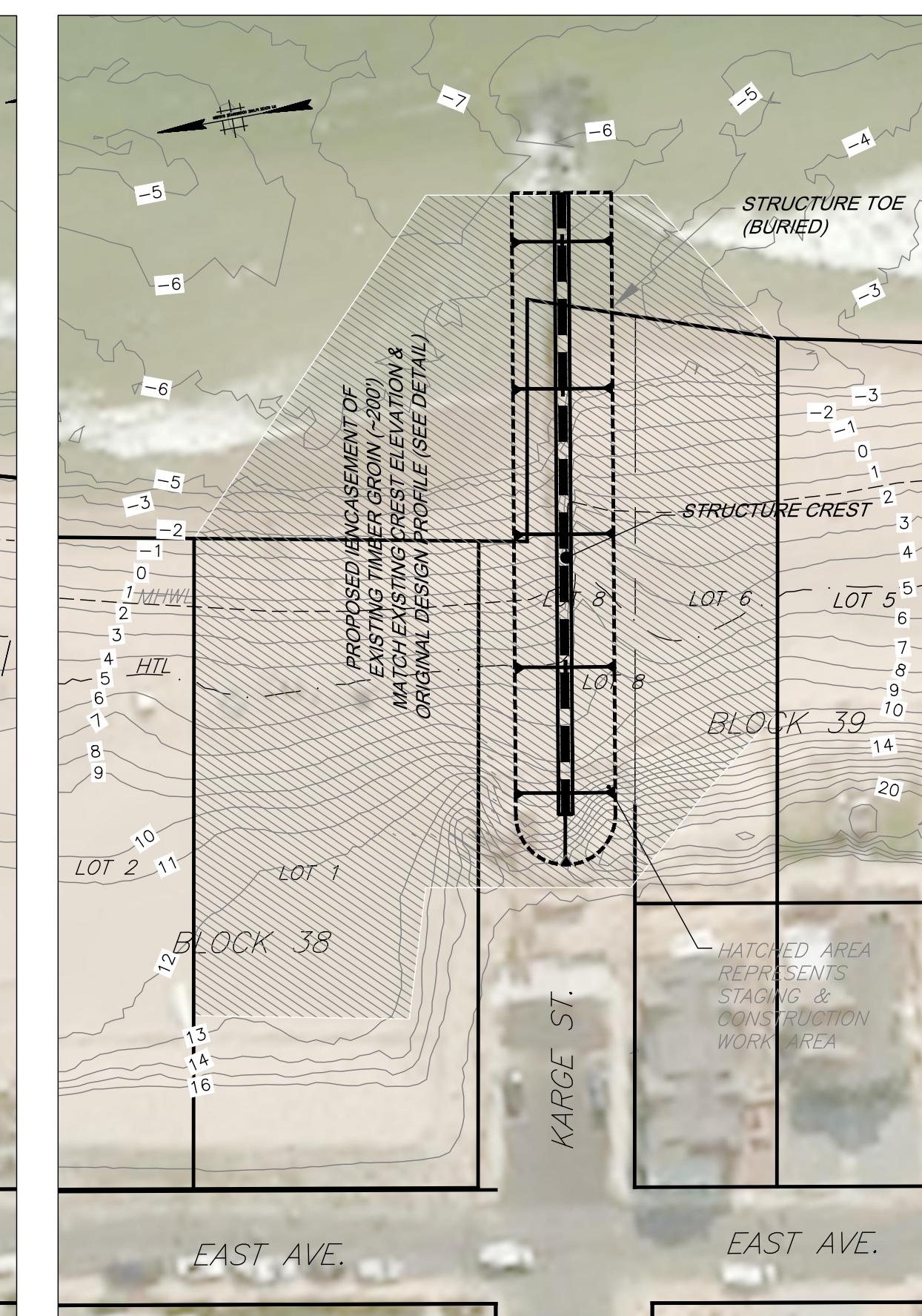
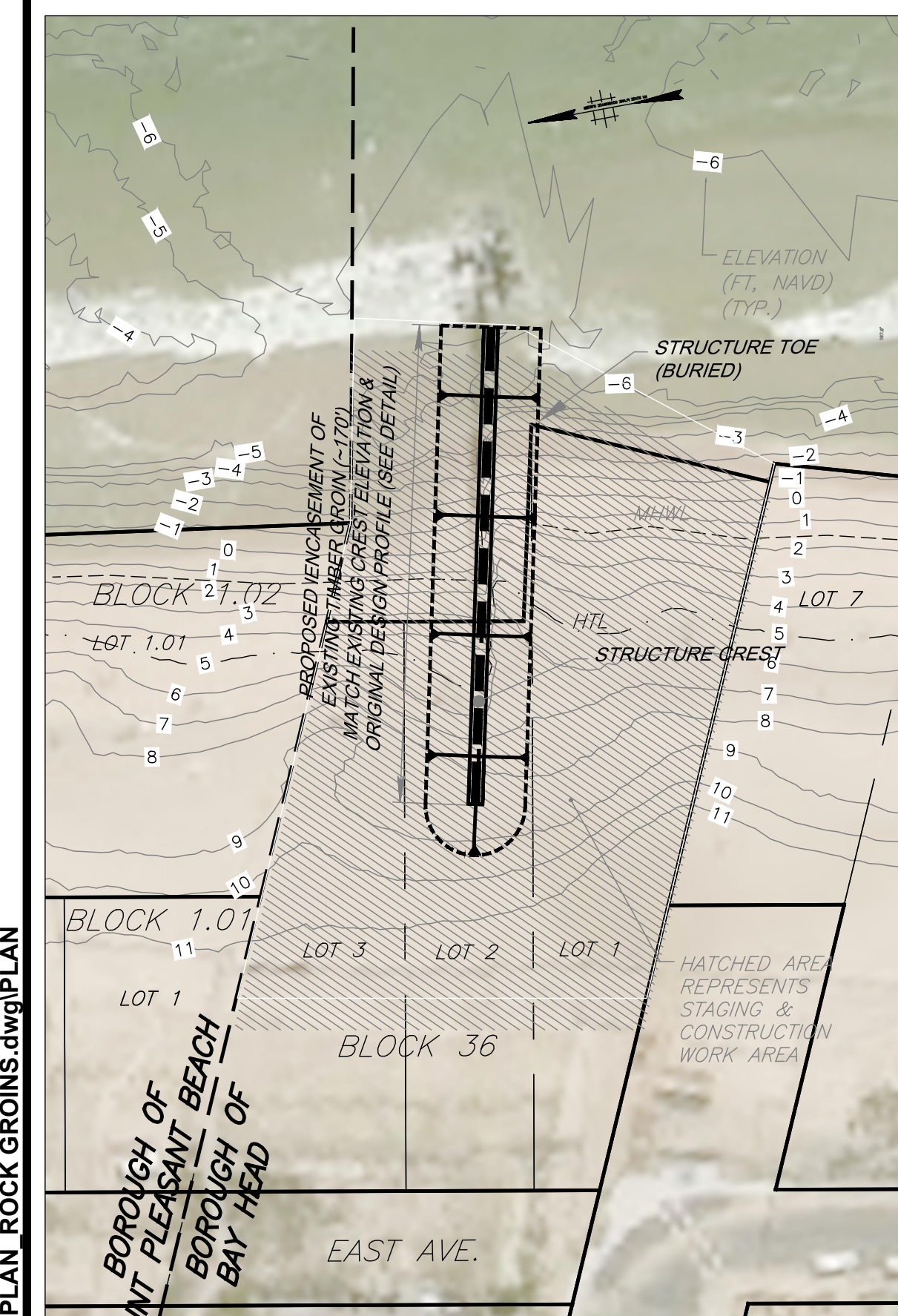
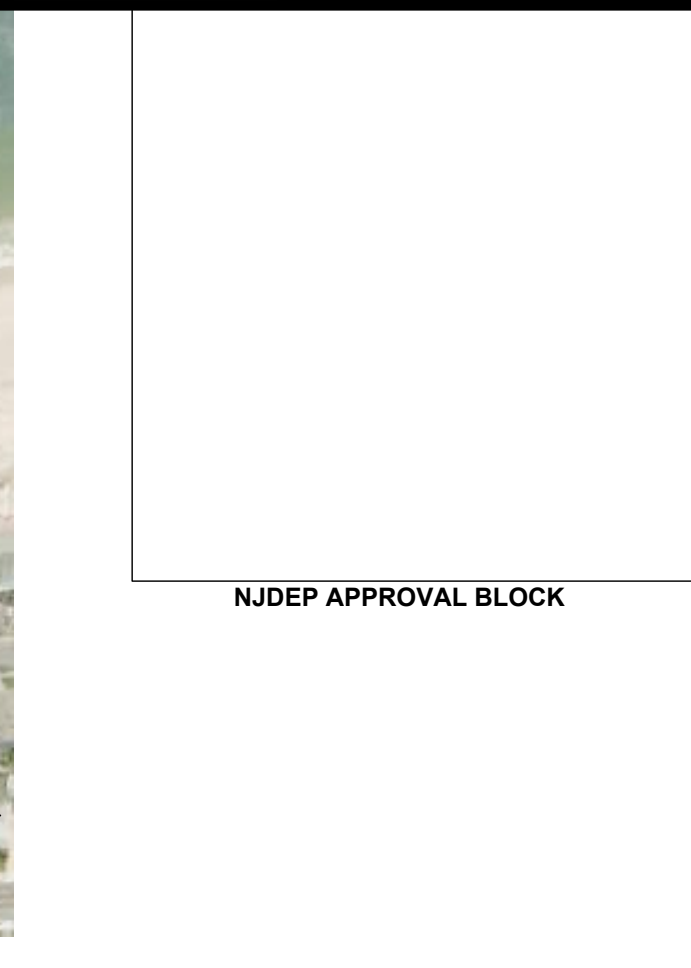
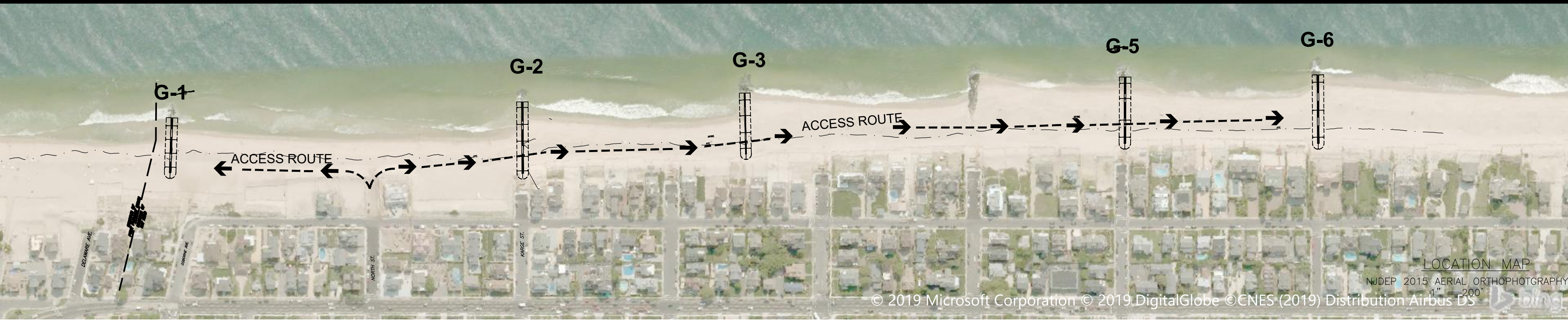
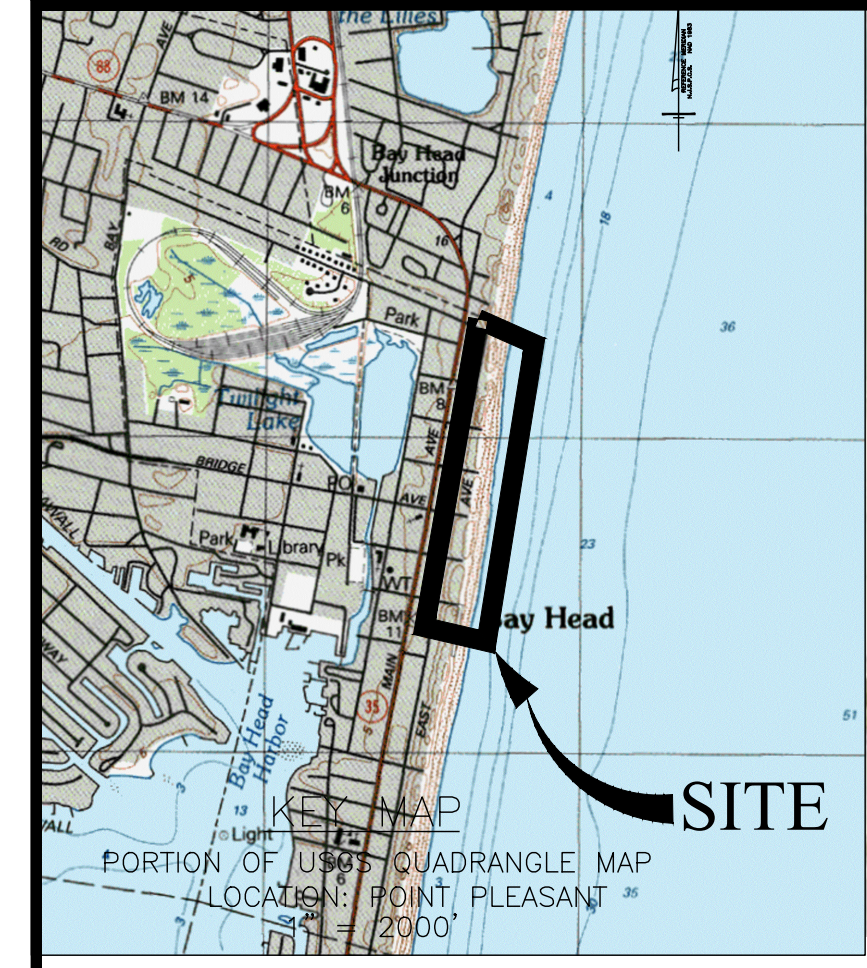

**GROIN G-1**  
 Permanent improvements : Block 36, Lot 2  
 Staging Areas : Block 36, Lots 1 & 3

**GROIN G-2**  
 Permanent improvements : Block 39, Lot 8  
 Staging Areas : Block 38, Lot 1; Block 39, Lot 6

**GROIN G-3**  
 Permanent improvements : Block 40, Lot 3  
 Staging Areas : Block 40, Lot 4

**GROIN G-5**  
 Permanent improvements : Block 66, Lot 23  
 Staging Areas : Block 65, Lot 6; Block 66, Lot 20

**GROIN G-6**  
 Permanent improvements : Block 66, Lot 15  
 Staging Areas : Block 66, Lot 16

NOTES:  
 1. VERTICAL DATUM : NAVD 88  
 2. HORIZONTAL DATUM : NAD 83  
 3. AERIAL PHOTOGRAPHY  
 REFERENCE : NJDEP GIS 2015  
 4. TOPOGRAPHIC / BATHYMETRIC  
 REFERENCE : 2014 NOAA  
 POST HURRICANE SANDY  
 TOPOBATHYMETRIC LIDAR  
 MAPPING FOR SHORELINE  
 MAPPING

PROPERTIES AFFECTED BY ACCESS ROUTES  
 (excluding properties affected by permanent  
 improvements or staging areas):  
 Block 37, Lots 1, 2, 3, 4, 6 & 7  
 Block 38, Lots 2, 3, 4 & 5  
 Block 39, Lots 1, 2, 3, 4, 5, 6 & 7  
 Block 40, Lots 1, 2, 5, 7 & 9  
 Block 64, Lots 1, 2, 3, 4, 5 & 6  
 Block 65, Lots 3, 4, 5, 7, 8 & 9  
 Block 66, Lots 16.01, 17, 18, 19, 21, 22 & 23

TIDAL DATUMS:  
 1. HTL = 5.0 FT  
 2. MHW = 1.6 FT  
 3. NAVD = 0.0 FT  
 4. MLW = -2.7 FT  
 5. MLLW = -2.9 FT  
 \* Reference : USACE Manasquan  
 Inlet to Barnegat Inlet  
 Feasibility Study

REVISIONS	
NO.	DESCRIPTION
2	REVISE TO INCORPORATE ROCK CONSTRUCTION
1	CONSTRUCTION NOTES

DESIGNED BY:  
 AWR  
 ANDREW W. RAICHEL, P.E.  
 NEW JERSEY PROFESSIONAL ENGINEER  
 LICENSE NO. 24GEI  
 01/17/19  
 DATE

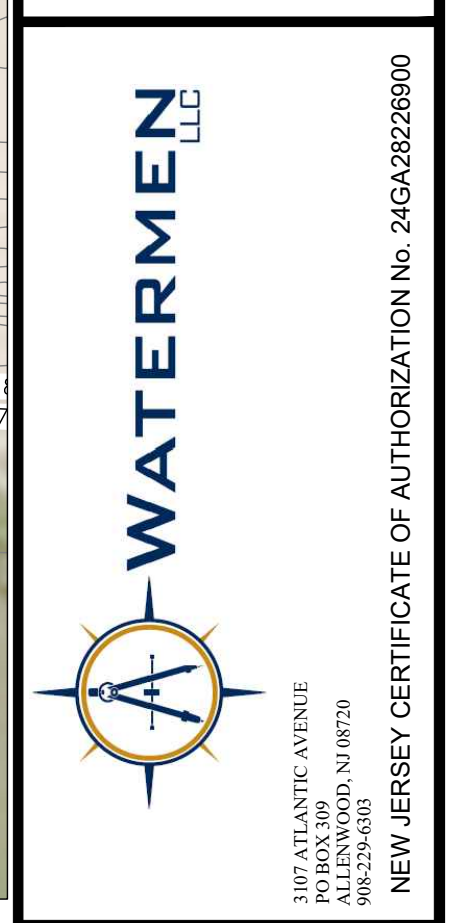

**WATERMEN LLC**  
 1000 ATLANTIC AVENUE  
 FORT LEE, NJ 07024  
 NEW JERSEY CERTIFICATE OF AUTHORIZATION No. 24GA28228900

PROJECT NUMBER: 16-10-04  
 DATE: 10/02/16  
 SCALE: AS SHOWN  
**DWG**  
 SHEET 1 OF 2

Plotted: 10/26/2021 8:14 AM, By: Andrew Raichle  
 C:\MATRIX\NEWORLD\C:\Users\arai\OneDrive\Projects\BAY HEAD GROINS\PERMIT PLAN ROCK GROINS.dwg\PLAN

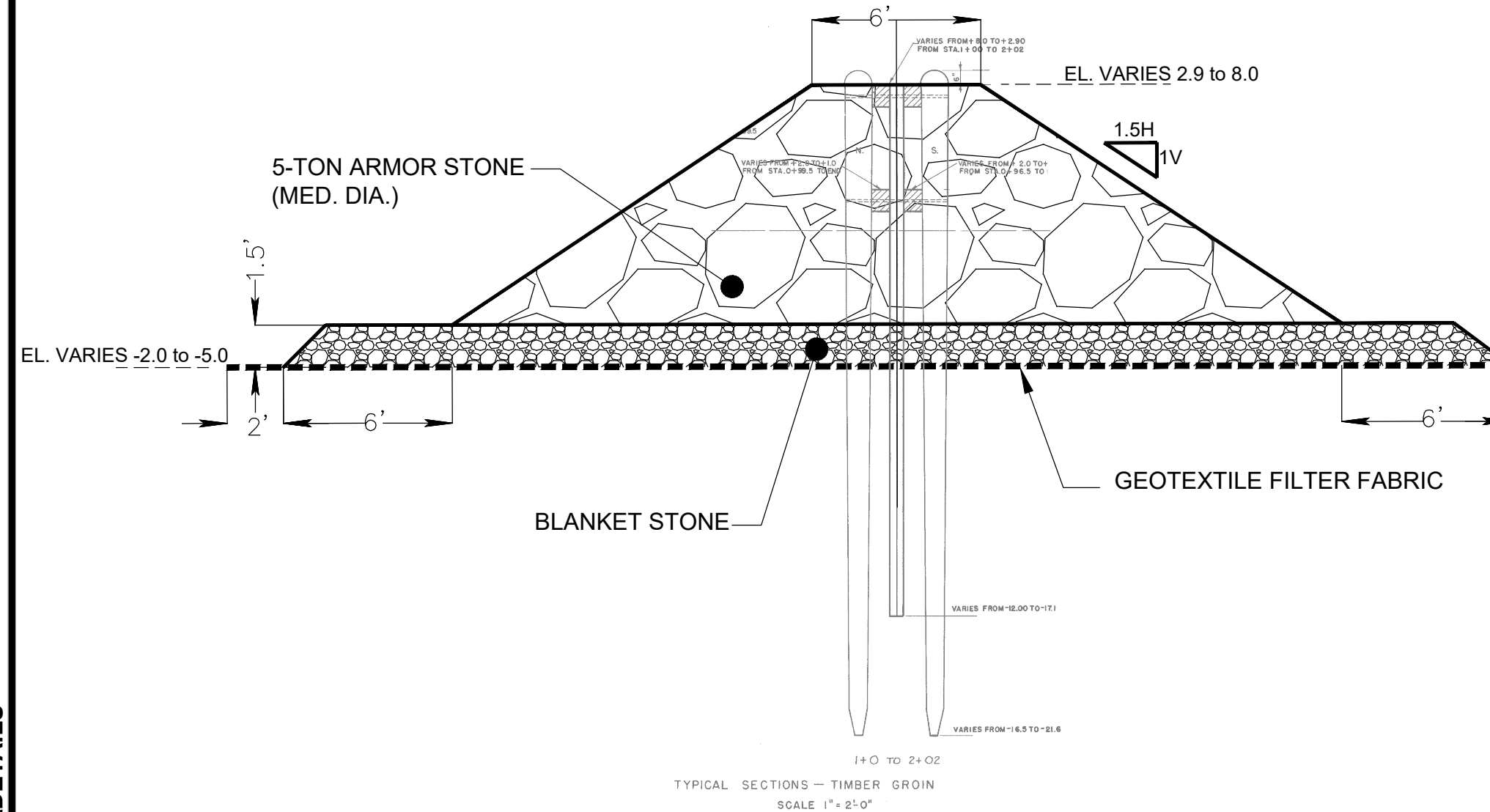
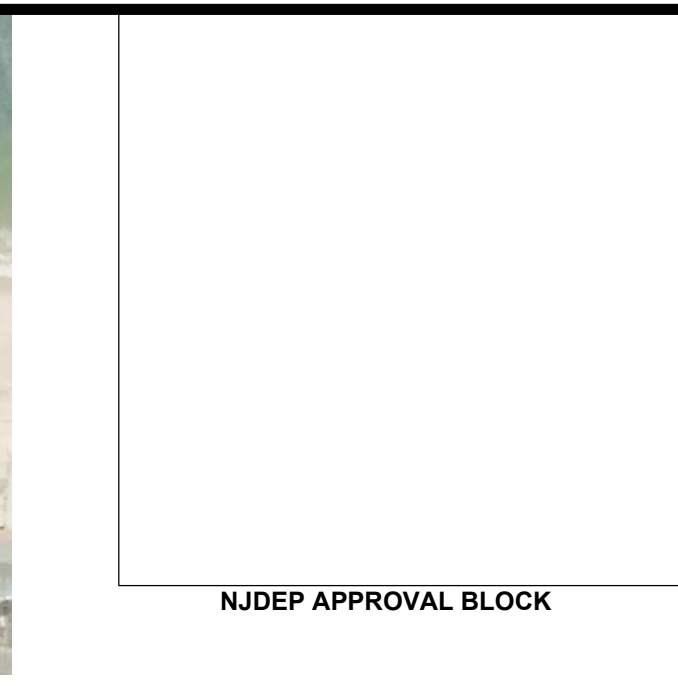
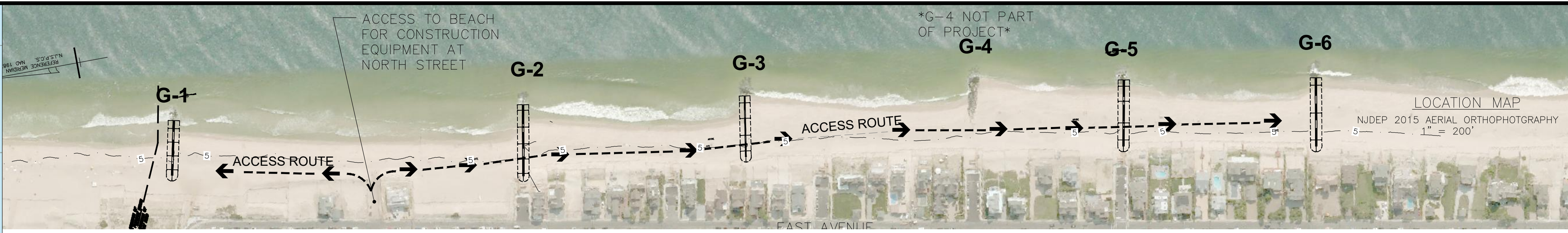
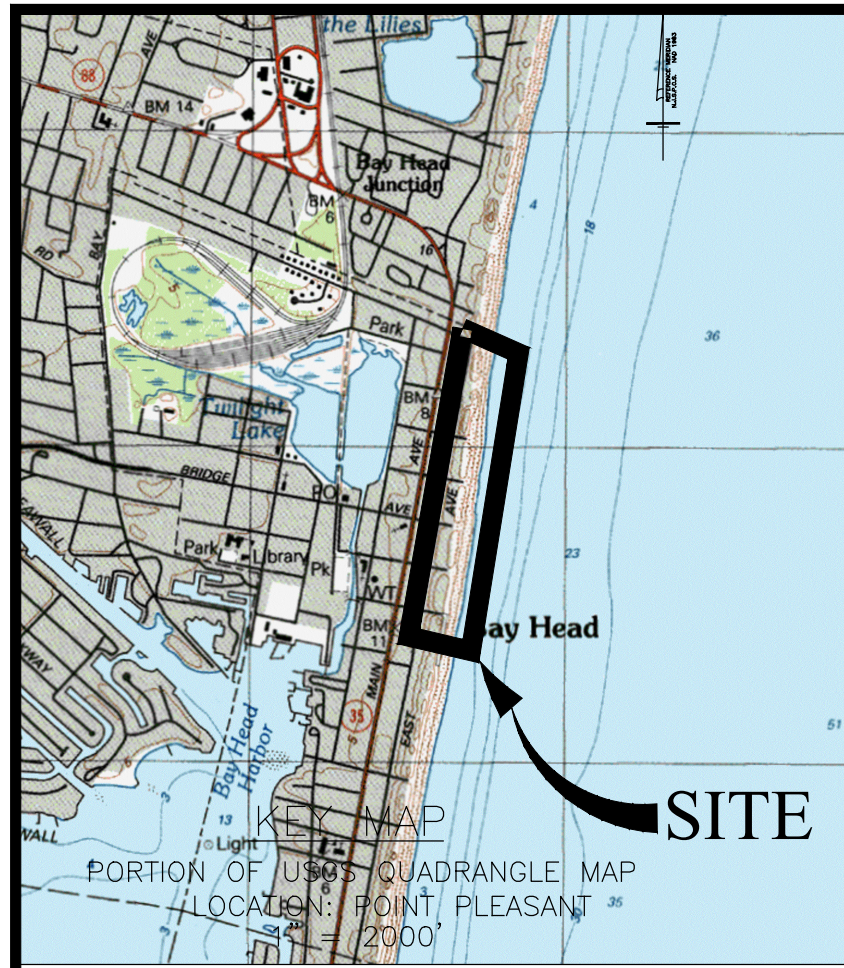

ROCK GROIN REPLACEMENT DETAIL (1"=5')

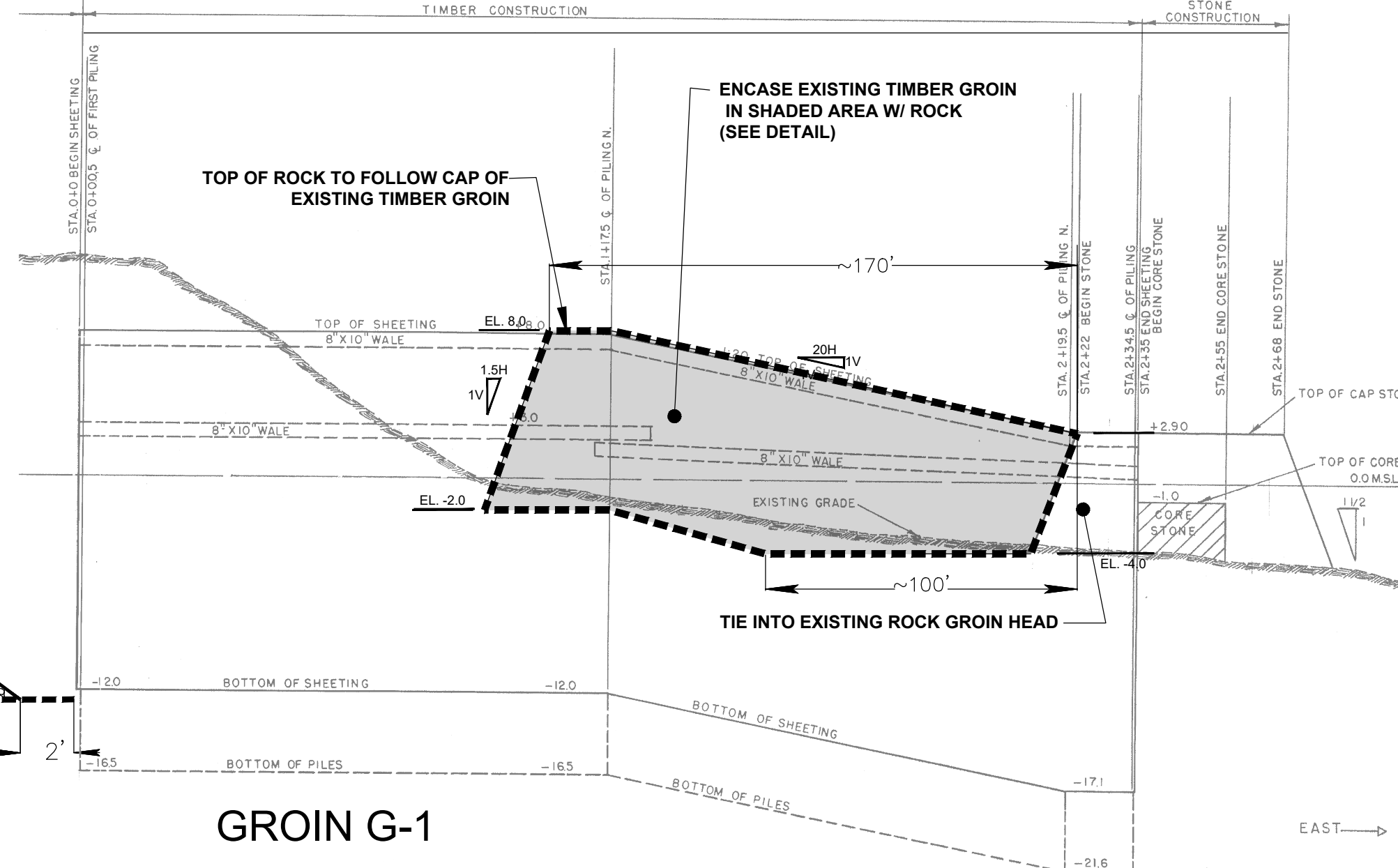

GROIN G-1

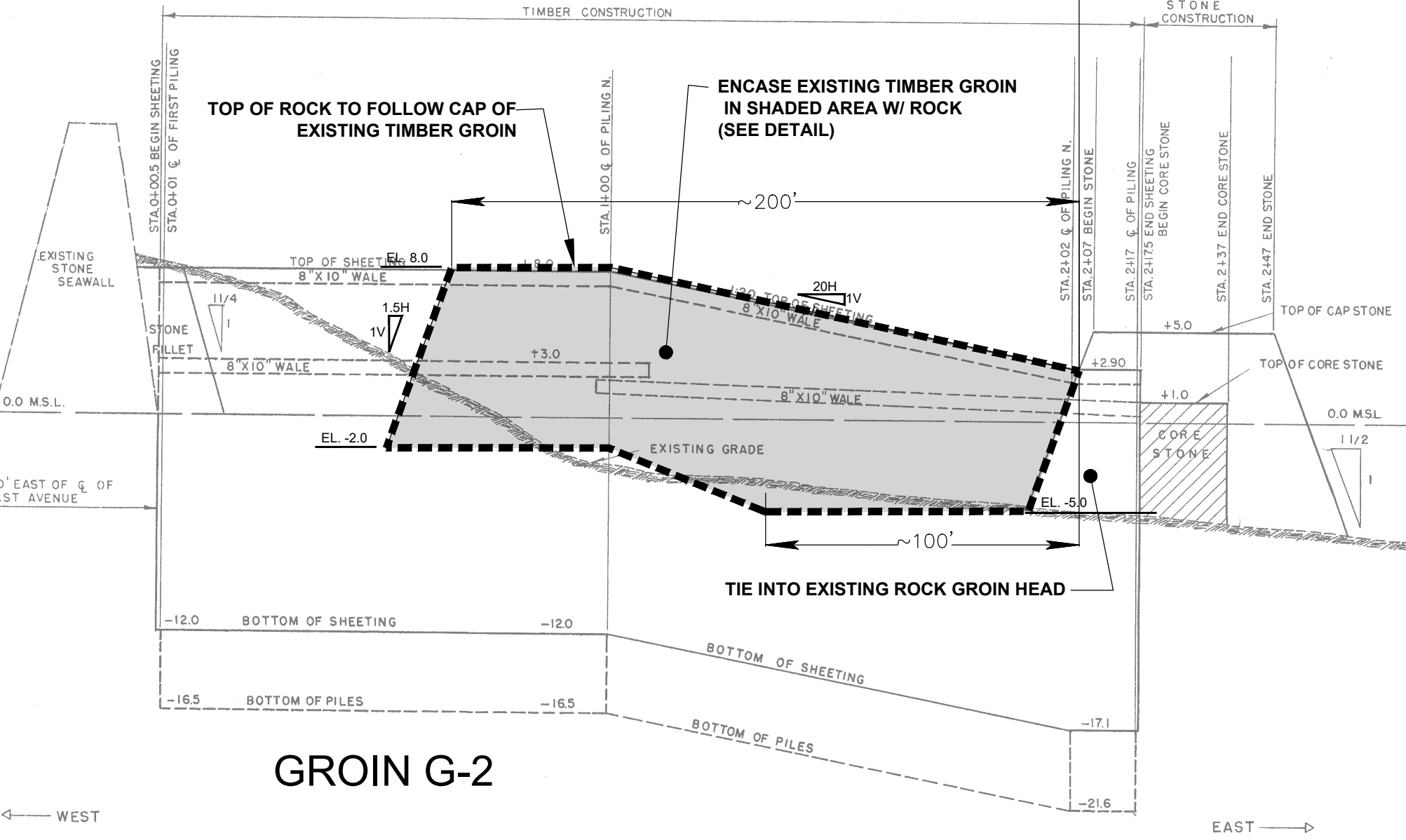

GROIN G-2

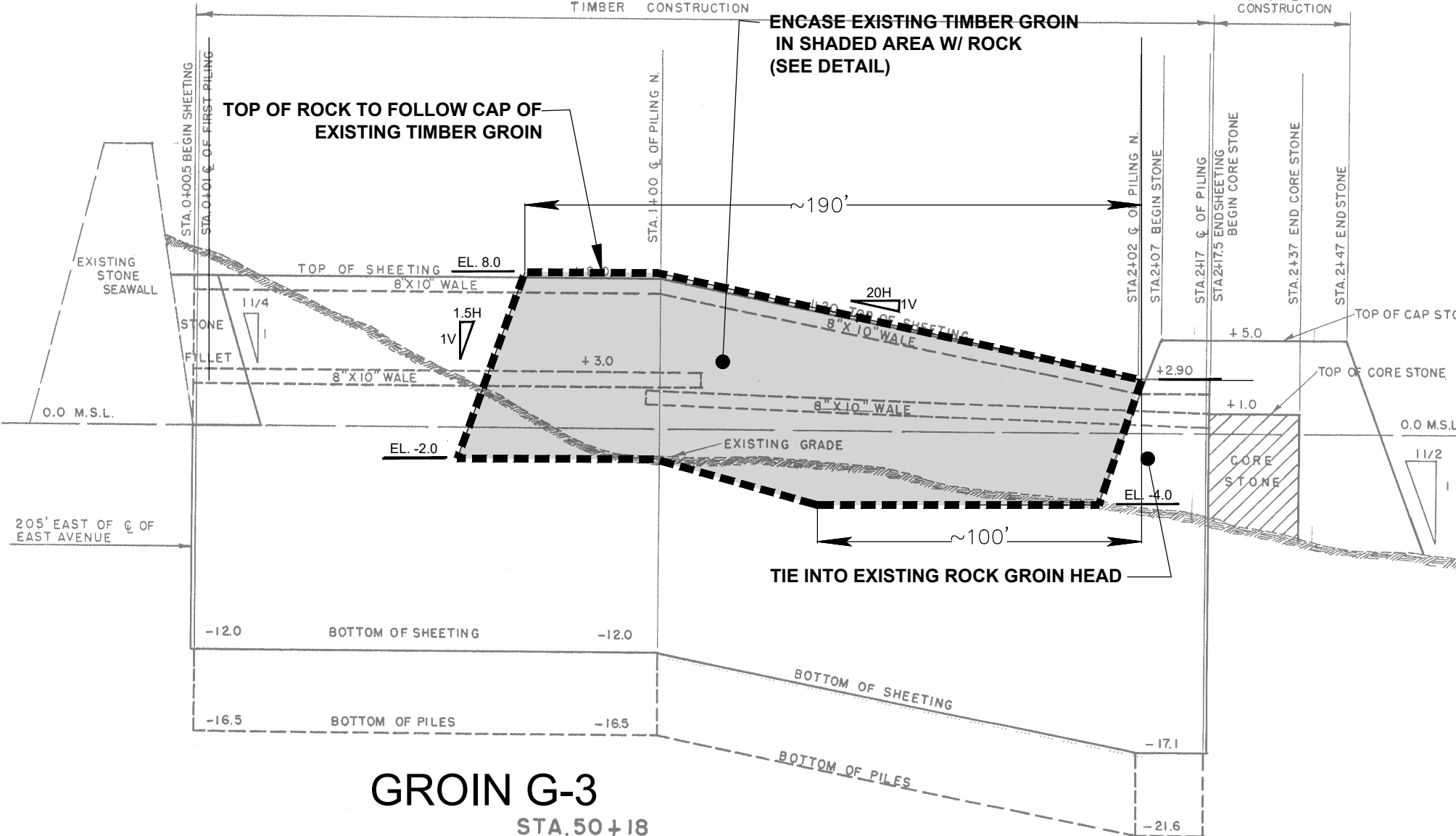

GROIN G-3

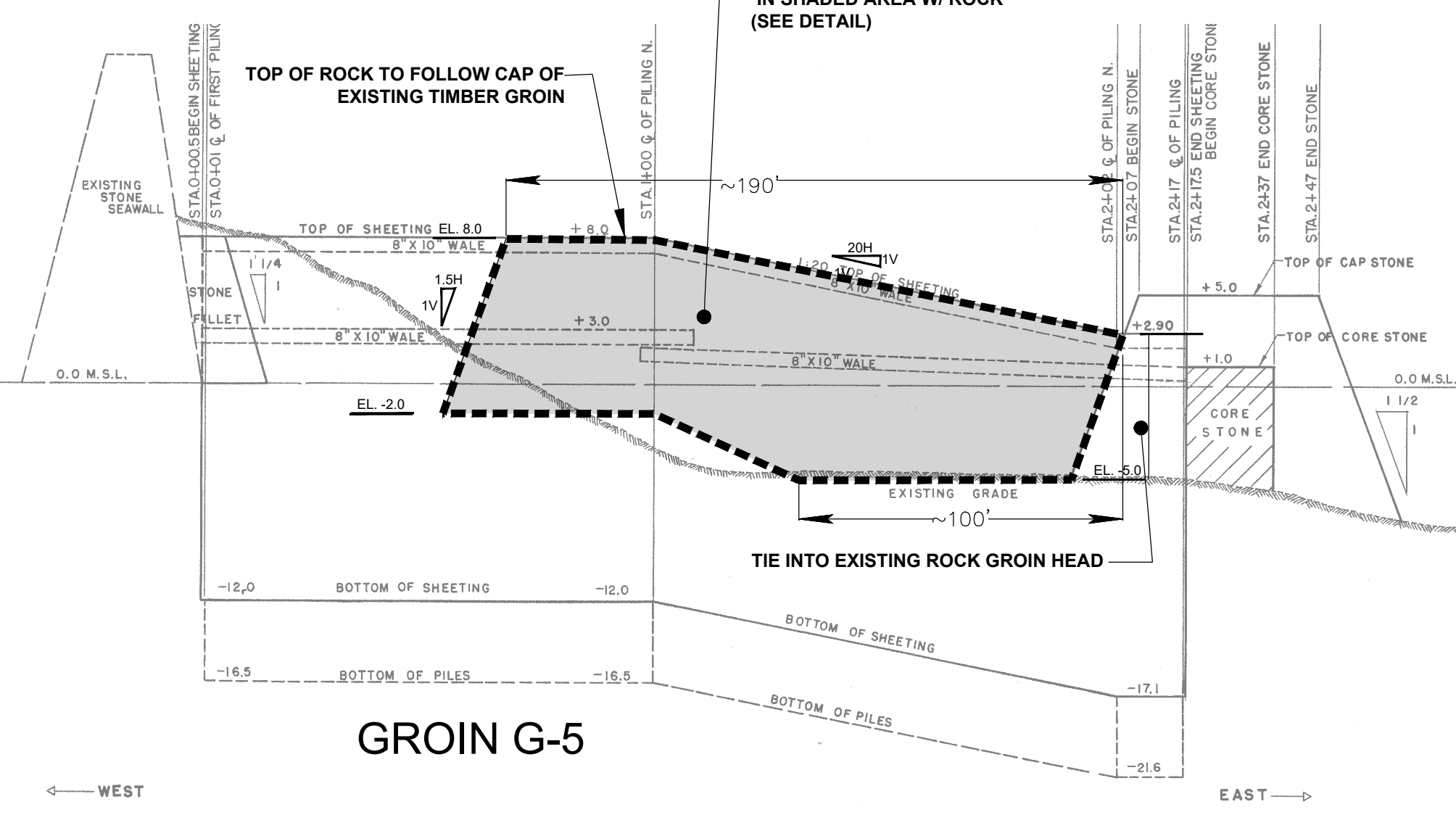

GROIN G-5

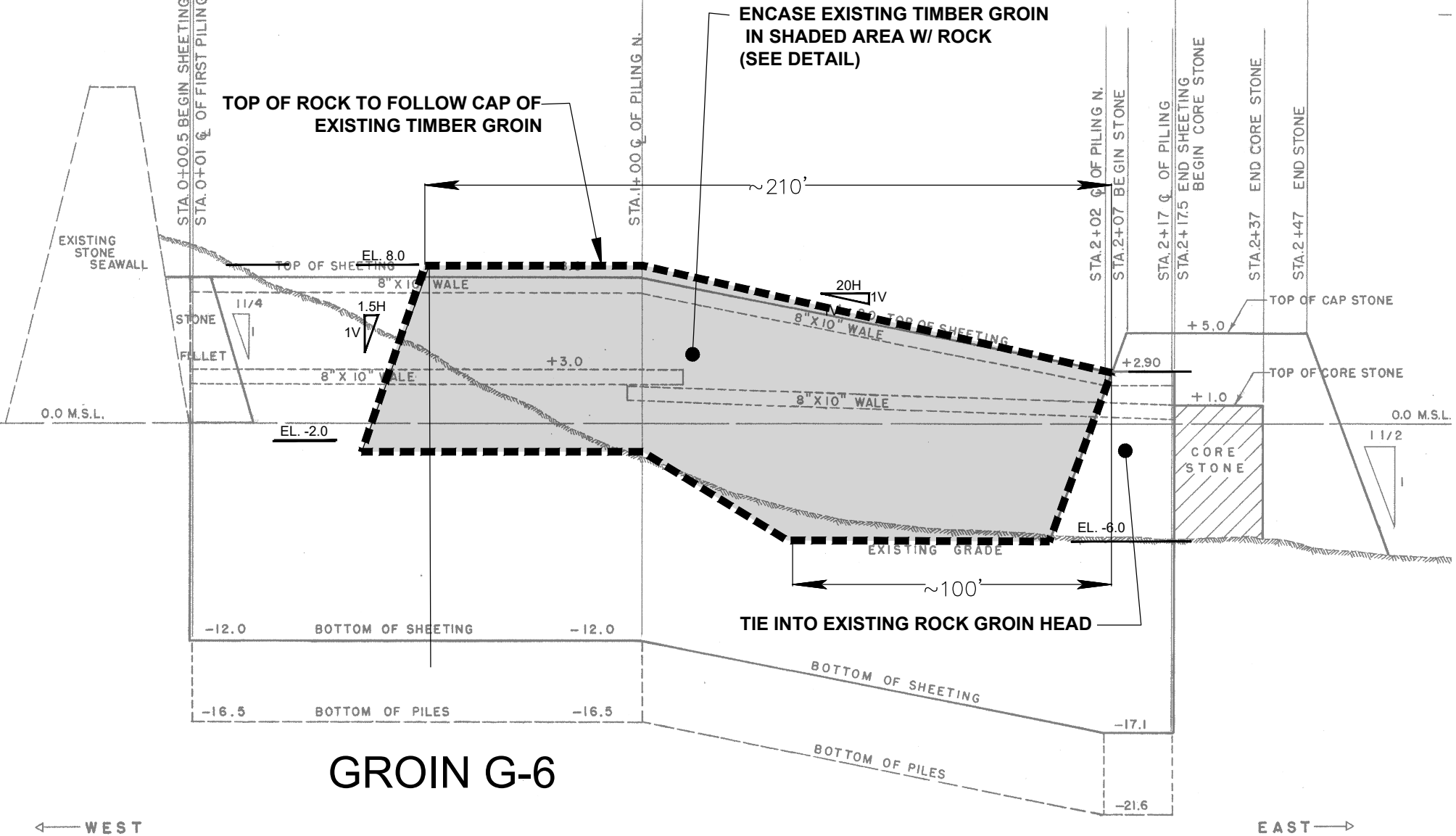

GROIN G-6

ELEVATIONS SHOW ON DETAILS AND REFERENCE DRAWINGS (SEE NOTE AT RIGHT) ARE SUBJECT TO THE FOLLOWING DATUM CONVERSIONS \*\*\*

- 0.00 NAVD = +1.06 ft NGVD
- Top of Sheeting +8 ft NGVD = +6.94 ft, NAVD
- Bottom of Sheeting -12 ft, NGVD = -13.06 ft, NAVD
- Bottom of Piles -16.5 ft, NGVD = -17.56 ft, NAVD

MATERIALS:

1. All timber shall be southern yellow pine, treated with 2.50 lbs. d.f. of c.c.a.
2. All metal shall be hot dipped galvanized
3. All nuts shall be peened after hardware is secured
4. All bolt connections shall be countersunk

- \*\*\* DETAILS SHOWN HEREON ARE REFERENCED FROM THE FOLLOWING DRAWINGS. CONTRACTOR SHALL CONSTRUCT TIMBER GROIN REPLACEMENTS IN ACCORDANCE WITH THE DETAILS / LINES & GRADES SHOWN ON THE BELOW-REFERENCED DRAWINGS. THE DETAIL SHOWN HEREON ARE FOR ILLUSTRATIVE PURPOSES ONLY \*\*\*
1. "Construction Plans, Groins, Borough of Bay Head, Ocean County, New Jersey, 1966." State of New Jersey Department of Conservation and Economic Development. 7 Sheets.
  2. "Construction Plans, Seawall and Groins, Borough of Bay Head, Ocean County, New Jersey, 1962." State of New Jersey Department of Conservation and Economic Development. 6 Sheets.

DESIGNED BY:  
AWR  
REVIEWED BY:  
AWR  
RELEASED BY:  
AWR  
DATE:

**ANDREW W. RAICHE, P.E.**  
NEW JERSEY PROFESSIONAL ENGINEER  
LICENSE NO. 24C

**WATERMEN LLC**  
300 ATLANTIC AVENUE  
PO BOX 970  
BAY HEAD, NJ 08008  
908-228-9893

NEW JERSEY CERTIFICATE OF AUTHORIZATION No. 24GA28226900

**GROIN MAINTENANCE DETAILS**

ATLANTIC COASTAL SHORELINE  
BOROUGH OF BAY HEAD, OCEAN COUNTY, NEW JERSEY

PROJECT NUMBER: 16-10-04  
DATE: 10/02/16  
SCALE: AS SHOWN

**DWG**  
SHEET 2 OF 2

Plotted: 10/26/2021 8:12 AM, By: Andrew Ratcliff  
© MATRIXWORLD.COM:Users\aratchie\Dropbox\Watermen2\Projects\BAY HEAD GROINS\PERMIT PLAN\_ROCK GROINS.dwg\DETAILS