



2007 FREE AND OPEN SOURCE SOFTWARE FOR GEOSPATIAL (FOSS4G) CONFERENCE

www.foss4g2007.org

CONFERENCE PROGRAM



September 24-27, 2007
Victoria Conference Centre, Victoria, BC Canada

FOSS4G Sponsors



Conference Host



Platinum Sponsor



Gold Sponsors



Silver Sponsors



Media Partners



Exhibitors

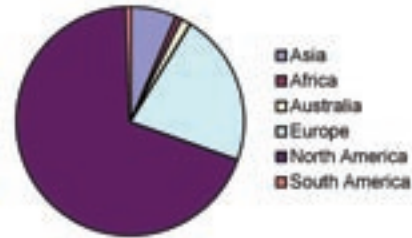

Table of Contents



	Page #
<i>FOSS4G Sponsors</i>	2
<i>Program at a Glance</i>	5
<i>Conference Highlights</i>	6 - 7
<i>Practical Information</i>	8 - 9
<i>Sponsors & Exhibitors</i>	10 - 11
<i>Monday, September 24 Schedule</i>	13
<i>Tuesday, September 25 Schedule</i>	16 - 17
<i>Wednesday, September 26</i> <i>- Morning Sessions Schedule</i>	18 - 19
<i>Wednesday, September 26</i> <i>- Afternoon Sessions Schedule</i>	20 - 21
<i>Thursday, September 27 Schedule</i> ..	22 - 23
<i>Workshops, Monday, September 24</i>	25
<i>Labs</i>	26 - 27
<i>FOSS4G Demonstration Theatre</i>	28
<i>Welcome to Victoria</i>	29
<i>Victoria Conference Centre Floor Plans</i>	32

Attendees by Country



Asia		Europe		North America	
Afghanistan	3	Austria	5	Canada	160
China	5	Belgium	5	Mexico	2
India	2	Czech Republic	3	USA	209
Indonesia	1	Denmark	2		371
Iran	1	Finland	1	South America	
Japan	10	France	14	Brazil	4
South Korea	9	Germany	10	Columbia	1
Palestine	1	Hungary	1	Venezuela	1
Taiwan	1	Italy	13		6
Thailand	2	Kosovo	1		
Vietnam	1	Luxembourg	1		
	36	Norway	6		
Africa		Poland	1		
Egypt	1	Portugal	3		
Namibia	2	Romania	2		
South Africa	1	Slovenia	1		
	4	Spain	10		
Australia		Sweden	4		
Australia	3	Switzerland	12		
Fiji	2	The Netherlands	8		
New Zealand	3	United Kingdom	14		
	8		117		

Local Organizing Committee

Victoria Committee

- Paul Ramsey, (Chair), President, Refractions Research
- Brian Low, Geospatial Scientist, Pacific Forestry Centre
- Jason Birch, Senior Applications Analyst, Information Technology Office, City of Nanaimo
- Evert Kenk, Executive Director, Chief Resource Information Office Government of British Columbia
- Tyler Mitchell, Executive Director, Open Source Geospatial Foundation
- Dale Lutz, Vice President Research and Development, Safe Software
- Dave Patton, Consultant, CIS, Degree Confluence Project

OSGeo Representatives

- Jeff McKenna, Conference Committee Chair
- Frank Warmerdam, Board Representative



GeoConnections.org GéoConnexions.org

LOCATION-BASED INFORMATION ONLINE

PUBLIC SAFETY

PUBLIC HEALTH

ENVIRONMENT & SUSTAINABLE DEVELOPMENT

ABORIGINAL COMMUNITIES



INFORMATION GÉO RÉFÉRENCÉE EN LIGNE

SÉCURITÉ PUBLIQUE

SANTÉ PUBLIQUE

ENVIRONNEMENT ET DÉVELOPPEMENT DURABLE

COLLECTIVITÉS AUTOCHTONES

Mapping the future together online *Cartographions l'avenir en ligne*

GeoConnections is a Canadian partnership program and a proud contributor to FOSS4G 2007.

GeoConnections helps decision-makers use online location-based (or "geospatial") information, such as maps and satellite images, to tackle some of Canada's most pressing challenges. The program focuses on working with partners in public health, public safety and security, the environment and sustainable development, Aboriginal matters, and geomatics technology development.

Le programme de partenariat canadien GéoConnexions est fier d'avoir contribué à la conférence FOSS4G 2007.

GéoConnexions aide les décideurs à utiliser de l'information géoréférencée (ou = géospatiale =) disponible en ligne, comme des cartes et des images satellitaires, pour répondre à des besoins pressants au Canada. Le programme s'emploie essentiellement à tisser des partenariats dans les domaines de la santé publique, de la sécurité publique, de l'environnement et du développement durable, des enjeux autochtones et du développement de la technologie géomatique.

Canadian
Geospatial
Data
Infrastructure



Infrastructure
canadienne
de données
géospatiales

Canada



The De Facto Standard for Spatial ETL!

Bridge open source and proprietary worlds with FME

Work seamlessly with open source formats and databases, and FDO data providers

GDAL

PostGIS

MySQL

PostgreSQL

OGR

GEOS

SQLite



For more information:
604-501-9985
info@safe.com
www.safe.com

Program at a Glance



SUNDAY, SEPTEMBER 23

15:00 – 19:00	Registration Desk Open
---------------	------------------------

MONDAY, SEPTEMBER 24

07:30 – 18:30	Registration Desk Open
09:00 – 12:00	Workshops
12:00 – 13:00	Lunch
13:00 – 16:00	Workshops
16:30 – 18:00	OSGeo Annual General Meeting
18:00 – 22:00	Welcome Reception at the Sticky Wicket

TUESDAY, SEPTEMBER 25

07:30 – 17:30	Registration Desk Open
09:00 – 10:40	Opening Plenary Session
10:40 – 11:00	Refreshment Break
11:00 – 12:00	Keynote Address – Damian Conway
12:00 – 13:00	Lunch
13:00 – 14:30	Presentation Sessions and Labs
14:30 – 15:00	Refreshment Break
15:00 – 16:30	Presentation Sessions and Labs
16:45 – 19:00	Birds-of-a-Feather Sessions

WEDNESDAY, SEPTEMBER 26

08:00 – 16:30	Registration Desk Open
08:30 – 10:00	Presentation Sessions and Labs
10:00 – 10:30	Refreshment Break
10:30 – 12:00	Presentation Sessions and Labs
12:00 – 13:00	Lunch and Poster Session
13:00 – 14:30	Presentation Sessions and Labs
14:30 – 15:00	Refreshment Break
15:00 – 16:30	Presentation Sessions and Labs
16:45 – 17:45	Birds-of-a-Feather Sessions
18:00 – 20:00	Dinner Reception at the Royal BC Museum

THURSDAY, SEPTEMBER 27

08:00 – 14:30	Registration Desk Open
08:30 – 10:00	Presentation Sessions and Labs
10:00 – 10:30	Refreshment Break
10:30 – 12:00	Presentation Sessions and Labs
12:00 – 13:00	Lunch
13:00 – 15:00	Closing Plenary Session

FRIDAY, SEPTEMBER 28

09:00 – 17:00	Developers' Code Sprint
---------------	-------------------------

Conference Highlights



Opening Plenary



Geoff Zeiss,
Director of Technology, Autodesk

Geoff has more than 10 years experience developing enterprise geospatial solutions for the utilities, communications, and public works industries. Since joining Autodesk in 1999, Geoff has been responsible for enterprise solutions in Autodesk's Infrastructure Solutions Division. Geoff is a frequent speaker at geospatial events around the world including GITA (U.S., Australia, Japan), GeoBrazil, GeoTec, MapIndia, and MapAsia.



Tyler Mitchell,
*Executive Director,
Open Source Geospatial Foundation
(OSGeo)*

Tyler is a geographer, open source enthusiast and the author of *Web Mapping Illustrated* (O'Reilly). His foray into the open source world began while looking for alternatives to proprietary mapping products. He is an avid user of Mapserver, the popular web mapping program, and other spatial data management tools. Before becoming the Executive Director of OSGeo, Tyler worked for many years as a GIS manager and programmer in the forest industry.



Peter Rushforth,
*Technology Advisor, GeoConnections,
Government of Canada*

Peter has worked in the geospatial industry for more than 20 years, starting as a field geologist, and along the way developing a passion for geographic information management and open standard geospatial technologies. In 2007, he joined GeoConnections in order to help advance the use of open standard geospatial data and technologies in support of the Canadian Geospatial Data Infrastructure (CGDI) initiative. Before joining GeoConnections, Peter worked on the geographic processing of four censuses, with Statistics Canada.

Featured Speaker



Damian Conway

Damian's presentation, *Geek Eye for the Suit Guy*, will look at what Open Source software is and isn't, examine its advantages and deficiencies compared to proprietary software, lay out the basic business case for considering Open Source, and enumerate the major questions that need to be answered when making any strategic software decision.

But more importantly, we'll look at those issues through geek eyes. Open Source software development and support is based on a model of collaborative interaction that is entirely different from the competitive world of commercial software. It's not a business; it's a culture.

About Damian Conway: Damian was the winner of the 1998, 1999, and 2000 Larry Wall Awards for Practical Utility. The best technical paper at the annual Perl Conference was subsequently named in his honour. He is a member of the technical committee for The Perl Conference, a keynote speaker at many Open Source conferences, a former columnist for *"The Perl Journal"*, and author of the books *"Object Oriented Perl"* and *"Perl Best Practices"*.

Lighting Talks

#1: *Spatial Standards Snapshot*

Raj Singh, Director of Interoperability Programs, Open Geospatial Consortium

Raj Singh manages various software testbeds for the Open Geospatial consortium and is one of the original developers of GeoRSS. He has a PhD in Planning Information Systems for the MIT Department of Urban Studies & Planning.

#2: *The Past, Present and Future of the Geospatial Industry*

Peter Batty, CTO-in-Hiding

Peter has been CTO of Intergraph, Founder and CTO of Ten Sails, now Ubisense, and VP of Technology at Smallworld, now part of GE, and he is currently blogging and deciding what to do next.

#3: *Beyond GPS – Neogeography Data Collection*

Andrew Turner, Neogeographer, Mapufacture

Andrew develops several open-source tools such as GeoPress and Mapstraction, participates in the formulation of light-weight geospatial standards like GeoRSS and KML, and works for Mapufacture, building a geospatial aggregation and search service. He also wrote O'Reilly's Introduction to Neogeography.

#4: No One Wants 3/8-Inch Drill Bits

Ed McNierney, Chief Mapmaker, TopoZone.com

Ed's been a CTO / VP of Engineering kind of guy for almost 30 years, creating spreadsheets, educational children's games, high-performance graphics hardware, and medical imaging software; in 1999 he discovered he lived at the corner of four USGS topographic maps and it was absurdly difficult to put them together into one map, so he invented TopoZone.

#5: Geospatial Summer of Code

James MacGill, Google

James Macgill is a keen open and source and open standards advocate and founder of the GeoTools project. He trained as a Geographer but has been coding as a hobby from the age of 12. He jumped at the opportunity to work on the fusion of computing and geography when he discovered GIS whilst studying environmental science.

#6: Understanding Software Patents

Chris Schmidt, Boy Genius, Metacarta Inc.

Chris is a software developer for MetaCarta, Inc. where he works in part on developing OpenLayers, TileCache, and FeatureServer, and working with MetaCarta to create an environment where MetaCarta can foster and contribute to open source geospatial development.

#7: Polluter-Pays-Principle Applied to Public Geodata

Arnulf Christl, Director, OSGeo

Arnulf is a Free Software advocate who started off as UNIX sysadmin on a Borg cube, turned to spatial, hacked some software and now makes a living out of orchestrating loosely distributed spatial data services and people living in them.

#8: Latent Semantic Analysis of the FOSS4G 2007 Conference Program

Schuyler Erle, Troublemaker At Large

Schuyler is a long-time hacker, author, and Free Software activist.

Closing Plenary

FOSS4G 2008 Preview

In 2008, FOSS4G will be hosted in Cape Town, South Africa! The conference organizers will give us the scoop on their plans to bring the community to FOSS4G and bring FOSS4G to the community. The theme for 2008 will be "FOSS4G, An Option for Developing Nations".

Closing Panel Discussion

Moderator:

Adena Schutzberg, Executive Editor, Directions Magazine

Panelists:

Peter Batty, Independent Consultant

Tim Bowden, Director, Mapforge Geospatial

Mark Sondheim, BC Integrated Land Management Bureau

Frank Warmerdam, President, OSGeo

The Sol Katz Award



The Sol Katz Award for Geospatial Free and Open Source Software (GFOSS) is awarded annually by OSGeo to individuals who have demonstrated leadership in the GFOSS community. Recipients of the award have contributed significantly through their activities to advance open source ideals in the geospatial realm. The award acknowledges

both the work of community members, and pays tribute to one of its founders, for years to come. The Sol Katz Award will be presented during the Closing Plenary Session on Thursday, September 27.

Sol Katz was an early pioneer of GFOSS and left behind a large body of work in the form of applications, format specifications, and utilities while at the U.S. Bureau of Land Management. Sol died in 1999 from Non-Hodgkin's Lymphoma, but his legacy lives on in the open source world.

FOSS4G 2007 Recap

Adena Schutzberg, Executive Editor, Directions Magazine, shares her observations on the conference, and open source in general, and how she thinks open source is interacting with the "traditional" geospatial software community. In a display of journalistic virtuosity, she will re-cap the conference before it is even complete.

Welcome Reception

***The Clubhouse at the Sticky Wicket Pub, 919 Douglas Street
6 pm to 10 pm, Monday, September 24, 2007***

Join your colleagues for a drink and a chance to see old and new friends at the Welcome Reception. The reception will be held at the Clubhouse in the Sticky Wicket Pub, just a five minute walk from the Victoria Conference Centre. The Sticky Wicket is a Victoria institution, a collection of seven rooms over five levels, each adorned with memorabilia and sports collectibles. A great way to start off the conference!

Dinner Reception

Royal BC Museum, 675 Belleville Street

5:45 pm to 6 pm, Seating, IMAX Theatre at Royal BC Museum

6 pm to 7 pm, IMAX Presentation

7 pm to 10 pm, Dinner Reception, 3rd floor of Royal BC Museum

As the Conference comes to a close, join us for a celebration and send-off in West Coast style at the historic Royal BC Museum. The Museum lies in the very heart of the city and, like the city that surrounds it, is rich in history and resplendent in natural beauty.

The Reception will begin with an exclusive showing of "Titanica" at the IMAX theatre located in the Museum. Then you'll enjoy a drink and a fabulous dinner buffet while wandering through Museum galleries such as the First Peoples Gallery, which gives visitors a striking vision of First Nations cultures before and after the arrival of Europeans.

Whether the setting is a 1800s era town, amongst the totems of the First Peoples Gallery, or in the wildlife in a Coastal Rainforest, this banquet will create its own history. Situated on the Inner Harbour, the Museum is just one block from the Victoria Conference Centre.

This is a ticketed event and the cost is \$50.00 CDN per person.

Practical Information



Internet Access – Wi-Fi

FOSS4G 2007 is pleased to provide Wi-Fi internet access throughout the Victoria Conference Centre to conference attendees at no charge. To access the Wi-Fi please use these steps:

1. To connect to the Access Point view your available wireless networks and select “VCC”
2. Open your Internet Browser. The SolutionIP webpage will display.
3. Click on “User-Based Code”. The prepaid access page will appear, please enter your Code, “foss4g07” (not case sensitive).
4. Make sure to read, and then check the box “I accept the terms and conditions”.
5. Click the “Connect” button to gain Web Access.

If you have questions or difficulties accessing the network please ask a FOSS4G 2007 Committee Member or go to the Registration Desk on Level One of the Victoria Conference Centre for assistance.

Registration Desk Hours

The Registration Desk is located in the Foyer of the Victoria Conference Centre and is open during the following hours:

Sunday, September 23	15:00 – 19:00
Monday, September 24	07:30 – 18:30
Tuesday, September 25	07:30 – 17:30
Wednesday, September 26	08:00 – 16:30
Thursday, September 27	08:00 – 14:30

Dietary Requirements

Attendees who advised the conference secretariat of their special dietary needs will receive tickets listing their dietary requirements for the meals provided. Please submit the appropriate meal ticket to a server who will address your needs. If you have not advised the conference secretariat of your dietary requirements, please advise the staff at the Registration Desk by the Refreshment Break on Tuesday, September 25th.

Name Badges

In addition to being a means of identification to colleagues, you are required to wear your name badge for admission to conference sessions and social events. Room monitors will check name badges before allowing anyone in the session or social event. If you lose your name badge, please visit the Registration Desk for assistance. Replacement badges will be issued at a cost of \$10.00 CDN per badge.

First Aid

In the event of an emergency, alert Victoria Conference Centre Client Services by dialing 1011 at the nearest house phone. A house phone is located in each room and common area. Clearly indicate your location, the nature of the emergency, and a first aid responder, fire or ambulance will be dispatched immediately.

Conference Evaluation Draw

Blank evaluation forms are included in your conference bag. Please fill out your form and return it to the Registration Desk. The registration staff will take your form and give you a draw ticket in exchange. At the closing plenary we will draw and present two lucky winners with shiny new **iPod Nanos!**

Birds of a Feather Sessions

Birds of a Feather Sessions (BoFs) are informal meetings held after-hours in the conference centre, where like-minded people get together to discuss concepts and share ideas. The main goal is to get an interested group of attendees together in a room for dialogue. Everyone is welcome to attend any BoF that sounds interesting. In fact, if you believe a topic deserves a BoF you are welcome to propose one, the only limitation is time and space.

BoF topics and attendees are self-organizing on the OSGeo wiki at the following URL:

http://wiki.osgeo.org/index.php/FOSS4G2007_BOF_Sessions

BoF rooms will be available at the following times:

Tuesday, September 25, 16:45 to 19:00

Wednesday, September 26, 16:45 to 17:45

Check the BoF schedule board located by the Registration Desk for information about what rooms sessions are assigned to, and what rooms are available for last-minute sessions.

Information For Conference Presenters

Each presentation room will be equipped with a computer, projector, screen, and laser pointer. Computers will have the following software loaded: Windows XP Pro, Microsoft Office 2003, Adobe Acrobat Reader, Firefox with Flash plug-in installed, OpenOffice, Google Earth, Windows Media Player, Quicktime. For presenters bringing their own laptop, video switch boxes will be in each room to allow you to connect your laptop to the projector.

A Speaker Ready room will be located in the Sooke Room (Lower Level of the Victoria Conference Centre) to allow presenters to check their presentation prior to their session. The Speaker Ready room will be open from 08:00 to 17:00 from Monday, September 24th to Thursday, September 27 (closes at noon on Thursday). The Speaker Ready room will not be staffed.

Practical Information



Information for Poster Presenters

The Poster Session will be held on Wednesday, September 26, during the Lunch Hour. Join us on Level One, in the registration area, to view the poster submissions and talk with the presenters!

Poster presenters, please ensure your poster is put up before 10:00 on Tuesday, September 25. Hanging materials will be available from the Registration Desk. Do not forget to be at your poster on Wednesday for the lunch-time session! Take down your poster by 14:30 on Thursday, September 27.

Information for Demonstration Theatre

The Demonstration Theatre will be in Sidney room on Level Two, next to the exhibition area. Please arrive 10 minutes prior to your demonstration time slot. In order to minimize down-time between demos, there will be two presentation tables, and presenters will set up their demo at one table while the presenter at the other table gives a demo. Please provide any introductory remarks you want to the moderator when you arrive for setup.

Business Centre

A Business Centre is located on Level One of the Victoria Conference Centre.

Green Meetings

FOSS4G has attempted to comply with international Green Meetings standards to reduce waste at large meetings. We ask your help in this effort. Please be aware of your use of plastic containers and reduce consumption wherever possible. Please return name badges to the Registration Desk and we will happily reuse them.

Language

The official language of the Free and Open Source Software for Geospatial 2007 is English. There is no interpretation provided.

Currency

The currency in Canada is the Canadian Dollar (CAD). At the time of printing, \$1.00 USD = \$1.07 CAD, £1.00 = \$2.13 CAD, \$1.00 EUR = \$1.45 CA

Time Zone

Because daylight savings is still in effect in September, the time zone offset is GMT-7.

Power and Electrical Plugs

The electricity in Canada is 110 volts, the same as in the United States. The frequency of electrical current in Canada is 60 Hz.

If you have electrical appliances that will require an adapter, please bring an adapter with you, as none will be provided.

Registration Desk Hours

The Registration Desk is located in the Foyer of the Victoria Conference Centre and is open during the following hours:

Sunday, September 23	15:00 – 19:00
Monday, September 24	07:30 – 18:30
Tuesday, September 25	07:30 – 17:30
Wednesday, September 26	08:00 – 16:30
Thursday, September 27	08:00 – 14:30



Sponsors & Exhibitors



Conference Host

OSGeo

Booths 16, 17, 18 & 19

OSGeo is the Open Source Geospatial Foundation - an independent international not-for-profit organization promoting the collaborative development of open source technologies and data. We are proud to bring you FOSS4G 2007 as our main annual event. Please visit our booth, introduce yourself and meet your OSGeo colleagues.

Website: www.osgeo.org

Platinum

Autodesk

Booths 31 & 32

Autodesk, Inc. is the world leader in 2D and 3D design software. Autodesk Geospatial Solutions provide an open platform for creating, managing and sharing spatial data across an organization. In 2005, Autodesk released its MapGuide Open Source and FDO data access technology to the open source development community, OSGeo. For more information about Autodesk Geospatial, visit <http://www.autodesk.com/geospatial>.

Website: www.usa.autodesk.com

Gold

DM Solutions Group Inc.

Booths #21 & 22

DM Solutions Group Inc. (DMSG) is a leading provider of web mapping technologies and solutions. As a key corporate contributor to MapServer and MapGuide, DMSG leverages the best of open source technologies as the foundation for support services, valued added technologies, custom solution delivery, and software and application development services.

Website www.dmsolutions.ca

GeoConnections

A Canadian federal government initiative, GeoConnections helps decision-makers use online location-based (or "geospatial") information, such as maps and satellite images, to tackle some of Canada's most pressing challenges. The program focuses on working with partners in public health, public safety and security, the environment and sustainable development, Aboriginal matters, and geomatics technology development.

Website: www.geoconnections.org

Google

Booths #13 & 14

Google is a proud user and supporter of open source software and development methodologies. As a company, Google contributes back to the Open Source community in a variety of ways, including source code, Project Hosting on Google Code, and Google Summer of Code. For more information on Google's open source activities, visit code.google.com/oss.html

Website: www.google.com

Integrated Land Management Bureau Booths #8 & 9

The Integrated Land Management Bureau (ILMB) was established in 2005 to provide improved access to Crown natural resources and government-held natural resource information within the Province of British Columbia. ILMB provides a range of services to the public, businesses, and government including managing and delivering natural resource sector information.

Website: ilmbwww.gov.bc.ca

Leica Geosystems Geospatial Imaging

Booths #26 & 27

Leica Geosystems Geospatial Imaging is streamlining workflows, enabling users to work more efficiently and accurately. Offering industry-leading photogrammetric mapping and remote sensing software, it facilitates the efficient capture of data, accurate referencing of imagery, easy measurement and analysis, and versatile presentation of spatial information.

Website: www.leica-geosystems.com

Refractions Research

Booths #11 & 12

Refractions Research is a consulting and development corporation with deep experience in open source systems. We design and build systems for spatial data management, including databases, servers, and user-interfaces. Our innovative open source products include the PostGIS spatial database, and the uDig internet-enabled desktop application framework.

Website: www.refractions.net

Safe Software Inc.

Booths #23 & 24

Established in 1993, Safe Software is the maker of FME, a powerful spatial ETL (Extract, Transform and Load) platform that enables organizations to seamlessly extract, translate, transform, integrate and distribute spatial data. FME is used in over 116 countries by all levels of government, the utilities sector, and resource industries.

Website: www.safe.com

Sponsors & Exhibitors



Silver

City of Nanaimo

Booth #10

Experience Nanaimo, the Harbour City! This amazing vacation destination is also a business hub, offering a great lifestyle and everything you need to grow your business. From financial services, through to training at Malaspina University-College, and 15-minute proximity to downtown Vancouver by floatplane, Nanaimo will exceed your expectations.

Website: www.nanaimo.ca

ESRI

Booth #3

With annual sales of more than \$660 million, ESRI remains the world leader in the geographic information system (GIS) software industry. Our business involves the development and support of GIS software for all types of organizations - from the one-person office to multinational corporations to innovative Internet GIS solutions.

Website: www.esri.com

Open Geospatial Consortium, Inc.

Booth #25

The Open Geospatial Consortium, Inc.® (OGC) is a non-profit, international, voluntary consensus standards organization that is leading the development of standards for geospatial and location based services. It has more than 350 members including software vendors, service and data providers, universities, and governmental agencies from federal to local levels.

Website: www.opengeospatial.org

Orkney, Inc.

Booth #5

Orkney, Inc. is an open source business solution provider located in Yokohama, Japan, specializing in GIS and LBS technologies. We provide consulting for Japanese companies in integration of open source GIS solutions and develop customized applications for our customers. Orkney is developer and maintainer of PostLBS, that includes routing and address search functionalities - pgRouting and pgGeocoder.

Website: www.orkney.co.jp

Sierra Systems Group Inc.

Booth #4

Since 1966, Sierra Systems has been integrating business and technology to help our private and public sector clients achieve measurable improvements in strategic and operational performance. In solutions delivery, management consulting, and managed services, we have earned a reputation for delivering superior solutions that strengthen the business operations of North American organizations.

Website: www.sierrasystems.com

Exhibitors

Camptocamp SA and Talend

Booth #30

Camptocamp, FOSS4G 2006 co-organizer, is an open-source software editor and integrator specialized in Geoinformatics and Enterprise solutions (TinyERP and Talend partner).

Talend offers open, innovative and powerful data integration solutions, used primarily for integration between operational systems, ETL, and migration.

Website: www.camptocamp.com

Canadian Forest Service/NRCAN

Booth #7

Canada's National Forest Information System (NFIS Canada) provides authoritative information about the state of Canada's forests and how it is being sustainably managed. NFIS Canada provides users with Web-based access to authoritative distributed information from provincial, territorial and other government agencies and NGOs.

Website: www.cfs.nrcan.gc.ca

The Open Planning Project

Booth #29

The Open Planning Project is a hybrid non-profit building technology to enhance the role of the citizen in democratic society. TOPP leads development of GeoServer, and contributes extensively to OpenLayers and GeoTools. TOPP offers support contracts on the software we build, with all profit reinvested to make better tools.

Website: www.openplans.org

Timberline Natural Resource Group

Booth #6

Timberline Natural Resource Group has been collecting, visualising and analysing geospatial data for 25 years. Our company-wide GIS knowledge base is second to none, covering areas of expertise from hard geospatial analysis to solutions architecture to web development in an increasingly open source context.

Website: www.timberline.ca

Directions

Display located outside Exhibit Hall

Directions Magazine is a member of the Directions Media publishing group. The magazine was first published in 1998 and remains the premier news and resource guide for geospatial professionals. Directions Magazine publishes weekly newsletters about geographic information systems, global positioning systems, and more.

Website: www.directionsmedia.net

GIS Development

Display located outside Exhibit Hall

As a Geospatial Communication Network, GIS Development promotes and propagates the usage of geospatial technologies in various areas of development worldwide. Through its activities - Magazines, Portal, Conferences and Exhibitions and Training Programmes, it facilitates knowledge transfer to strengthen productivity and management capabilities.

Website: www.gisdevelopment.net

Google is proud to sponsor FOSS4G 2007.

Google[™]
code.google.com

© Copyright 2007. All rights reserved. Google and the Google logo are registered trademarks of Google Inc.



Integrated Land Management Bureau
Ministry of Agriculture and Lands

ILMB
is a client focused organization
providing the following services to
the public, business and government:

- ◆ Managing and providing land and resource information
- ◆ Coordinating access to tenures, permits, licenses, Crown land sales and grants
- ◆ Prioritizing and coordinating recovery planning for species-at-risk
- ◆ Developing and facilitating the implementation of strategic Crown land-use plans

Access these services at
ilmbwww.gov.bc.ca and www.nric.ca

Monday, September 24

Registration Desk Open
Early Registration available Sunday 15:00-19:00

	OAK BAY	SAANICH	ESQUIMALT	SIDNEY	COLWOOD	VIEW ROYAL
07:30						
Room						
09:00 to 12:00	[W06] On-the-Fly Spatial Analysis with PostGIS and Google Earth Brian Timoney The Timoney Group	[W04] Introduction to PostGIS Paul Ramsey Refractions Research	[W05] Mapserver OGC Web Services Workshop Tom Kralidis Environment Canada Daniel Morissette MapGears	[W01] GIS for Web Developers Scott Davis AboutGroovy.com	[W02] Shuffling Quantum GIS into the Open Source GIS Stack Gary Sherman OGIS.org	[W03] Mapbender, Orchestrating the Geodata Concert Arnulf Cristl WhereGroup GmbH
12:00 to 13:00	Lunch Provided					
13:00 to 16:00	[W09] Getting Started with Mapserver Jeff McKenna DM Solutions Group Tyler Mitchell OSGeo Perry Nacionales University of Minnesota	[W07] Introduction to Geospatial Collaboration using Geoserver Chris Holmes The Open Planning Project	[W10] A Practical Introduction to ka-Map Paul Spencer DM Solutions Group	[W12] Web-based Routing: An Introduction to pgRouting with OpenLayers Daniel Kastl Orkney Inc Sylvain Pasche Claude Philipona Camptocamp SA	[W11] GRASS GIS and RDBMS Paolo Zatelli Marco Ciolli Clara Tattoni	[W08] Developing MapGuide Applications with PHP Bob Bray Autodesk
16:00 to 16:30	Break					
16:30 to 18:00	OSGeo Annual General Meeting Conference Centre Lecture Hall					
18:00 to 22:00	Welcome Reception at The Clubhouse, The Sticky Wicket 919 Douglas Street					

Monday, September 24, 2007

WEB MAPPING SOLUTIONS

the fix
CUSTOM SOLUTIONS

the goods
DATA PRODUCTS

the source
WEB MAPPING TECHNOLOGY

the edge
STRATEGIC PARTNERSHIPS

dmsolutions.ca

 DM Solutions Group

GIS—Better Decisions through Modeling and Mapping Our World

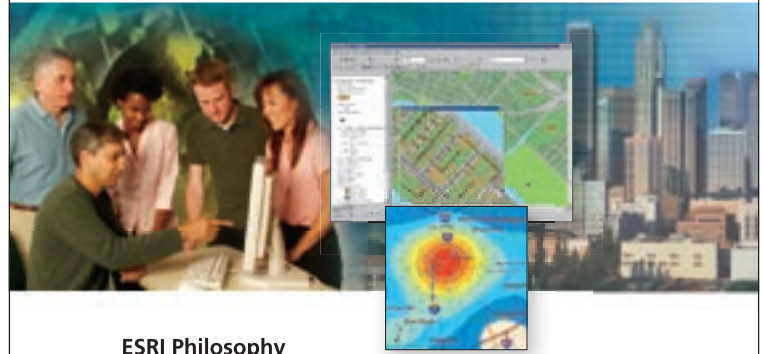

ESRI Philosophy

ESRI believes that better information makes for better decisions. Our reputation is built on contributing our technical knowledge, our special people, and our valuable experience to the collection, analysis, and communication of geographic information. Founded in 1969, ESRI is the leading developer of GIS software with more than 300,000 clients worldwide.

Contact us today to learn how ESRI's GIS is helping to manage and improve business operations around the world.



1-800-447-9778

info@esri.com • www.esri.com

Copyright © 2005 ESRI. All rights reserved. The ESRI globe logo, ESRI, ArcGIS, www.esri.com, and @esri.com are trademarks, registered trademarks, or service marks of ESRI in the United States, the European Community, or certain other jurisdictions. Other companies and products mentioned herein are trademarks or registered trademarks of their respective trademark owners.



"IT'S AMAZING WHAT YOU CAN DO HERE"

Welcome to all FOSS4G Conference delegates!

Be sure to include **Nanaimo**, the harbour city as a part of your Vancouver Island visit! From world-class outdoor adventure to a vibrant arts and culture scene, Nanaimo offers amazing vacation opportunities for you to enjoy!

For more information
or to order a Visitors Guide, call

1 800 663 7337 or visit
www.tourismnanaimo.com

NANAIMO
THE HARBOUR CITY

Enterprising Geospatial Solutions

Leica Geosystems Geospatial Imaging offers a range of workflow solutions for geospatial image exploitation, visualization and data management. With ISO compliance and interoperable OGC web services, Leica Geosystems' solutions enable users to work within a comprehensive image management system across the enterprise.

Those who use Leica Geosystems products every day trust them for their precision, seamless integration, interoperability and superior customer support. Geospatial solutions from Leica Geosystems - **when it has to be right.**

For more information on using geospatial information across your enterprise, Call us at **+1 877 463 7327** or send an e-mail to info@gi.leica-geosystems.com

- when it has to be **right**



Visit us in booth #26-27!



This ADS40 image of the Miura Peninsula area of Japan was captured by PASCO in 2001. Copyright © 2007 Leica Geosystems. All rights reserved.

THE GEOSPATIAL EXPERTS

Refractions Research is a consulting and development corporation with deep experience in open source systems. We design and build systems for spatial data management, including databases, servers, and user-interfaces. Our innovative open source products include the PostGIS spatial database, and the uDig internet-enabled desktop application framework.

PostGIS

Geographic Objects for PostgreSQL

uDig

User-friendly Desktop Internet GIS

Suite 300 – 1207 Douglas Street
Victoria, BC, Canada V8W 2E7

Phone: 250.383.3022
info@refractions.net



visit us at www.refractions.net

Refreshment Break in Exhibition Hall

	COLWOOD	ESQUIMALT	LECTURE THEATRE	SAANICH	OAK BAY 1	OAK BAY 2	VIEW ROYAL
14:30 to 15:00							
15:00 to 16:30	[L10] Defining and Using Custom Cartographic Symbols in MapGuide Robert Bray Autodesk	[L02] Practical Introduction to MapBuilder Mike Adair DM Solutions Group	Quantum GIS - Five Years and Counting Gary Sherman Micro Resources	Pleiades: Building a RESTful, Open Source GIS for the Humanities Sean Gillies Ancient World Mapping Center, University of North Carolina at Chapel Hill	Towards a Public Geodata Repository Schuyler Erle OSGeo Public Geodata Committee	FOSS4G Software in University Geomatics Education: A Case Study Integrating Teaching and Research Scott Mitchell Carleton University	Processing and Dissemination of Satellite Remote Sensing Data in an Heterogeneous Environment Paul Hasenohr European Commission - Joint Research Centre
15:00 to 16:30		A Year in the Life of OpenStreetMap: How OSM is Mapping the World Nick Black OpenStreetMap	FeatureServer: A REST-based Server for Simple Features Christopher Schmidt MetaCarta	Making Use of Open Source Geo-spatial Software for Supporting Community Based Projects Scott Emmons University of Northern British Columbia Alim Karim GeoBorealis	Building OSGEO HigherEd Content: Reflecting on an Online Introduction to GIS Course Using OGIS Charles Schweik University of Massachusetts, Amherst	Grid-enabled OGC Environment for EO Data and Services in Support of Canada's Forest Applications Hao Chen Pacific Forestry Centre, Canadian Forest Service, Natural Resources Canada David Goodenough Pacific Forestry Centre, Canadian Forest Service, Natural Resources Canada	
16:30 to 16:45			GDAL/OGR Project Status Report Frank Warmertdam OSGeo Mateusz Loskot OSGeo	Using the Atom Publishing Protocol for Web GIS Charlie Savage MapBuzz, Inc.	Free and Open Geospatial Content: Intellectual Property Rights and Cost Geoff Zeiss Autodesk, Inc.	Design and Implementation of Internet-based "Public Participation GIS" Using a User-centred Process and the Open Source Model Martin Bunch Faculty of Environmental Studies, York University Mike MacLennan Malone, Given and Parsons Ltd.	Grid Enabling the Satellite Image Data Service (SIDS) at MIMAS using Open Geospatial Consortium Web Services (OWS) and GRASS Gail Millin The Satellite Image Data Service - MIMAS
16:45 to 19:00							

Break in Exhibition Hall

Birds-of-a-Feather Sessions

Wednesday, September 26 — 08:00-10:30

Registration Desk Open							
	COLWOOD	ESQUIMALT	LECTURE THEATRE	SAANICH	OAK BAY 1	OAK BAY 2	VIEW ROYAL
08:00			<p>WMS Performance: Mapserver vs. Geoserver Brock Anderson Refractions Research</p> <p>The Open Planning Project Justin Deoliveira</p>	<p>Web-based Vehicular Tracking System Alejandro Chumaceiro Soluciones Integrales GIS SIGIS</p>	<p>A Generic Approach to Manage Metadata Standards Julien Barde Monterey Bay Aquarium Research Institute</p>	<p>OpenOceanMap - Deploying Cross-platform Geospatial Desktop Applications for Decision Support Utilizing Python, QGIS and QT Aaron Racicot EcoTrust</p>	<p>Rock and a Hard Place Will Cadell Timberline Natural Resource Group</p>
08:30 to 10:00	<p>[L03] Datums, Coordinate Systems, Map Projections & Datum Transformations Dean Mikkelsen Terra ETL</p> <p>Frank Warmerdam PROJ4</p>	<p>[L1] Protecting OGC Web Services with the 52° North Security System Jan Drewnak 52° North</p>	<p>Database Shootout: PostGIS and MySQL Wim de Haas Ministry of Transport, The Netherlands</p> <p>Wilko Quak Technical University Delft, The Netherlands</p>	<p>gvSIG Goes Mobile. gvSIG Porting for Mobile Devices Miguel Montesinos PRODEVELOP</p> <p>Javier Carrasco PRODEVELOP</p>	<p>From Mapping to Metadata, From Simple to Enterprise Portals? - A One Stop Solution using Portlet Technology Hans Plum lat/lon GmbH</p>	<p>TinyOWS an OGC WMS and WFS-T High Performance Server Olivier Courtin Campiocamp France SAS</p> <p>David Jonglez Campiocamp France SAS</p>	<p>Exploring the Synergies between Commercial and Open Source Software Gregg Petrie Cosmic Project</p> <p>Lee Miller Pacific Northwest National Laboratory</p>
10:00 to 10:30			<p>Tiling Maps for the Web with TileCache Schuyler Erle Troublemaker at Large</p>	<p>Mobile Opportunities for the Open Source Community Ravi Belwal Nokia</p>	<p>Spatial Data Search: A View from the Space Station Jo Walsh OSGeo</p>	<p>GOMS Project: Towards Web Services Dedicated to Thematic Mapping Olivier Ertz ICT / geo.SYSIN</p> <p>Abson Sae-Tang ICT / geo.SYSIN</p>	<p>Constructing an Open Source Powerhouse: Minnesota 3D (Dynamic Mapping, Reporting, and Interface) Jessica Fendos Minnesota Department of Employment and Economic Development</p> <p>Jeff Matson University of Minnesota</p>

Refreshment Break in Exhibition Hall

	GOLWOOD	ESQUIMALT	LECTURE THEATRE	SAANICH	OAK BAY 1	OAK BAY 2	VIEW ROYAL
10:30 to 12:00	<p>[L04] Rapid Visualization with the Virtual Terrain Project Software</p> <p>Ben Discoe Virtual Terrain Project</p>	<p>[L12] Introduction into OGC's Sensor Web Enablement</p> <p>Ingo Simonis 52° North</p>	<p>PostGIS Spatial Database: Introduction and Case Studies</p> <p>Paul Ramsey Refractions Research</p>	<p>uDig Case Studies</p> <p>Jesse Eichar Refractions Research</p>	<p>Bringing the Web Processing Service to a new stage — new 52°North WPS Features</p> <p>Bastian Schaeffer Institute for Geoinformatics, University of Muenster, Germany</p> <p>Theodor Foerster ITC, Enschede, The Netherlands</p>	<p>Development and Implementation of Cut and Fill Problem in GRASS With 3D Representation</p> <p>Sudarshan Badareddi International Institute of Information Technology, Hyderabad</p> <p>K S Rajan International Institute of Information Technology, Hyderabad</p>	<p>Species Distribution Modelling Using An Open Source Geospatial Software Stack</p> <p>Allan Hollander Information Center For The Environment, University of California, Davis</p>
			<p>Tips for the PostGIS Power User</p> <p>Kevin Neufeld Refractions Research</p>	<p>JGrass and Udig, Chronicles of a Lovestory</p> <p>Andrea Antonello HydroGIS / University of Trento / University of Urbino</p> <p>Silvia Francheschi HydroGIS</p>	<p>Integrating Open Source Applications to manage spatio-temporal Data in the Field of Environmental Sciences on a National Scale.</p> <p>Ulrich Leopold Public Research Centre Henri Tudor, Esch-sur-Alzette, Luxembourg</p>	<p>The use of QGIS and Grass to deliver GIS applications to a wider audience.</p> <p>Ken Sanderson Mistakis Institute</p>	<p>Lifemapper: Using and Creating Geospatial Data and Open Source Tools for the Biological Community</p> <p>Aimee Stewart University of Kansas</p> <p>C. J. Grady University of Kansas</p>
			<p>An integrated client for Web Processing Services - Upgrading uDig with Processing power</p> <p>Bastian Schaeffer Institute for Geoinformatics, University of Muenster, Germany</p> <p>Rob Lemmen ITC, Enschede, The Netherlands</p>	<p>Development of Geoprocessing Service with Realtime Data Using WPS and SOS Open Standard</p> <p>Sarawat Ninsawat Osaka City University</p> <p>Venkatesh Raghavan Osaka City University</p>	<p>Development of Geoprocessing Service with Realtime Data Using WPS and SOS Open Standard</p> <p>Sarawat Ninsawat Osaka City University</p> <p>Venkatesh Raghavan Osaka City University</p>	<p>SEXTANTE: a gvSIG-based platform for geographical analysis</p> <p>Victor Olaya Universidad de Extremadura</p>	<p>Yukon Planning Atlas - Decision Support tools for regional land use planning</p> <p>Jeff Hamm Yukon Land Use Planning Council</p>
			<p>Shortest Path Search in Real Road Networks with pgRouting</p> <p>Anton Patrushev Orkney, Inc.</p>				

Wednesday, September 26 — 12:00-15:00

Lunch Provided in Exhibition Hall / Poster Session in Registration Area							
	COLWOOD	ESQUIMALT	LECTURE THEATRE	SAANICH	OAK BAY 1	OAK BAY 2	VIEW ROYAL
12:00 to 13:00			<p>GeoServer, Past, Present and Future</p> <p>Andrea Alme The Open Planning Project</p>	<p>World Digital Library: Designing a Multi-lingual Geographic Search Interface</p> <p>Alex Quinn U.S. Library of Congress</p>	<p>Grass goes Web Once More...</p> <p>Lorenzo Becchi ominiverdi.org</p> <p>Luca Casagrande ominiverdi.org</p>	<p>Spatial Object Models Using PostGIS, Hibernate, and the JTS Topology Suite</p> <p>Chris Hodgson Refractons Research</p>	<p>How Robust is your Spatial Query? A Formal Taxonomy to Express Spatial Intersections</p> <p>Yao Cui Government of British Columbia</p> <p>Michael Ross Government of British Columbia</p>
13:00 to 14:30	<p>[L05] Introduction to FDO and the FDO API</p> <p>Greg Boone Autodesk</p>	<p>[L13] How to Cope with GeoSpatial – The Pragmatic Intro for the Java Developers</p> <p>Jody Garnett Refractons Research</p>	<p>GeoServer and the GeoWeb: KML, GeorSS, TileCaching and SuperOverlays</p> <p>Justin Deoliveira The Open Planning Project</p>	<p>Breaking All the Rules: Extreme Distributed Asynchronous Geospatial Databases with Sony and PostgreSQL/PostGIS</p> <p>Tim Bowden Mapforge Geospatial</p>	<p>A Full Web 3D GIS, Using PostGIS and X3D Output</p> <p>Olivier Courtin Campocamp France SAS</p> <p>David Jonglez Campocamp France SAS</p>	<p>Building Geospatial Business Intelligence Solutions with Free and Open Source Components</p> <p>Thierry Badard Centre for Research in Geomatics (CRG), Quebec City, Quebec, Canada</p> <p>Étienne Dubé Centre for Research in Geomatics (CRG), Quebec City, Quebec, Canada</p>	<p>A Model-Driven Web Feature Service for Full Semantic Interoperability</p> <p>Peter Staub ETH Zurich, GIS Group</p>
14:30 to 15:00			<p>Secrets of the JTS Topology Suite</p> <p>Martin Davis Refractons Research</p>	<p>Georeferencing Historical Maps over the Internet</p> <p>Jan Hartmann University of Amsterdam</p>	<p>Putting the Pieces together: Combining Different Open Source Components toward Developing a Powerful, Open Source WebGIS Application Framework</p> <p>Shriram Ilavajhala University of Maryland</p> <p>Diane Davies University of Maryland</p>	<p>Transitioning Low Earth Orbit Satellite Archive Data from Informix (Geodetic DataBlade) to PostgreSQL (PostGIS)</p> <p>Chungwei Chu NASA/SSAI</p>	<p>Spatial ETL Powered by Talend: Towards an Open Source Spatial ETL</p> <p>Claude Philipona Campocamp SA</p> <p>Eric Lemoine Campocamp France SAS</p>

Refreshment Break in Exhibition Hall

Wednesday, September 26 — 15:00-22:00

	GOLWOOD	ESQUIMALT	LECTURE THEATRE	SAANICH	OAK BAY 1	OAK BAY 2	VIEW ROYAL
15:00 to 16:30	[L14] Leveraging PostgreSQL and Linux with ESRI's ArcGIS system Derek Law ESRI	[L06] Practical Introduction to MapStorer Benjamin Thelen WhereGroup GmbH Arnulf Cristl WhereGroup GmbH	Cartoweb4, a easy to use and extensible web GIS application built on top of OpenLayers. Pierre Giraud Campiocamp France SAS Sylvain Pasche Campiocamp SA	OpenLayers - Agile Geography in a Browser Tim Schaub The Open Planning Project	IBM DB2 Express-C: A Free Database for Open Source Spatial and XML Development David Adler IBM Corporation	GRADGRID4: an advanced spatial interpolation tool combining GRASS and R functions Martin Mergili Institute of Geography, University of Innsbruck, Austria	Using Open Source to analyze Canada's National Forest Inventory Chris West Canadian Forest Service, Natural Resources Canada Brian Low Canadian Forest Service, Natural Resources Canada
16:30 to 16:45			Fusion: Advanced Application Development Toolkit for Web Mapping Paul Spencer DM Solutions Group Jason Fournier DM Solutions Group	Raster Input for MapServer Frank Warmertam OSGeo	A New Geospatial Enterprise Platform Built on Open Standards and Open Source Brad Skelton Leica Geosystems Mladen Stojic Leica Geosystems	RiskBox: Natural Hazards and Risks Analysis within the GIS GRASS Massimiliano Cannata IST - SUPSI	Next generation of raster support for the GeoTools-GeoServer stack. Simone Giannacchini GeoSolutions S.A.S. Alessio Fabiani GeoSolutions
16:45 to 17:45			Open Mapping: Integrating Open Source Geospatial Software and Public Domain Data Larry White neomatix.ca & openflows.com	Developing Web 2.0 Applications Using FDO and Open Source RDBMS Data Providers Haris Kurtagic SL-King	ILWIS and 52°North: From closed source to open source and interoperable image services Rob Lemmens ITC, Enschede, The Netherlands Martin Schouwenburg ITC, Enschede, The Netherlands	Analyzing Building Damages of a Major Earthquake Using GRASS and R Wen-Chieh (Jeffrey) Wang Chaoyang University of Technology	High-Performance Image Processing and Cartography using the NASA Vision Workbench Matthew Hancher NASA Ames Research Center
17:45 to 22:00							

Break in Exhibition Hall

Birds-of-a-Feather Sessions

17:45 - 18:00 Seating open for IMAX Presentation, IMAX Theatre at Royal BC Museum

18:00 - 19:00 IMAX Presentation of "Titanica"

19:00 - 22:00 Dinner Reception, 3rd floor of Royal BC Museum

Wednesday, September 26, 2007 - Afternoon Sessions

Registration Desk Open							
	COLWOOD	ESQUIMALT	LECTURE THEATRE	SAANICH	OAK BAY 1	OAK BAY 2	VIEW ROYAL
08:00			Free Software Business Arnulf Christl WhereGroup GmbH & Co. KG	Adding Analytic Muscle to Spinning Globes: Bulking Up Google Earth and Virtual Earth With PostGIS Brian Timoney The Timoney Group	Spatial Data Infrastructure (SDI)-In-A-Box: a Footprint to Deliver Geospatial Data through Open Source Applications Aaron Peeke-Vout Canadian Forest Service - Natural Resources Canada Brian Low Canadian Forest Service - Natural Resources Canada	Ship Tracking with MapServer for Fun and Profit Hal Mueller Mobile Geographics	Managing WMS and WCS Multidimensional NetCDF Datasets with Geoserver Mickael Treguer IFREMER Martin Desruisseaux Geomatys
08:30 to 10:00	[L15] FME as a Two-Way Bridge between Proprietary Systems and Open Source Databases Dale Lutz Safe Software Robyn Rennie Safe Software Dean Hintz Safe Software	[L07] CartoWeb for Beginners Isabelle Kiener Campocamp SA Claude Philipona Campocamp SA	The Gift Economy Ain't Free: Getting Help with Open Source Software Howard Butler Hobu, Inc Chris Schmidt MetaCarta	Painless Feature Markup in KML Chris Ingrassia FortiusOne	Heavy Traffic: How The BC Integrated Land Management Bureau Used Open Source to Deploy Government-Strength GeoWeb Services Michael Ross BC Integrated Land Management Bureau	Minerva: Integrating GIS, 3D, and Virtual Reality Adam Kubach Arizona State University	TMap : A SVG Generator for Animated Maps Laurent Pierre Electricité De France R&D
10:00 to 10:30			How to Blow Away \$AU3.5m (\$US2.97m) with GeoFOSS in Eight Weeks and Still Make Friends Tim Bowden Mapforge Geospatial	gvSIG: towards 4D GIS Salvador Bayarri IVER	Operational, Timely Fire Data on an Open Source Stack Angus Carr Saskatchewan Environment	GeoMOOSE - A Client Framework Focusing on Local Government Collaboration Brian Fischer Houston Engineering, Inc.	3D City Models for Bonn, Berlin and Hamburg based on Open Source Software and Open Standards Hans Plum lat/ion GmbH
Refreshment Break in Exhibition Hall							
			OSGeo: A Community of Communities Tyler Mitchell OSGeo	Google Earth Powered by MapGuide Robert Bray Autodesk, Inc.	TerraLib: an Open Source GIS Library to Build Customizable Geographical Applications on Spatio-temporal Databases Lúbia Vinhas National Institute for Space Research (INPE) António Miguel Vieira Monteiro National Institute for Space Research (INPE)	Feature Caching in GeoTools and uDig Christophe Rousson Centre for Research in Geomatics, Université Laval, Quebec QC	Automatic Generation of Web-Based GIS/Database Applications Toshimi Minoura Oregon State University Junya Sano Fuji IT Center
10:30-12:00	[L16] Deegree GeoSecurity – Access Control for OGC Web Services Hans Plum lat/ion GmbH	[L08] An Introduction to the uDig Open Source Desktop Jody Garnett Refractions Research					

Thursday, September 27 — 10:30-15:00

10:30-12:00	<p>Best Business Practices for Implementing Open Source Web Mapping Technology</p> <p>Dave McIlhagga DM Solutions Group</p>	<p>User-Customized Environmental Mapping and Decision Support using NASA World Wind and DOE Genie Software</p> <p>Andrew Pilant US Environmental Protection Agency</p>	<p>The Amazon Deforestation Monitoring System: A Large Environmental Geographic Database Developed on TerraLib and PostgresSQL</p> <p>Vanildes Ribeiro FUNCATE</p> <p>Gilberto Ribeiro INPE</p>	<p>Coordinate System Transformations in Geotools and uDig - Contribution of Google Summer of Code 2006 and 2007</p> <p>Jan Jezek Czech Technical University in Prague</p>	<p>Automating Reports using PHP, PostgresSQL / PostGIS, FPDE, JGraph and MapServer</p> <p>David Bitner Metropolitan Airports Commission</p>
12:00 to 13:00	<p>Open Source GIS and Sustainable Development</p> <p>Gavin Fleming Mintek</p>	<p>ossimPlanet - A Collaborative Open Source Virtual Earth</p> <p>Mark Lucas RadiantBlue Technologies Inc</p>	<p>What's Going On Out There?: Using GeoServer for Analysis of Spatio-Temporal Environmental Data</p> <p>Tyler Erickson Michigan Tech Research Institute (MTRI)</p> <p>Pete Giencke The Great Lakes Commission</p>	<p>Geoserver and Open Standards: A Success Story</p> <p>Saul Farber Commonwealth of Massachusetts Executive Office of Energy and Environmental Affairs</p>	<p>OSGeo Sample Dataset for Research, Development and Education</p> <p>Helena Mitsova North Carolina State University, Raleigh, NC, USA</p> <p>Markus Neteler ITC-irst, Trento, Italy</p>

Lunch Provided in Exhibition Hall

Closing Plenary Session: Welcome from Chair (Salon C, Level 2)

FOSS4G 2008 Preview

Closing Panel Discussion

Moderator: Adena Schutzberg, Directions Magazine
 Peter Batty, Independent Consultant
 Tim Bowden, Director, Mapforge Geospatial
 Mark Sondheim, BC Integrated Land Management Bureau
 Frank Warmerdam, President, OSGeo

Sol Katz Award

Recognizing achievement in the field of open source geospatial software.
 Presented by: Frank Warmerdam, OSGeo President

FOSS4G 2007 in Review

Adena Schutzberg, Executive Editor, Directions Magazine gives her impressions of the conference and how open source will affect the larger geospatial industry in the year ahead.

15:00

End of Conference Program

Thursday, September 27, 2007

Orkney

Orkney, Inc. is an open source business solution provider located in Yokohama, Japan, specializing in GIS and **LBS technologies**. We provide consult for Japanese companies in integration of open source **GIS solutions** and develop customized applications for our customers.

Orkney is developer and maintainer of **PostLBS**, that provides core tools for Location Based Services as open source software based on **PostgreSQL** and **PostGIS**. PostLBS includes routing and address search functionalities - **pgRouting** and **pgGeocoder**, which are similar to those found in proprietary software.

6F JA-Kyosai Yokohama Building
1-2 Kaigandori, Naka, Yokohama
231-0002 JAPAN
Tel +81-45-228-3320
Fax +81-45-228-3321

www.orkney.co.jp



MapServer 2007

OGC[®]
Open Geospatial Consortium, Inc.



FOSS4G depends on open standards.

Get involved!

Open Geospatial Consortium, Inc.
35 Main St., Suite 5
Wayland, MA 01778
USA

Phone: + 508 655 5858

Fax: + 508 655 2237

<http://www.opengeospatial.org>

Sam Bacharach <sbacharach@opengeospatial.org>



Sierra Systems

Your Geospatial Experts

Vision – Moving Forward with People, Information and Technologies for Improved Awareness and Decision-Making.

Experience – Spatial Data Infrastructures, Enterprise Registries, Asset Management Systems, Geospatial Portals, and Standards Development.

Services – Strategic Planning, Project Management, Change Management, Business Analysis, Systems Analysis, Architecture, Development, Integration, and Business Process Transformation.

Visit us at Booth # 4



Victoria Photo Credits:

Cover Photo: Oak Bay Marina, Nick Redding, Tourism Victoria
Page 3: The Old and the New in Victoria, Brenda Gibson, Tourism Victoria
Page 7: Hatley Castle, Image Bank, Tourism Victoria
Page 8: Beacon Hill Park Stone Bridge, Jack Weeks, Tourism Victoria
Page 9: Early Sunrise at Elk Park, Jennifer Callioux, Tourism Victoria
Page 9: Blue Legislature, Tyler Ahlgren, Tourism Victoria
Page 10: Oak Bay Marina, Nick Redding, Tourism Victoria
Page 11: West Coast Beach Logs, Penny Rogers, Tourism Victoria
Page 27: Sailing off Victoria, Jeff Reynolds, Tourism Victoria
Page 32: Victoria Conference Centre, Image Bank, Tourism Victoria

Workshops

Monday, September 24



Morning Workshops: 09:00-12:00

W-01: GIS for Web Developers

Room: Sidney

Based on the book GIS for Web Developers, this talk demonstrates how you can build your own Google Maps in-house using nothing but open source software. We also discuss integrating free, public domain data from sources like the US Census Bureau and the USGS.

W-02: Shuffling Quantum GIS into the Open Source GIS Stack

Room: Colwood

Quantum GIS (QGIS) is a user friendly Open Source desktop application for working with a variety of spatial data. This workshop will introduce you to QGIS and look at not only its core features, but how it can interoperate with MapServer, GRASS, Web services, and PostGIS.

W-03: Mapbender, Orchestrating the Geodata Concert

Room: View Royal

This workshop gives an in-depth introduction to the software Mapbender, a managed, web based client framework. The focus of the workshop lies on how to build web mapping applications with distributed Spatial Data Infrastructure components and how to manage user access.

W-04: Introduction to PostGIS

Room: Saanich

A hands-on intro to the PostGIS spatial database extension for PostgreSQL, starting with an introduction to the PostgreSQL RDBMS, and moving through installation, data loading, performance tuning, spatial SQL, and integration with third-party applications such as Mapserver, Mapguide and uDig.

W-05: MapServer OGC Web Services Workshop

Room: Esquimalt

Interoperability is increasingly becoming a focus point for organizations that distribute and share data over the Internet. The Open Geospatial Consortium (OGC) focuses on the development of publicly available geospatial web standards. MapServer currently supports numerous OGC specifications, allowing users to publish their data services in an interoperable manner. This workshop will review the OGC specifications supported in MapServer as well as provide information on implementation options and issues, as well as what the future holds for OGC support in MapServer.

W-06: On-the-Fly Spatial Analysis With PostGIS and Google Earth

Room: Oak Bay

There's no debate that Google Earth "out of the box" is cool. But when integrated with PostGIS on a webserver, it becomes a powerful analysis tool with buffers, intersections, and distance calculations at the fingertips of the "general user". We'll show you how to make the magic happen using simple HTML forms and straightforward PHP scripts.

Afternoon Workshops: 13:00-16:00

W-07: Introduction to Geospatial Collaboration using GeoServer

Room: Saanich

GeoServer connects your information to the Geospatial Web for not just display but also shared editing. This introductory workshop will show you how. We will demonstrate installation and configuration with the web-based GUI, outputting 2d and 3d maps, and setting up a collaboration environment geared to your use case.

W-08: Developing MapGuide Applications with PHP

Room: View Royal

This workshop introduces participants to MapGuide programming fundamentals, provides an overview of the client and server side MapGuide APIs, highlights the usage of many core APIs, and walks participants through the process of creating an application that extends the basic viewer functionality.

W-09: Getting Started with MapServer

Room: Oak Bay

This hands-on workshop is intended as an introduction to Web mapping with the University of Minnesota MapServer. The participants will go through the process of setting up a MapServer environment which includes configuring a Web server and creating a MapServer application.

W-10: A Practical Introduction to Ka-Map

Room: Esquimalt

Ka-Map, a web mapping toolkit from DM Solutions, has lately arrived at its version 1.0 and the core stability, acquired since the beginning, has been integrated with some new demo interfaces. New features have been added and the integration with OpenLayers' map rendering API is in process to version 2.0. The workshop will start from basic ka-Map installation and configuration to some tests with advanced features.

W-11: GRASS GIS and RDBMS

Room: Colwood

Attendees will experience GRASS external DBMS support by connecting GRASS to the most commonly used FOSS DBMS (PostgreSQL/PostGIS, MySQL, SQLite).

W-12: Web-based Routing: An Introduction to pgRouting with OpenLayers

Room: Sidney

This workshop provides an insight into pgRouting, a routing extension to PostgreSQL that is part of the PostLBS project, maintained by Orkney. The workshop explains how to prepare the road network data for use with pgRouting and demonstrates how to build a simple application using pgRouting together with OpenLayers.

Labs



Tuesday, September 25, 2007

Time: 13:00 – 14:30

L-01: Raster Processing and Preparation with GDAL

Room: Colwood

A practical tutorial on processing and preparing raster data for visualization or further analysis.

L-09: Using the GeoNetwork open source Spatial Data Catalog

Room: Esquimalt

GeoNetwork is a standards based and decentralized spatial information management environment, designed to enable access to geo-referenced databases, cartographic products and related metadata from a variety of sources, enhancing the spatial information exchange and sharing between organizations and their audience, using the power of the Internet. This approach of geographic information management provides a wide community of spatial information users with easy and timely access to available spatial data and to existing thematic maps that support informed decision-making.

Time: 15:00 – 16:30

L-10: Defining and Using Custom Cartographic Symbols in MapGuide

Room: Colwood

Defining and Using Custom Cartographic Symbols in MapGuide introduces participants to the new XML formats for defining symbols in MapGuide. In the workshop participants will create a small symbol library and use the symbols for styling points, lines, polygons, and labels in MapGuide.

L-02: Practical Introduction to MapBuilder

Room: Esquimalt

MapBuilder is a powerful, standards compliant geographic mapping client which runs in a web browser. This workshop will explain how to work with MapBuilder to present maps and other information in your web pages. The first half will be a beginner level tutorial including a short introduction, and the second half will present more advanced concepts.

Wednesday, September 26, 2007

Time: 08:30 – 10:00

L-03: Datums, Coordinate Systems, Map Projections & Datum Transformations

Room: Colwood

This lab is for developers, users, geographers, and aims to answer many questions faced in our day-to-day use in Open Source Mapping and to importantly show that latitude and longitude are not absolute.

L-11: Protecting OGC Web Services with the 52°North Security System

Room: Esquimalt

This workshop demonstrates how to add authentication and authorization capabilities to spatial data infrastructures with the services of the 52°North security system. The participants will be guided to set up and configure the necessary access control services to protect an OGC Web Map Service and load it into an OGC WMS client.

Time: 10:30 – 12:00

L-04: Rapid Visualization with the Virtual Terrain Project Software

Room: Colwood

Learn to use the cross-platform open-source VTP software to turn your geospatial data into interactive real-world visualization. This step-by-step class will lead you through processing standard data formats and raw GIS files into visually realistic terrain, roads, buildings, water and trees, even dynamic elements such as vehicles.

L-12: Introduction into OGC's Sensor Web Enablement

Room: Esquimalt

OGC Sensor Web Enablement will reach version 1.0 in 2007. After six years of developing, the specifications are considered to be mature enough to be published as OGC specifications. 52°North is has a major thread dedicated to SWE services and encodings exclusively, covering all those services like SOS, SPS, SAS, and WNS.

Labs



Wednesday, September 26, 2007

Time: 13:00 – 14:30

L-05: Introduction to FDO and the FDO API

Room: Colwood

The Introduction to Feature Data Objects (FDO) workshop will present an overview of FDO and its Application Programming Interfaces (API). Using examples and tutorials it will introduce users to the concepts, organization and structure of FDO.

L-13: How to Cope with GeoSpatial – The Pragmatic Intro for Java Developers

Room: Esquimalt

Are you new to GeoSpatial? Are you not cool enough to be a Neo-Geographer AJAX empowered meta tagging Ruby wonder kid? Does scientific mumbo-jumbo make your head hurt? Are you (gasp!) just out to get the job done? Come to this workshop and go home happy.

Time: 15:00 – 16:30

L-14: Leveraging PostgreSQL and Linux with ESRI's ArcGIS system

Room: Colwood

Introduces GIS users & developers to ESRI's new support of PostgreSQL and Linux in the ArcGIS framework.

L-06: Practical Introduction to MapStorer

Room: Esquimalt

MapStorer is a database supported system for managing MapServer projects. MapStorer makes it possible to maintain MapServer mapping projects via an easy-to-use web frontend and re-use definitions of layers and classes across existing mapfiles. This workshop gives an introduction to setting up and using MapStorer.

Thursday, September 27, 2007

Time: 08:30 – 10:00

L-15: FME as a Two-Way Bridge between Proprietary Systems and Open Source Databases

Room: Colwood

This workshop demonstrates Safe Software's FME technology as a bridge between open source technology and proprietary GIS systems. FME allows open source databases, GDAL-supported formats and OGR formats to be used with proprietary GIS systems, adds value to FDO data providers, and extends the functionality of GEOS to many formats.

L-07: CartoWeb for Beginners

Room: Esquimalt

CartoWeb (www.cartoweb.org) is both a comprehensive and ready-to-use Web-GIS and a convenient framework for building customized applications. It is based on Mapserver.

Time: 10:30 – 12:00

L-16: Deegree iGeoSecurity – Access Control for OGC Web Services

Room: Colwood

The workshop will give an introduction into deegree iGeoSecurity, the security framework of the deegree project. The setup and configuration of secured services will be exercised using a practical example.

L-08: An Introduction to the uDig Open Source Desktop

Room: Esquimalt

Learn the basics of the uDig open source desktop application! Load data from multiple sources, reproject, edit, re-style, using data from the desktop, the web, and databases, all at once.



FOSS4G Demonstration Theatre



The demo theatre will provide an opportunity for projects to show off their latest developments in short presentations throughout the conference. Situated in **Sidney Room**, near the exhibition hall, the theatre is easy to drop in on for a quick dose of interesting tech talk.

TIME		TUESDAY, SEPTEMBER 25	WEDNESDAY, SEPTEMBER 26	THURSDAY, SEPTEMBER 27
COFFEE BREAK	10:00	Closed for Plenary	European Marine Environmental Risk Management System Peter Walker, PML	GeoNetwork Catalogue Service Jeroen Ticheler, UN FAO
	10:10		Quality in Time: Web-based Mobile Auditing Till Adams, terrestris	GeoPortal Josh Hevenor, DPRA Canada
	10:20		OpenStreetMap in 10 Minutes Nick Black, OpenStreetMap	Talend and OSS ETL Claude Philipona, Camptocamp
LUNCH BREAK	12:00	Mapguide Open Source Bob Bray, Autodesk	FME with Open Source Dean Hintz, Safe Software	Enterprise Image Management Brad Skelton, Leica Geosystems
	12:10		pgRouting Daniel Kastl, Orkney	uDig, User Friendly Desktop Internet GIS Jesse Eichar, Refractions Research
	12:20	DM Data Products Dean Gadoury, DM Solutions Group	JUMP Tools for Large Databases Kevin Neufield & Emily Gouge, Refractions Research	FME with Open Source Dale Lutz, Safe Software
	12:30	Municipal MapGuide OS Applications Jason Birch, City of Nanaimo	Geospatial Social Network for Data Sharing Brad Skelton, Leica Geosystems	Community Tree Mapping with MapGuide OS Amber Bieg
	12:40	FOSS does "Heavyweight" Government Apps Raj Singh, Open Geospatial Consortium	gvSIG Salvador Bayarri, IVER	Virtual Terrain Project Ben Discoe, vterrain.org
	12:50	JUMP Road Matcher Martin Davis, Refractions Research	KML Regionator James Macgill, Google	Playstation 3 Tile Cache Tim Bowden, Lisasoft
COFFEE BREAK	14:30	OSSIMPlanet Mark Lucas, OSSIM.org	Proj4Javascript Mike Adair, DM Solutions Group	Closed for Plenary
	14:40	Mapnik Artem Pavlenko, Mapnik.org	DIVERT Project Michel Ferreira	
	14:50	Creative Commons Licensing for OWS Bastian Schäffer, 52° North	CartoWeb 4 Pierre Giraud, Camptocamp	

Welcome to Victoria



Welcome to Victoria

Victoria has won numerous awards for its beauty and livability from magazines like Condé Nast Traveler. As a cultural capital and world-class tourist destination, Victoria has no shortage of attractions, outdoors and in. From a simple walk by the sea to great hiking in our parks and forests — the environment is breathtaking.

Visit one of the world's great museums, the Royal BC Museum, just a stone's throw from the VCC and attached to a state-of-the-art IMAX Theatre. Our century-old Legislative Buildings, brilliantly outlined in light each evening, stand at the harbour's edge. Craigdarroch Castle, built in the 1880s, features the best collection of residential stained and leaded glass on the West Coast. And the world-famous Butchart Gardens, with its spectacular 55 acres of floral display, is quite simply a 'must-see'.

Our precious environment affords us many gifts. Victoria and Vancouver Island are known as the place to see wildlife, whales and marine life in their natural surroundings. There are seals and shorebirds in the harbour and in the fall, a chance to see soaring eagles and one of nature's great spectacles, the salmon run at nearby Goldstream Park. Incredible eco-adventures are literally steps from the Victoria Conference Centre



Victoria and Area Tours

Whale Watching

Take to the seas with Prince of Whales whale watching tours. Their three-hour excursions will give you a close up view of local sea life — seals, sea lions, otters, birds, and of course... whales. See the resident Orcas of the southern Gulf of Georgia from Prince of Whales' zodiacs or their larger Ocean Magic vessels. Call 250-383-4884 to make a reservation and you must mention FOSS4G07 to receive the special conference rates listed below.

Zodiacs

\$80.00 + GST / Adult, 3 hours in duration

A fantastic fun-filled fresh-air experience! The zodiac-style boats are designed for high speed and quick turns. Feel the power of the Pacific Ocean first hand!

Ocean Magic

\$85.00 + GST / Adult, 3 hours in duration

World famous fast, quiet, and whale-friendly vessel — Prince of Whales' new big boats, the OCEAN MAGIC I & II, are 62-foot aluminium express cruisers capable of cruising at 30 knots an hour and seating 74 passengers. The boat functions as a floating classroom staffed by marine biologists who provide an educational narrative about the marine mammals you'll see along the way. Keep your camera handy!

Gray Line West Bus Tours

Present your name badge at the Gray Line West ticket kiosk (located in the Fairmont Empress Hotel) to receive a 10% discount on the tours listed below. Tours depart from in front of the Fairmont Empress Hotel on Government Street.

Grand City Drive Tour

\$25 + GST, 1.5 hours in duration

Tours depart 10am, 12pm and 2pm

This narrated tour shows you the famous landmarks of the city and explains the fascinating history behind them. Discover Victoria's lovely homes, gardens and points of historic interest onboard an authentic British DoubleDecker bus. Tour highlights include: historic antique row, Victoria's Inner Harbour, downtown core, scenic views of Mt. Baker & San Juan Islands, exclusive residential areas of Uplands and Oak Bay.

Butchart Gardens Tour

\$49.00 + GST, 3 hours in duration

Visit Butchart Gardens it is Victoria's most famous attraction by Gray Line West motor coach. Stroll along winding paths and 50 fragrant acres of blossoms, enchanting theme gardens, streams and lily ponds. At Butchart's see the Sunken Garden, Rose Garden and Japanese Garden.

FOSS4G 2008 - South Africa

FREE AND OPEN SOURCE SOFTWARE FOR GEOSPATIAL



CAPE TOWN
International Convention Centre

OPEN SOURCE GIS: AN OPTION FOR DEVELOPING NATIONS

29 SEPTEMBER - 3 OCTOBER, 2008

TOPICS:

- Sustainable Development
- Millennium Development Goals
- New FOSS GIS developments and applications
- GEO, GEOSS, and its 9 societal benefit areas
- NGOs, CBOs, community development
- Training, support, skills development?
- Technical Open Source workshops
- Land management and reform
- Open data, open content
- FOSS Business models
- OGC, interoperability
- LBS, logistics, routing
- Disaster management
- Participatory GIS
- Semantic GIS

TECHNICAL VISITS:

- Satellite ground station
- Botanical Gardens
- Navy Survey Ship
- GIS on a wine farm
- CapeTown MetroGIS
- Local municipalities

PUBLIC WELCOME DAY:

- Sports, recreation, tourism
- Planning for the 2010 Soccer World Cup

EDUCATION OUTREACH DAY:

Teach at local schools and 3 local universities.

HOSTED BY



Powerful. Affordable. Open.

Autodesk Geospatial helps organizations take control of their future.

Offering affordable and powerful geospatial solutions at every level of data creation, integration, and sharing, Autodesk combines the strength of its proprietary technologies with the innovation of open source projects such as MapGuide Open Source and FDO data access technology. The result: faster innovation of web mapping solutions, more frequent software releases, and lower cost of entry and ownership.

Autodesk is pleased to be a Platinum Sponsor of the Free and Open Source Software for Geospatial (FOSS4G) Conference. For more information about Autodesk Geospatial Solutions, as well as the MapGuide and FDO open source projects, visit us in booths 31 and 32 or online at www.autodesk.com/geospatial.

Autodesk, Inc., is a Sustaining Sponsor of the Open Source Geospatial Foundation.



Autodesk is a registered trademark of Autodesk, Inc., in the USA and/or other countries. OSGeo is a trademark of the Open Source Geospatial Foundation in the USA and/or other countries. All other brand names, product names, or trademarks belong to their respective holders. Autodesk reserves the right to alter product offerings and specifications at any time without notice, and is not responsible for typographical or graphical errors that may appear in this document. © 2007 Autodesk, Inc. All rights reserved.

Autodesk®



Victoria Conference Centre Floor Plans



The Victoria Conference Centre

Level One

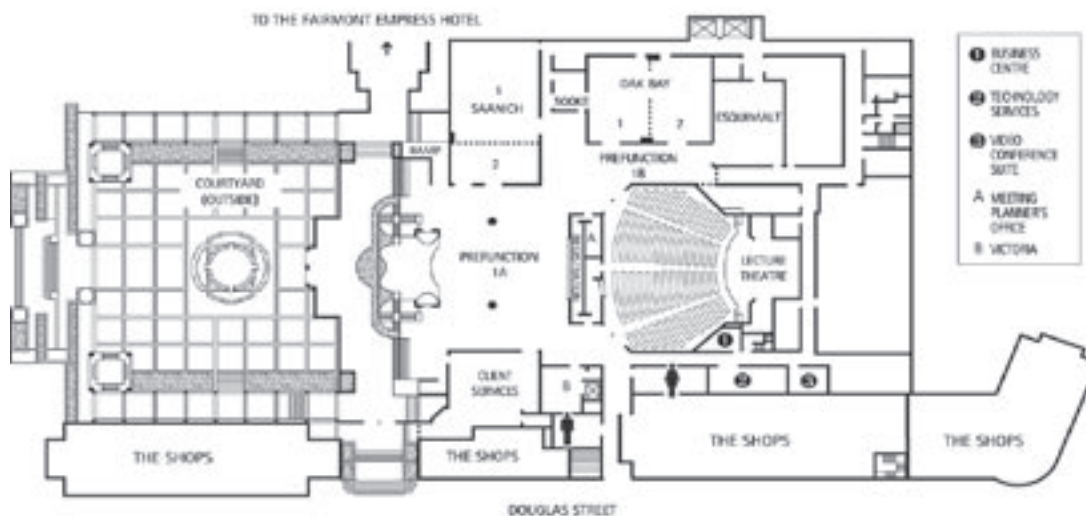

Level Two

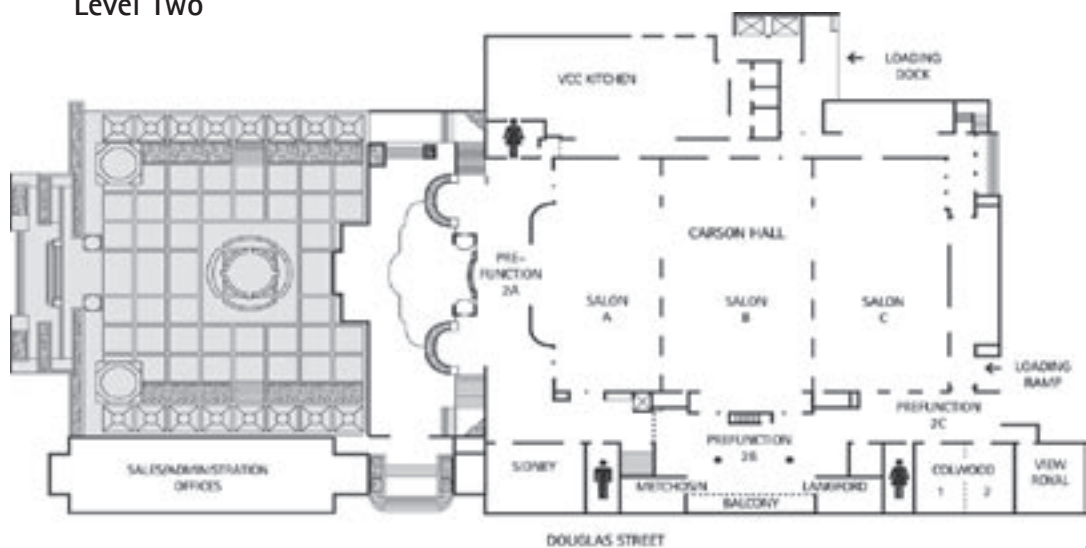

VICTORIA
CONFERENCE
CENTRE